

SEC 33 T20N R14E

SEC 33 T20N R14E

| OKLAHOMA DEPARTMENT OF TRANSPORTATION | | | | | |
|---------------------------------------|-------|---------------|-------------|-----------|--------------|
| FED. ROAD DIST. NO. | STATE | JOB PIECE NO. | FISCAL YEAR | SHEET NO. | TOTAL SHEETS |
| 6 | OKLA. | 21899(04) | | | |
| DESCRIPTION | | | REVISIONS | | |
| | | | DATE | | |

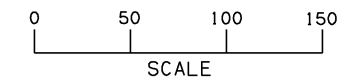

A001 SURVEY @ CURVE S-1
 PI= 747+36.87
 N= 430367.17
 E= 2609811.05
 Δ= 41°07'00" RT
 D= 1°00'00"
 T= 2148.85
 L= 4111.67
 R= 5729.58
 E= 389.71

I-44 C.R.L. CURVE C-1
 PI= 747+36.87
 N= 430367.17
 E= 2609811.05
 Δ= 41°07'00" RT
 D= 1°00'00"
 T= 2148.85
 L= 4111.67
 R= 5729.58
 E= 389.71
 e_{max}= 8.0%
 S= 3.6%
 V= 70 MPH

SEE SHEETS 55 - 56 FOR RAMP 'A' PLAN

REMOVE
 S10 75°29'23.54"
 41W13°31'11.24" RCB
 SD CL 0.00' LT (A001)
 E. Elev. = 6865.00 N. = 6883.33 S.
 REMOVE
 S16 56°54'57"
 41W13°31'11.24" RCB
 SD CL 0.00' LT (A003)
 E. Elev. = 6886.89 N. = 6897.7 S.

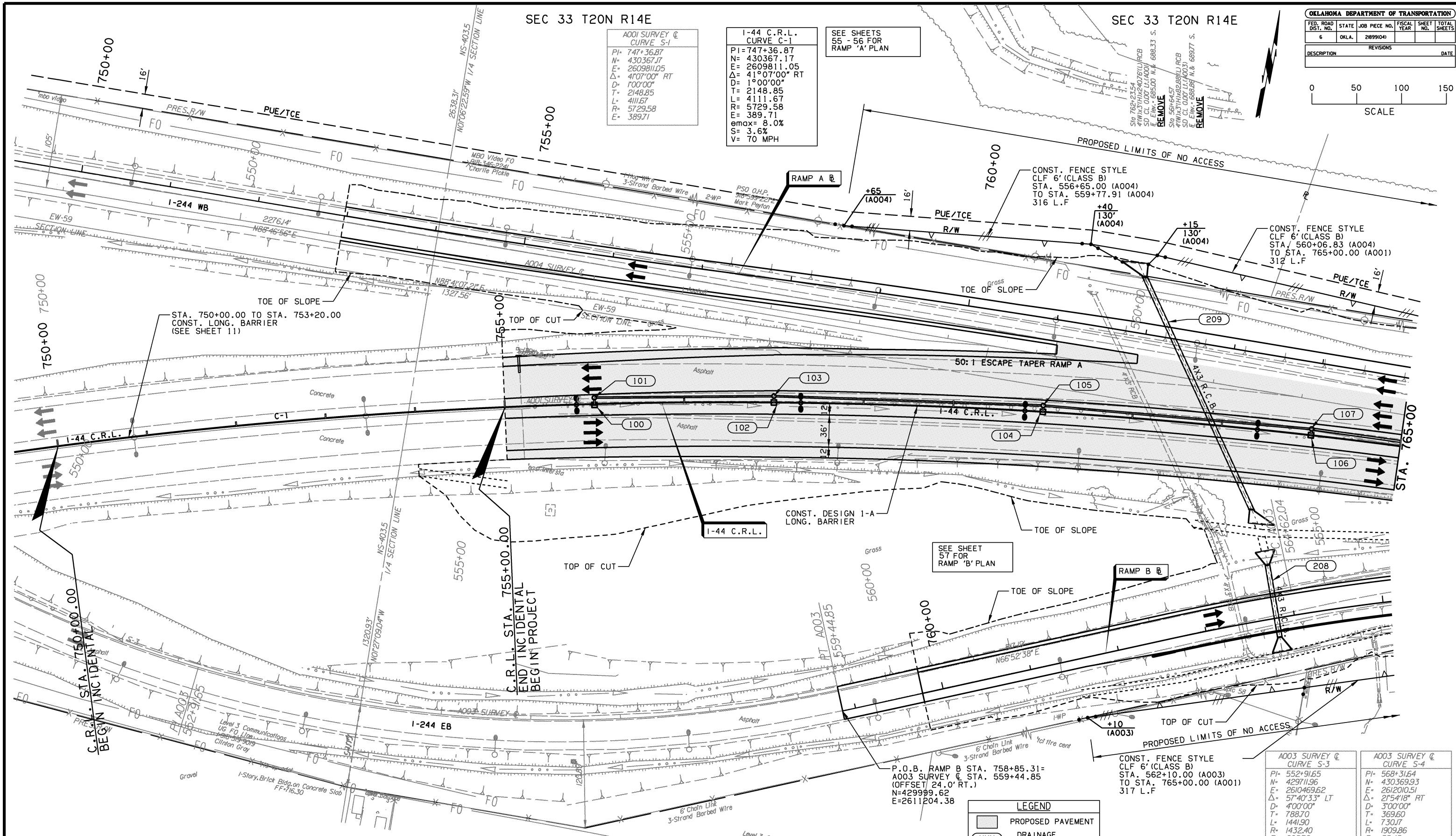

STA. 750+00.00 TO STA. 753+20.00
 CONST. LONG. BARRIER
 (SEE SHEET 11)

CONST. FENCE STYLE
 CLF 6' (CLASS B)
 STA. 556+65.00 (A004)
 TO STA. 559+77.91 (A004)
 316 L.F.

CONST. FENCE STYLE
 CLF 6' (CLASS B)
 STA. 560+06.83 (A004)
 TO STA. 765+00.00 (A001)
 312 L.F.

CONST. DESIGN I-A
 LONG. BARRIER

SEE SHEET 57 FOR RAMP 'B' PLAN

RAMP B

CONST. FENCE STYLE
 CLF 6' (CLASS B)
 STA. 562+10.00 (A003)
 TO STA. 765+00.00 (A001)
 317 L.F.

A003 SURVEY @ CURVE S-3
 PI= 552+91.65
 N= 429711.96
 E= 2610469.62
 Δ= 57°40'33" LT
 D= 4°00'00"
 T= 788.70
 L= 1441.90
 R= 1432.40
 E= 202.78

A003 SURVEY @ CURVE S-4
 PI= 568+31.64
 N= 430369.93
 E= 2612010.51
 Δ= 21°54'18" RT
 D= 3°00'00"
 T= 369.60
 L= 730.17
 R= 1909.86
 E= 35.43

LEGEND

| | |
|--|------------------------|
| | PROPOSED PAVEMENT |
| | DRAINAGE STR. NUMBER |
| | PROPOSED LIGHT FIXTURE |
| | OVERHEAD SIGN STR. |

PRES./PROP. R/W-U/E AND FENCE STATIONS BASED ON SURVEY & ALL OTHER CONST. STATIONS BASED ON C.R.L.

UTILITY CONTACTS:
 AT&T / SWB (COMMUNICATION LINES) 918-237-9768
 MBO VIDEO (COMMUNICATION LINES) 918-346-2241
 LEVEL 3 COMM (COMMUNICATION LINES) 918-519-9019
 O.D.O.T. (ELECTRIC LINES) 405-537-7036
 PSO (ELECTRIC LINES) 918-599-2272
 CITY OF TULSA (WATER/SEWER LINES) 918-596-9566

SEE SHEET 63 FOR I-44 PROFILE

SEE SHEETS 37 - 48 FOR PLAN GEOMETRIC DATA

SEE SHEETS 138 - 146 FOR PLAN STORM SEWER DATA

BM#113 CHISELED BOX ON CONCRETE UTILITY VAULT
 117.20' RT. STA. 755+42.62 EL. 713.97' (A001)

BM#112 #5 REBAR SET FLUSH WITH GROUND
 172.11' RT. STA. 758+26.13 EL. 702.98' (A001)

BM#111 CHISELED "□" ON CONCRETE DRAINAGE FLUME
 210.94' RT. STA. 764+96.63 EL. 693.05' (A001)

| | | | |
|----------|---------------|-------------------------|-------------------------|
| DESIGN | DLT | 8/12 | TULSA & ROGERS COUNTIES |
| DRAWN | MAM | 8/12 | |
| CHECKED | KMM | 6/16 | |
| APPROVED | | | |
| SQUAD | GARVER | STATE JOB NO. 21899(04) | SHEET NO. 50 |

SEC 4 T19N R14E