

OKLAHOMA DEPARTMENT OF TRANSPORTATION						
FED. ROAD DIST. NO.	STATE	JOB PIECE NO.	FISCAL YEAR	SHEET NO.	TOTAL SHEETS	
6	OKLA.					
DESCRIPTION		REVISIONS		DATE		

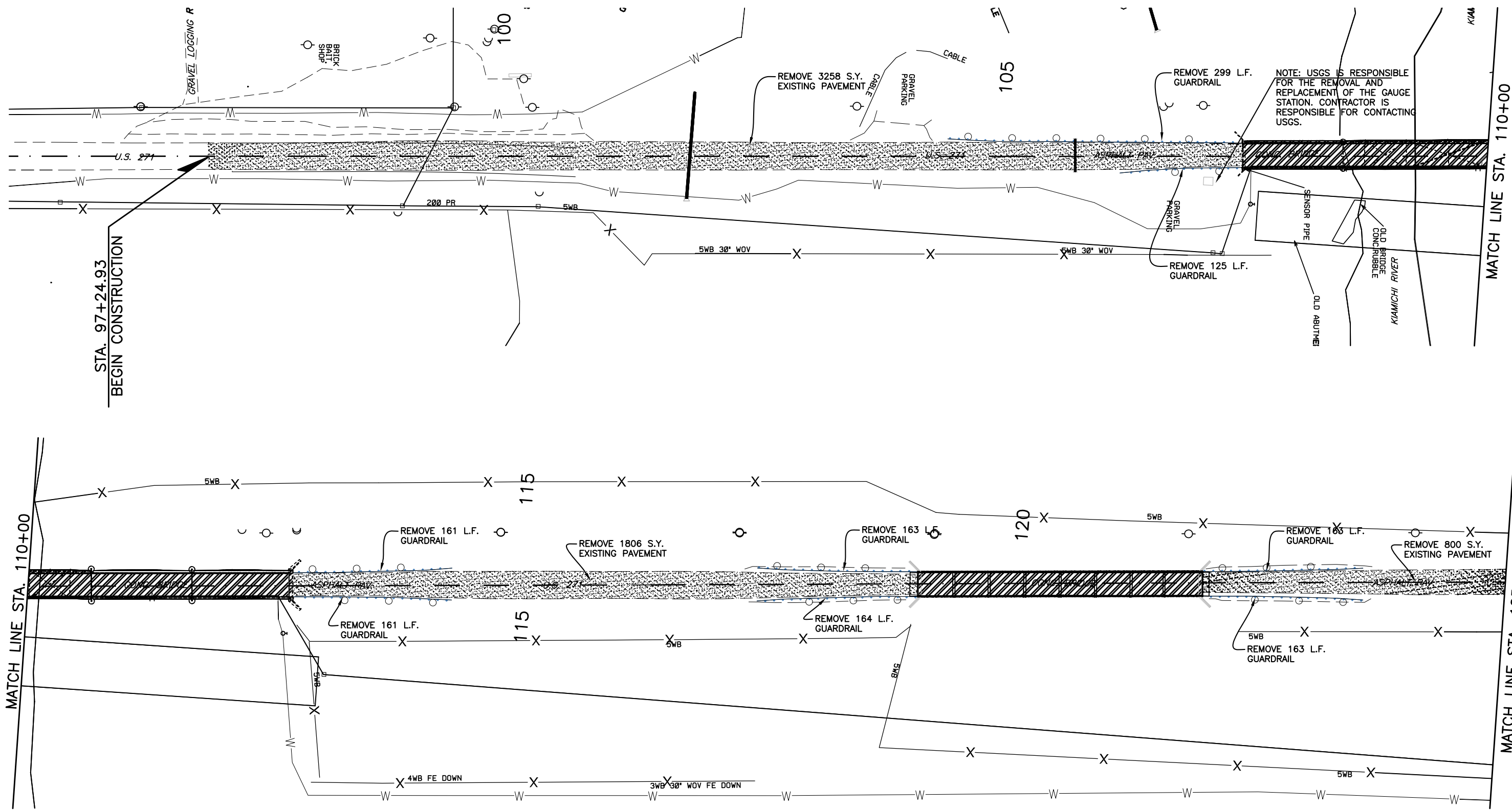

STA. 97+24.93
BEGIN CONSTRUCTION

NOTE: USGS IS RESPONSIBLE FOR THE REMOVAL AND REPLACEMENT OF THE GAUGE STATION. CONTRACTOR IS RESPONSIBLE FOR CONTACTING USGS.

2014-03-18 HA_202957 US-271\ACAD\202957\RECI - RECI (2).dwg

DESIGN		OKLAHOMA DEPARTMENT OF TRANSPORTATION POE & ASSOCIATES REMOVAL PLAN STATE JOB NO. 26346(04) SHEET NO. 70 US-271 OVER KIAMICHI RIVER PUSHMATAHA COUNTY
DRAWN		
CHECKED		
APPROVED		
SQUAD	DE	