

OKLAHOMA DEPARTMENT OF TRANSPORTATION						
FED. ROAD DIST. NO.	STATE	JOB PIECE NO.	FISCAL YEAR	SHEET NO.	TOTAL SHEETS	
6	OKLA.					
DESCRIPTION		REVISIONS			DATE	

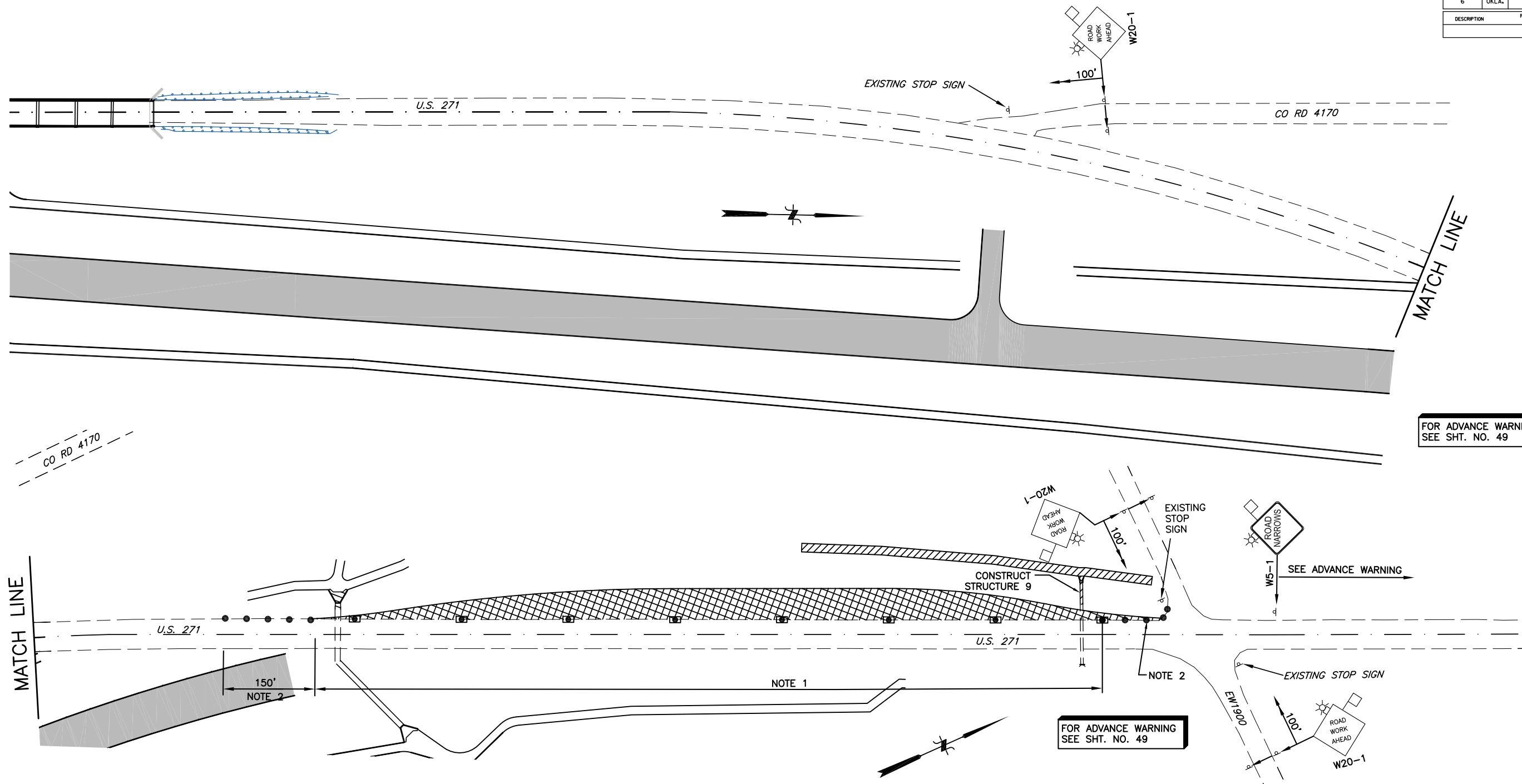

CO RD 4170

MATCH LINE

FOR ADVANCE WARNING
SEE SHT. NO. 49

FOR ADVANCE WARNING
SEE SHT. NO. 49

U.S. 271

U.S. 271

150'
NOTE 2

NOTE 1

NOTE 2

EXISTING STOP SIGN

EM 1900

100'

W20-1

NOTE 1
MAXIMUM SPACING BETWEEN CHANNELIZING DEVICES (FEET) SHALL BE EQUAL TO THE POSTED SPEED LIMIT (M.P.H.) WITH THE FOLLOWING EXCEPTIONS. SPACING SHALL NOT EXCEED 25 FEET FOR CONES OR TUBE CHANNELIZERS; IT SHALL NOT EXCEED 50 FEET FOR TYPE III BARRICADES, VERTICAL PANELS OR DRUMS.

NOTE 2
A MINIMUM OF FIVE (5) CHANNELIZING DEVICES SHALL BE PLACED THRU THIS AREA.

LEGEND

- SIGN
- DRUM
- PREVIOUS PAVING
- WORK AREA
- DETOUR PAVING
- CHANNELIZER CONE

NOT TO SCALE

PHASE 2A

DESIGN	
DRAWN	
CHECKED	
APPROVED	
SQUAD	

OKLAHOMA DEPARTMENT OF TRANSPORTATION
POE & ASSOCIATES

**SUGGESTED CONSTRUCTION
TRAFFIC CONTROL**

STATE JOB NO. 26346(04) SHEET NO. 57

SH-271 OVER KIAMICHI RIVER PUSHMATAHA COUNTY

2014-03-18 H:\202957 US-271\ACAD\202957TTC02.dwg