

REVISIONS		
NO.	DESCRIPTION	DATE

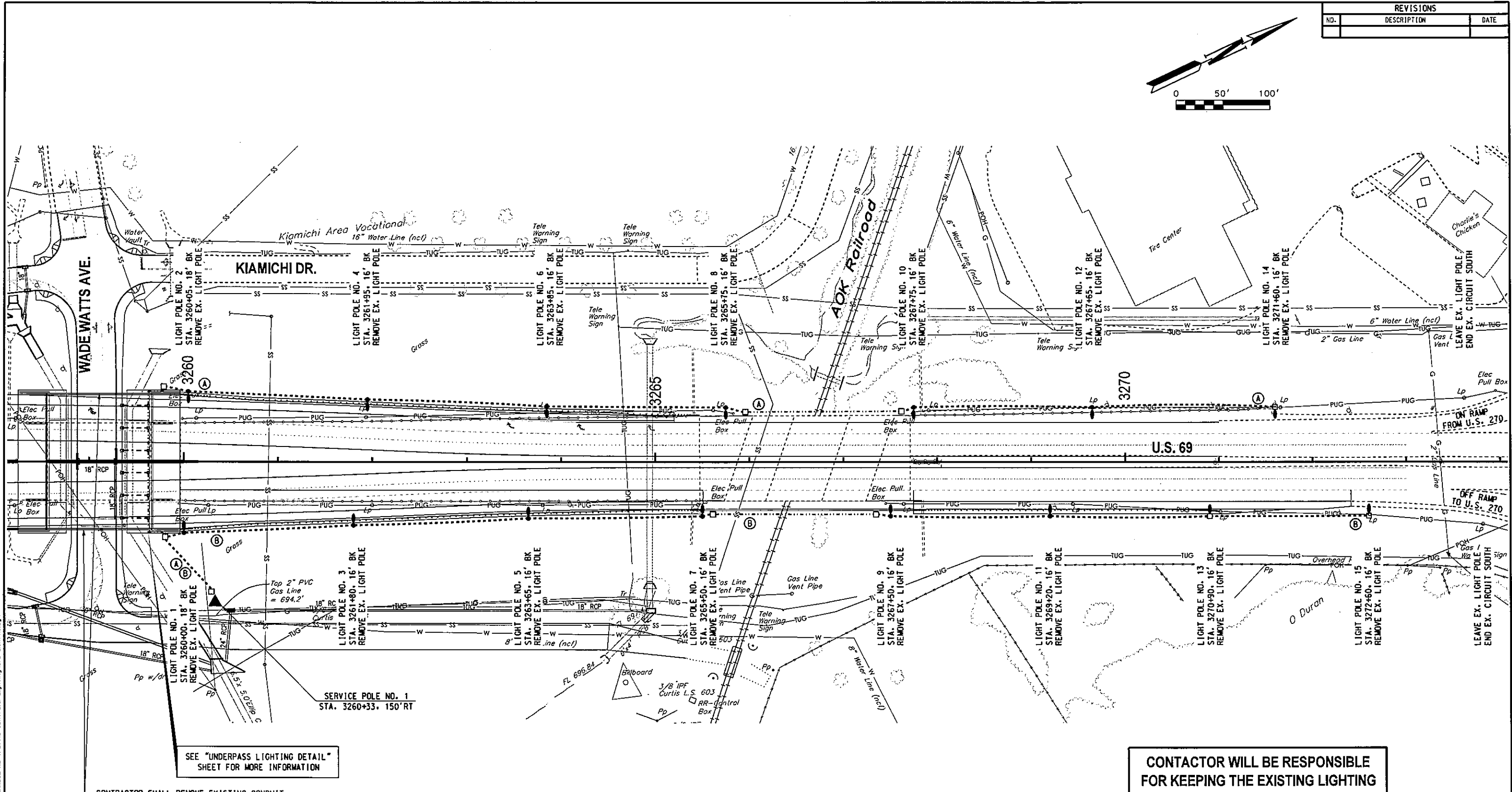
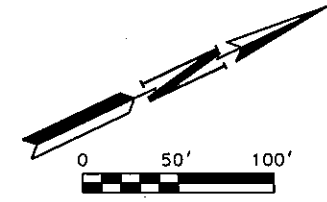

SEE "UNDERPASS LIGHTING DETAIL" SHEET FOR MORE INFORMATION

CONTRACTOR SHALL REMOVE EXISTING CONDUIT CROSSING BRIDGE ON BOTH SIDES, UNLESS NEEDED FOR CONTINUING EXISTING LIGHTING CIRCUIT TO THE SOUTH.

**CONTACTOR WILL BE RESPONSIBLE FOR KEEPING THE EXISTING LIGHTING CIRCUITS WORKING.**

LEGEND	
	1 1/2" ELECT. CONDUIT (EXPOSED)
	2" ELECT. PVC CONDUIT (TRENCHED)
	2" ELECT. CONDUIT (BORED)
	EXISTING CONDUIT
	SPECIAL MEDIAN BARRIER PULL BOX
	SIZE I PULL BOX
	ELECTRIC SERVICE LOCATION
	CIRCUIT DESIGNATION
	LIGHT POLE W/O BREAKAWAY BASE
	LIGHT POLE W/ BREAKAWAY BASE
	TWIN LIGHT POLE W/O BREAKAWAY BASE
	TWIN LIGHT POLE W/ BREAKAWAY BASE

*R. Wayne Russell*  
 R. WAYNE RUSSELL, P.E. # 16030  
 C.A. # 1160; RENEWAL 06-30-17

7-7-16  
 DATE

Traffic Engineering Consultants, Inc.  
 6000 S. Western, Suite 300 - Oklahoma City, OK 73139,  
 Ph: 405-720-7221, Fax: 405-720-9848, Web: www.tecok.com

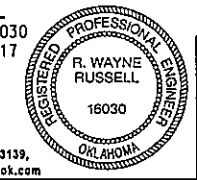

Design	RWR	07-07-16
Drawn	SB	07-07-16



**LIGHTING PLAN**  
 U.S. 69

State Job No. 14999(04)

Sheet No. L2

07-07-16 G:\07Projects\1-2462A US 69 Interch @ Minehead Rd Traffic Control & Lighting\CAD\LIGHTING.dgn