

S:\Projects\DOT\US 69 Comanche\Acad\dwg\ACAD PROJECT 1\US69\com08-081-Advance Warning.dwg, 7/14/2016 11:01:56 AM

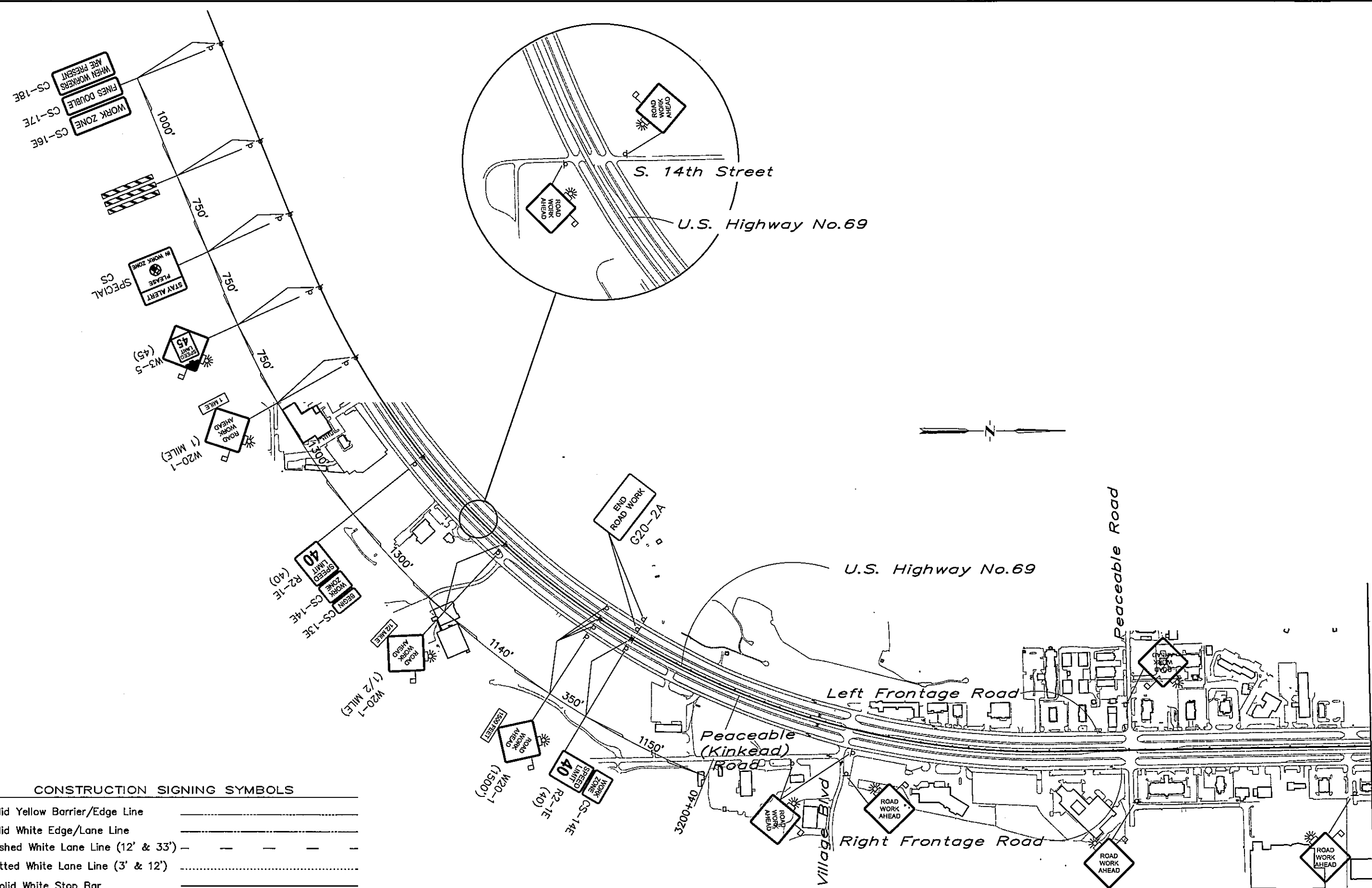

CONSTRUCTION SIGNING SYMBOLS

| | |
|---------------------------------------|-----------|
| 4" Solid Yellow Barrier/Edge Line | _____ |
| 4" Solid White Edge/Lane Line | _____ |
| 4" Dashed White Lane Line (12' & 33') | - - - - - |
| 4" Dotted White Lane Line (3' & 12') | |
| 24" Solid White Stop Bar | ===== |
| Portable Longitudinal Barrier | ===== |

| | | | |
|----------------|---|-------------------------------|-------|
| Arrow Panel | ■ | Drum | ■ |
| Sign, as Noted | □ | Type III Barricade | ⌋ |
| Tube | ○ | Const. Zone Impact Attenuator | ▬▬▬▬▬ |
| Vertical Panel | ⊕ | | |

ADVANCE WARNING SIGNS

TO BE IN PLACE DURING ALL PHASES OF WORK AND SUPPLEMENTED AS NOTED OR AS DIRECTED BY THE ENGINEER



| | | | |
|----------|-------|--|------------------|
| Survey | CKS | U.S. 69 - COMANCHE AVENUE | PITTSBURG COUNTY |
| Drawn | CKD | ADVANCE WARNING SIGNS TRAFFIC CONTROL PLANS | |
| Checked | CKE | | |
| Approved | | | |
| Squad | C & K | | |
| | | JOB PIECE NO. 14999(04) | SHEET NO. 60 |

MATCH LINE STA. 3240+00 (CRL)