

S:\Projects\ODOT\US69\com037-038-pr R\F\mfd.dwg, 7/14/2016 10:56:39 AM

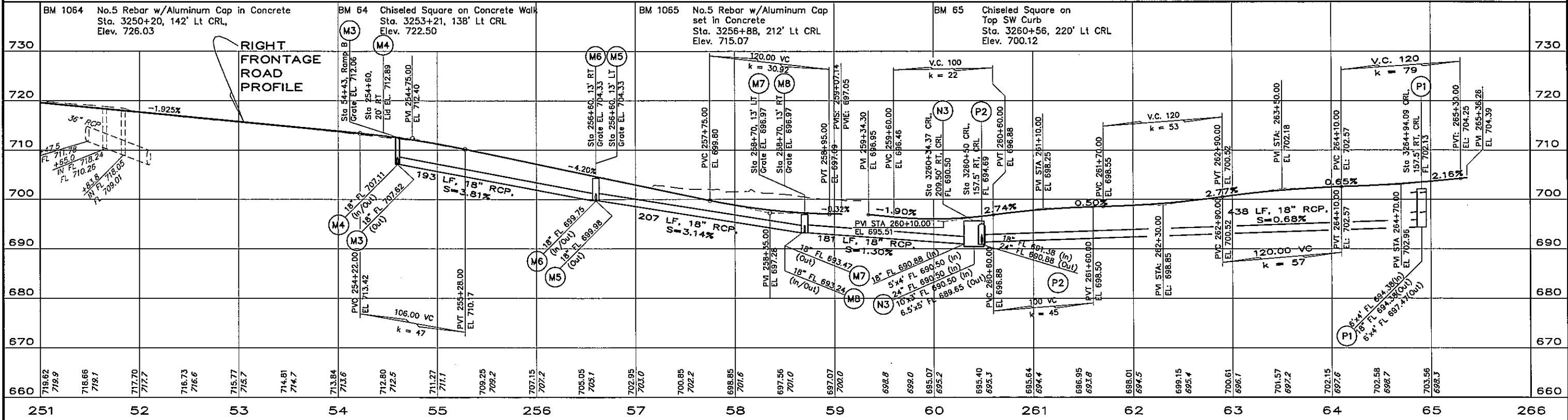
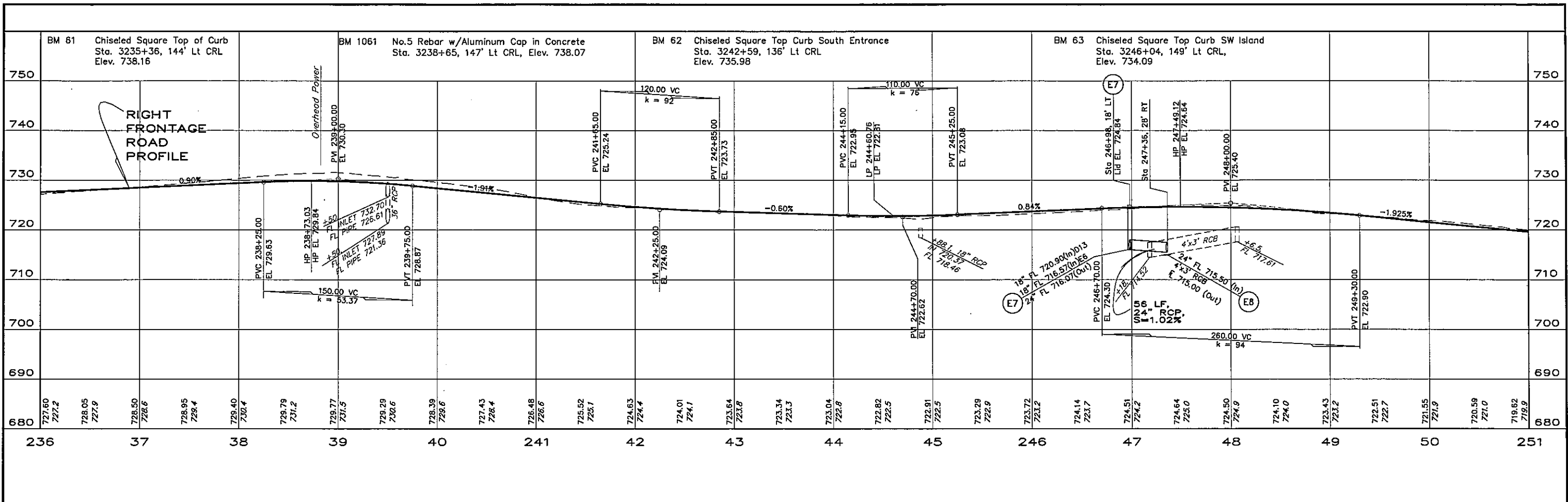

REGISTERED PROFESSIONAL ENGINEER  
 ROBIN D. SEWELL  
 16173  
 7/18/16

Survey	CKS	U.S. 69 - COMANCHE AVENUE	PITTSBURG COUNTY
Drawn	CKD	<b>RIGHT FRONTAGE ROAD PROFILE</b> STA. 236+00 TO STA. 265+00	
Checked	CKE		
Approved			
Squad	C & K	JOB PIECE NO. 14999(04)	SHEET NO. 38