

7/13/2016  
 3:23:52 PM  
 F:\Projects\015-0013\TRNS\DCN\WP2\C\DRAINMAP\0150814\_WP2.dgn

**DRAINAGE STRUCTURE DESIGN RECORD**

STRUCTURE NO.	DESIGN YEAR	CENTER LINE STATION	STRUCTURE SIZE & TYPE	DRAINAGE AREA AC	ANTICIPATED LAND USE	AVG. SLOPE OF WATERSHED FT/FT	"C" RUNOFF COEFFICIENT WEIGHTED	LENGTH OF OVERLAND FLOW FT	LENGTH OF CHANNEL FLOW FT	SLOPE OF CHANNEL FT/FT	"Tc" TIME OF CONCENTRATION MIN	INTENSITY OF DESIGN YEAR RAINFALL			DESIGN YEAR DISCHARGE			TW. DESIGN TAILWATER FT	FLOW LINE INLET ELEV.	FLOW LINE OUTLET ELEV.	STRUCTURE SLOPE FT/FT	MAXIMUM ALLOWABLE HEADWATER ELEV.	FLOW VELOCITY V50 FT/S	CONTROLLING HEADWATER ELEV.	TYPE OF HYDRAULIC CONTROL	REMARKS
												10 IN/HR	50 IN/HR	100 IN/HR	10 CFS	50 CFS	100 CFS									
28	50	STA. 73+10.00 CRL. WESTERN RD	REMOVE EXISTING 60" CGMP. CONSTRUCT 85 LF 1-6'X6' RCB W/ SP. DES. END SECTIONS	139.54	PASTURE	0.014	0.36	1177	2201	0.013	49.7		3.84		289.60		2.73	925.75	924.47	0.0148	933.83	17.65	933.35	INLET		

CITY OF **stillwater**

FED. ROAD DIST. NO.	STATE	PROJ. NO.	FISCAL YEAR	SHEET NO.	TOTAL SHEETS
6	OKLA	31595(04)	16		***

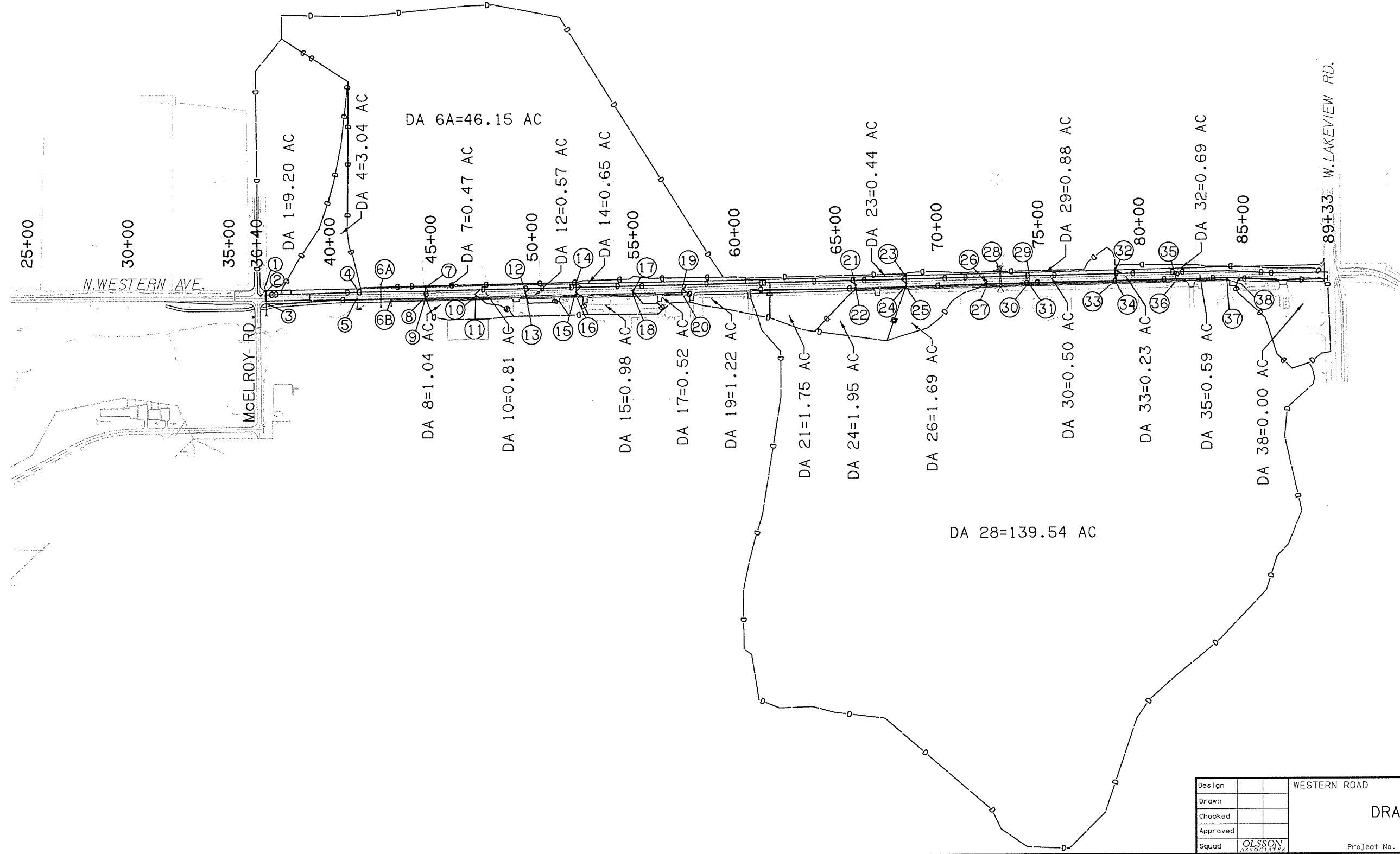

Design		WESTERN ROAD	PAYNE COUNTY
Drawn		<b>DRAINAGE MAP</b>	
Checked			
Approved			
Squad	OLSSON ASSOCIATES		
Project No. 31595(04)		Sheet No. 14	