

CITY OF stillwater				
FED ROAD DIST NO	STATE	PROJ NO	FISCAL YEAR	TOTAL SHEETS
6	OKLA	31595(04)	16	

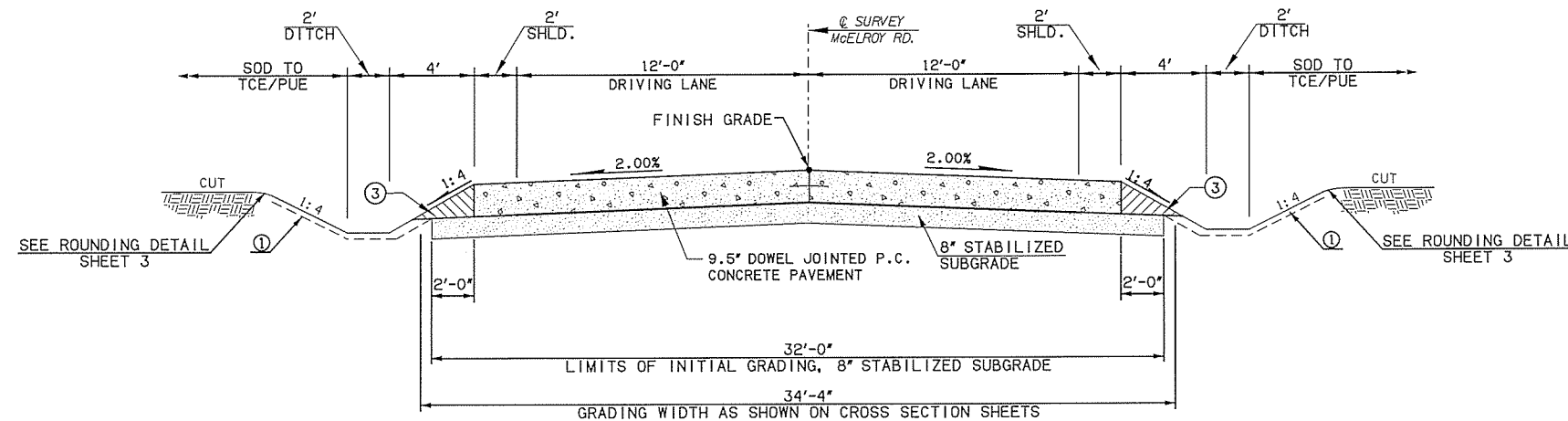

TYPICAL SECTION NO. 5

McELROY ROAD
 STA. 12+00.00 TO 14+67.14
 STA. 15+31.14 TO 16+50.00

- ① THE CONTRACTOR SHALL STRIP ALL OF THE AVAILABLE TOPSOIL, STOCKPILE IT, AND PLACE IT BACK ON THE SECTION IN ACCORDANCE WITH SECTION 205 OF THE STANDARD SPECIFICATION. RESERVED TOPSOIL SHALL BE SPREAD FIRST ON THE COMPLETED SLOPES OF THE CUT SECTION AND THE REMAINDER ON COMPLETED FILL SLOPES OR OTHER PRIORITY AREAS LOCATED BY THE ENGINEER. ALL ADDITIONAL COST ASSOCIATED WITH OPERATIONS SHALL BE INCLUDED IN THE PAY ITEM FOR SALVAGED TOPSOIL, LUMP SUM.
- ② SEE STREETScape PLAN FOR DECORATIVE CONCRETE DETAIL.
- ③ THIS AREA TO BE BACKFILLED AND COMPACTED (95% STD. PROCTOR) AS FINISHING OPERATION. COST TO BE INCLUDED IN OTHER ITEMS OF WORK.

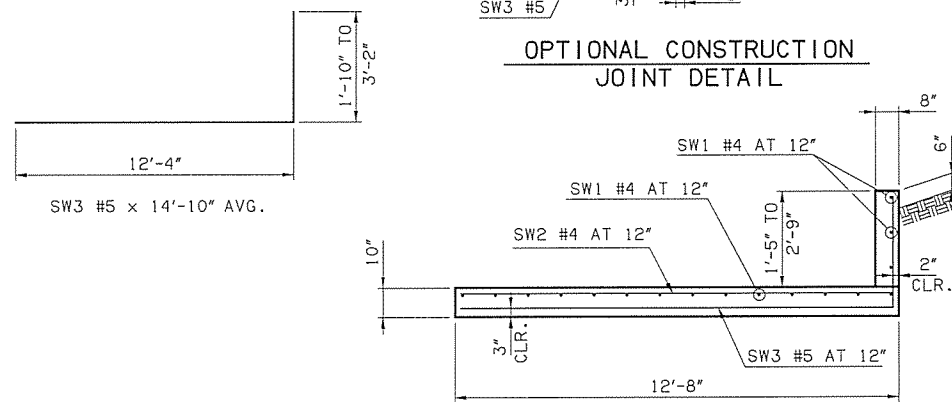
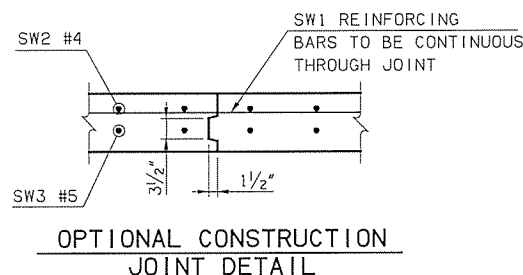

RETAINING WALL SECTION

STATION 88+00 TO 89+00

- NOTES: ① RETAINING WALL HEIGHT SHALL BE 1'-5" BEGINNING AT STA. 88+00.00 AND RISE TO A HEIGHT OF 2'-9" AT STA. 89+00.00.
- ② RETAINING WALL SHALL BE PAID FOR AS SY. OF RETAINING WALL.

Design		WESTERN ROAD	PAYNE COUNTY
Drawn		TYPICAL SECTIONS (2)	
Checked			
Approved			
Squad	OLSSON ASSOCIATES	Project No. 31595(04)	Sheet No. 5