

DOT DIVISION	STATE	J/P PROJ NO	FISCAL YEAR	SHEET NO	TOTAL SHEETS
8	OKLA	24750(04)		54	127

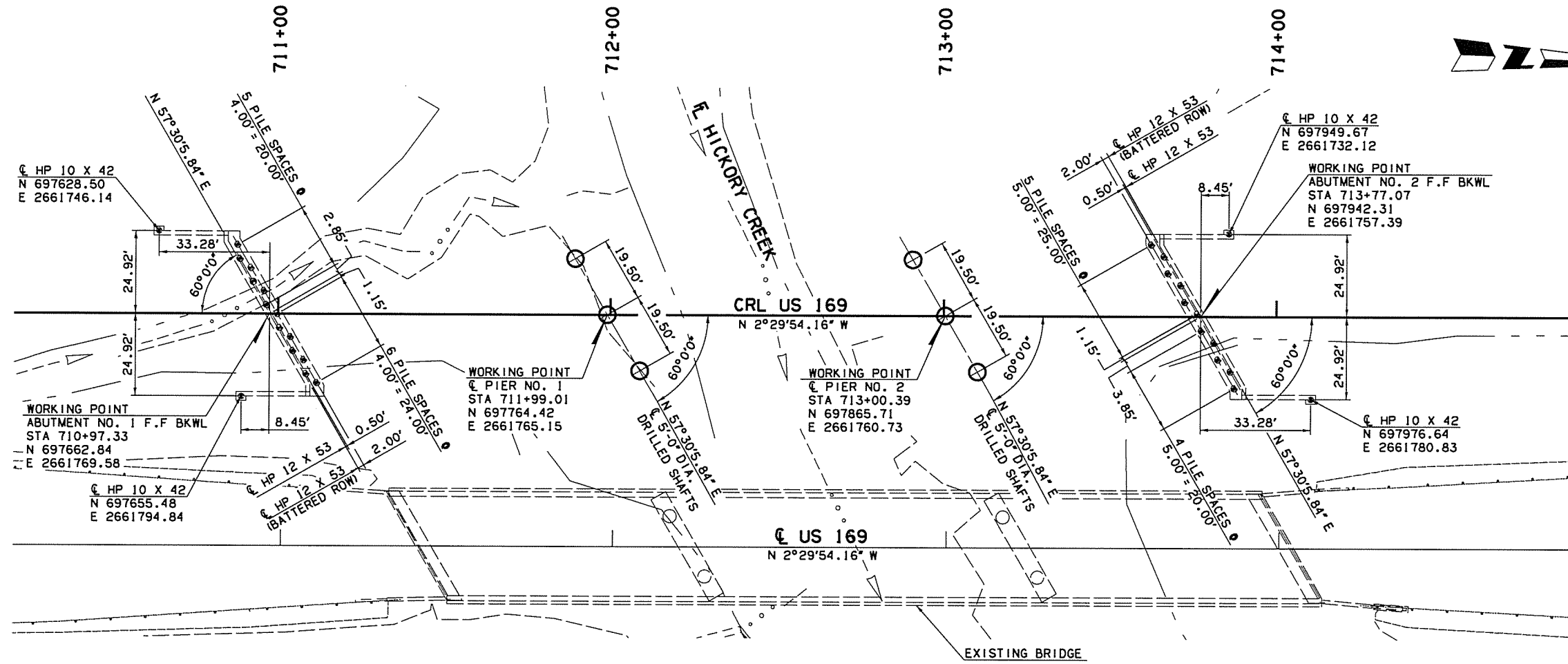

**SUMMARY OF QUANTITIES - BRIDGE A**

DESCRIPTION	UNIT	ABUTMENT	PIER	SUPERSTR.	APPROACH	TOTAL
<b>SUBSTRUCTURE EXCAVATION COMMON</b>						
CLSM BACKFILL	CY	255				255
PRESTRESSED CONCRETE BEAMS (TYPE IV)	LF			1370.0		1370.0
APPROACH SLAB	SY				443.2	443.2
SAW-CUT GROOVING	SY			1376.1	415.0	1791.1
SEALED EXPANSION JOINT	LF			53.67		53.67
42" F-SHAPED PARAPET	LF			563.0	169.8	732.8
STRUCTURAL STEEL	LB			1670		1670
STAINLESS STEEL FIXED BEARING ASSEMBLY	EA			20		20
STAINLESS STEEL EXPANSION BEARING ASSEMBLY	EA			10		10
SPECIAL CONCRETE FINISH	SY		104			104
CLASS AA CONCRETE	CY			375.5		375.5
CLASS A CONCRETE	CY	129.7	183.7			313.4
REINFORCING STEEL	LB		2330			2330
EPOXY COATED REINFORCING STEEL	LB	19980	25720	112370		158070
CLASS C BRIDGE DECK REPAIR	SY				100	100
PILES, FURNISHED (HP10X42)	LF	132				132
PILES, FURNISHED (HP12X53)	LF	678				678
PILES, DRIVEN (HP10X42)	LF	132				132
PILES, DRIVEN (HP12X53)	LF	678				678
METAL PILE SHOES	EA	28				28
PILE SPLICE, H-PILE (NON-BIDDABLE)	EA	1				1
WATER REPELLENT (VISUALLY INSPECTED)	SY	200	120	1138	150	1608
DRILLED SHAFTS 60" DIAMETER	LF		155			155
CROSSHOLE SONIC LOGGING	EA		1			1
SEALER CRACK PREPARATION	LF			54		54
SEALER RESIN	GAL			0.4		0.4
TYPE I-A PLAIN RIPRAP	TON	1760				1760
TYPE I-A FILTER BLANKET	TON	300				300
FILTER FABRIC (RIPRAP)	SY	1236				1236
6" PERFORATED PIPE UNDERDRAIN ROUND	LF	115				115
6" NON-PERF. PIPE UNDERDRAIN RND.	LF	40				40
REMOVAL OF BRIDGE ITEMS	LSUM					1

**PLAN - BRIDGE A**

SCALE: 1" = 20'

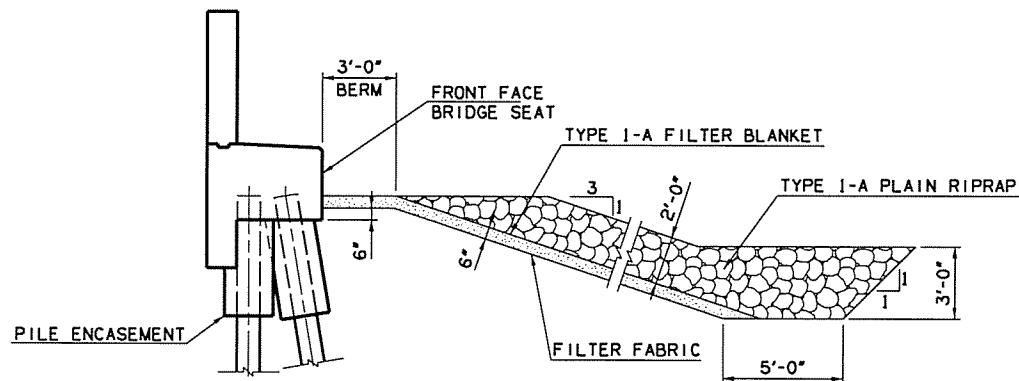

**TYPICAL RIPRAP SECTION**

SCALE: NONE

**NOTE:**

- ABUTMENT PILES SHALL BE ORIENTED SUCH THAT THE FLANGES ARE PARALLEL WITH THE FACE OF THE BRIDGE SEAT.
- CONTRACTOR SHALL VERIFY LOCATION AND STATUS (I.E. "ABANDONED") OF ALL UTILITIES PRIOR TO BEGINNING EXCAVATION OR DRIVING PILES.
- HARD ROCK WAS ENCOUNTERED AT THIS SITE. EXCAVATION FOR THE FOUNDATIONS MAY REQUIRE SPECIALTY HEAVY-DUTY DRILLING EQUIPMENT. THE CONTRACTOR IS RESPONSIBLE FOR BEING FULLY AWARE OF THE FOUNDATION MATERIAL CONDITIONS AND THE DRILLING PROCESS PRIOR TO BEGINNING WORK.

**TOP OF PILE ELEVATIONS**

ABUTMENT NO. 1	697.86
ABUTMENT NO. 2	693.38

**INDEX OF BRIDGE SHEETS**

SHEET NO.	TITLE
51	GENERAL PLAN AND ELEVATION
52 - 53	FOUNDATION REPORT
54	STAKING DIAGRAM
55	TYPICAL SECTION
56 - 61	ABUTMENT DETAILS
62 - 63	PIER DETAILS
64 - 65	P. C. TYPE IV BEAM DETAILS
66 - 69	SUPERSTRUCTURE DETAILS
70	LONGITUDINAL SECTION
71 - 72	APPROACH SLAB DETAILS

**BRIDGE STANDARDS**

- FSHP-42-2
- EJ-SK
- EJ-DTL
- HP1-2
- B40-C-ABUT-MISC
- B40-C-PCB-DTL
- B40-C-BRG-PC4BT

Design	AEJ	6/16	US 169 OVER HICKORY CREEK	NOWATA COUNTY
Drawn	WZB	6/16	BRIDGE A	
Checked	KSJ	6/16		
Approved	SAK	6/16		
Squad	BENHAM			

**STAKING DIAGRAM**  
Job Piece No. 24750(04) Sheet No. 54