

7/12/2016

7:39:01 AM

P:\NEC\650-TUL\CV\25523\0000\_0001\_US169BR-dg\20\_DESIGN\40\_CAD\_Hickory\06\CV\24750\041\_C\_Plan\_Const\_Seq\_02.dgn

NO. DIVISION	STATE	J/P PROJ NO	FISCAL YEAR	SHEET NO	TOTAL SHEETS
8	OKLA	24750(04)		29	127

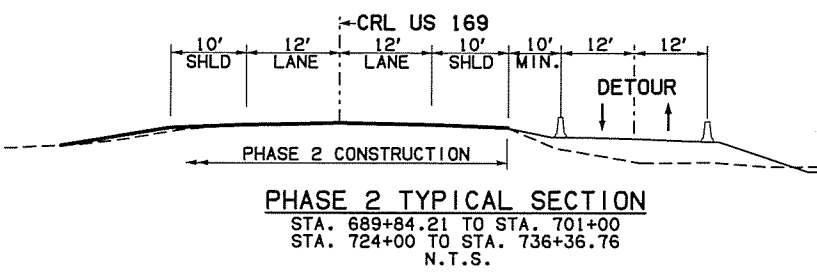
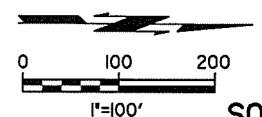
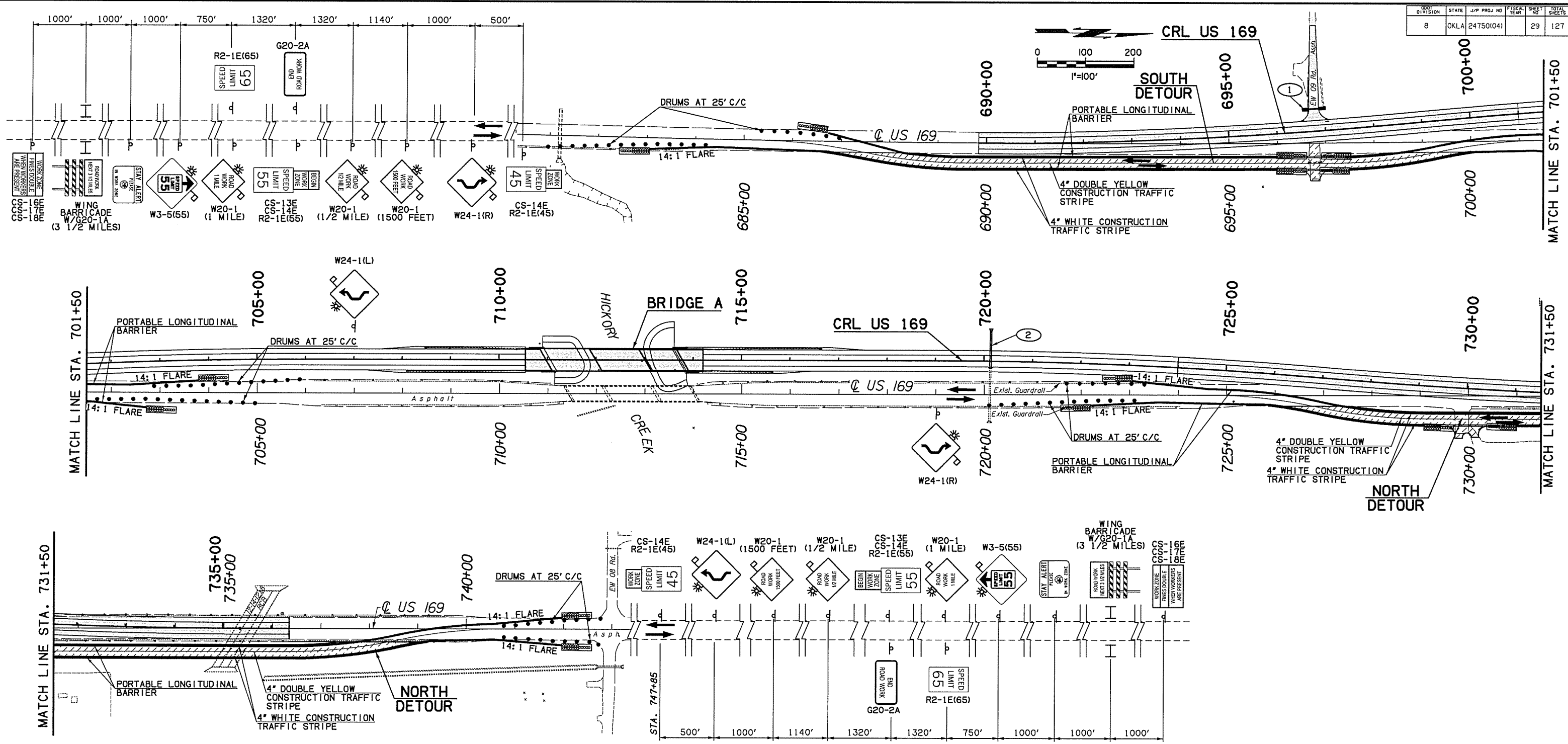

PHASE 2		
ITEM	CONSTRUCTION	TRAFFIC
US 169	Sta. 689+84.21 to Sta. 701+00 except east foreslope / ditch Sta. 724+00 to Sta. 736+36.76 except east foreslope / ditch	On South Detour, Existing US 169, North Detour
South Detour	No construction	
North Detour	No construction	
Bridge A	Construct	

LEGEND	
[Hatched Box]	CONSTRUCTION
[Diagonal Hatched Box]	TEMPORARY CONSTRUCTION
[Solid Box]	COMPLETED CONSTRUCTION
[Diagonal Hatched Box]	COMPLETED TEMPORARY CONSTRUCTION
[Symbol]	SIGN
[Symbol]	DRUMS
[Symbol]	WING BARRICADE
[Symbol]	TRAFFIC FLOW DIRECTION
[Symbol]	PORTABLE LONGITUDINAL BARRIER
[Symbol]	IMPACT ATTENUATOR

Design		US 169 OVER HICKORY CREEK	NOWATA COUNTY
Drawn		<b>SUGGESTED CONSTRUCTION SEQUENCE/TRAFFIC CONTROL (2)</b>	
Checked			
Approved			
Squad			
		State Job No. 24750(04)	Sheet No. 29