

DOT DIVISION	STATE	J/P PROJ NO	FISCAL YEAR	SHEET NO	TOTAL SHEETS
8	OKLA	24750(04)		25	127

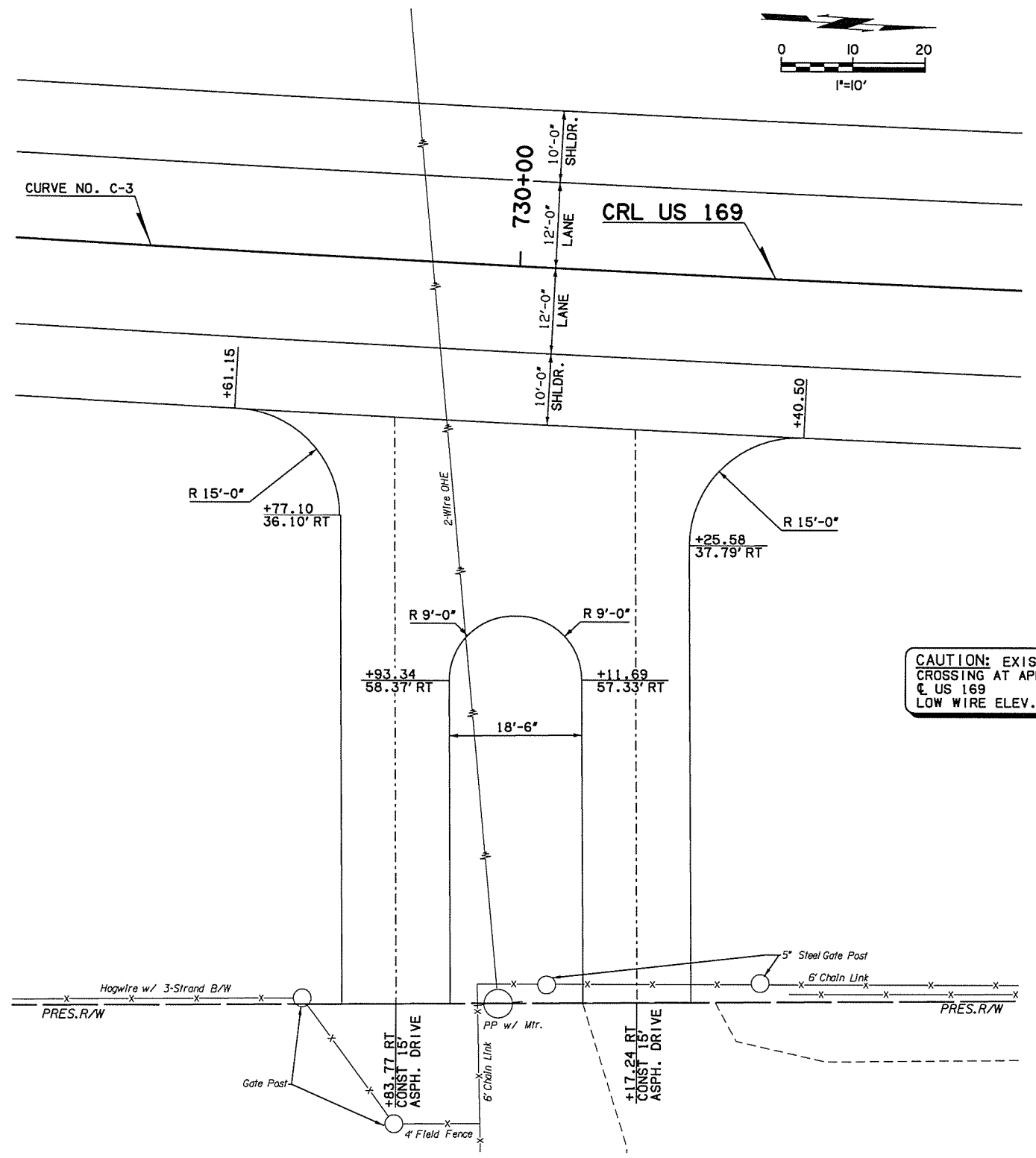

CAUTION: EXIST. OVERHEAD ELECTRIC CROSSING AT APPROX. STA. 729+86.55, @ US 169 LOW WIRE ELEV. 737.90

PLAN
DRIVEWAY STA. 729+83.77 RT.
DRIVEWAY STA. 730+17.24 RT.

Design		US 169 OVER HICKORY CREEK	NOWATA COUNTY
Drawn		DRIVEWAY DETAILS	
Checked			
Approved			
Squad			
		State Job No. 24750(04)	Sheet No. 25