

7/12/2016

7:38:54 AM

P:\NEC\1650-TUL\CIV\255231000_000T_US169Brdg\20_DESGN\40_CAD_Hickory\40_CAD_Profile_N_Detour_01.dgn

SEC. 19, T28N, R16E

NOTE: FOR R/W LINE STATION OFFSETS AND DIMENSIONS REFER TO THE US 169 PLAN AND PROFILE SHEETS

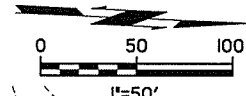

DATE	STATE	JOB PROJ NO	FISCAL YEAR	SHEET NO	TOTAL SHEETS
8	OKLA	24750(04)		21	127

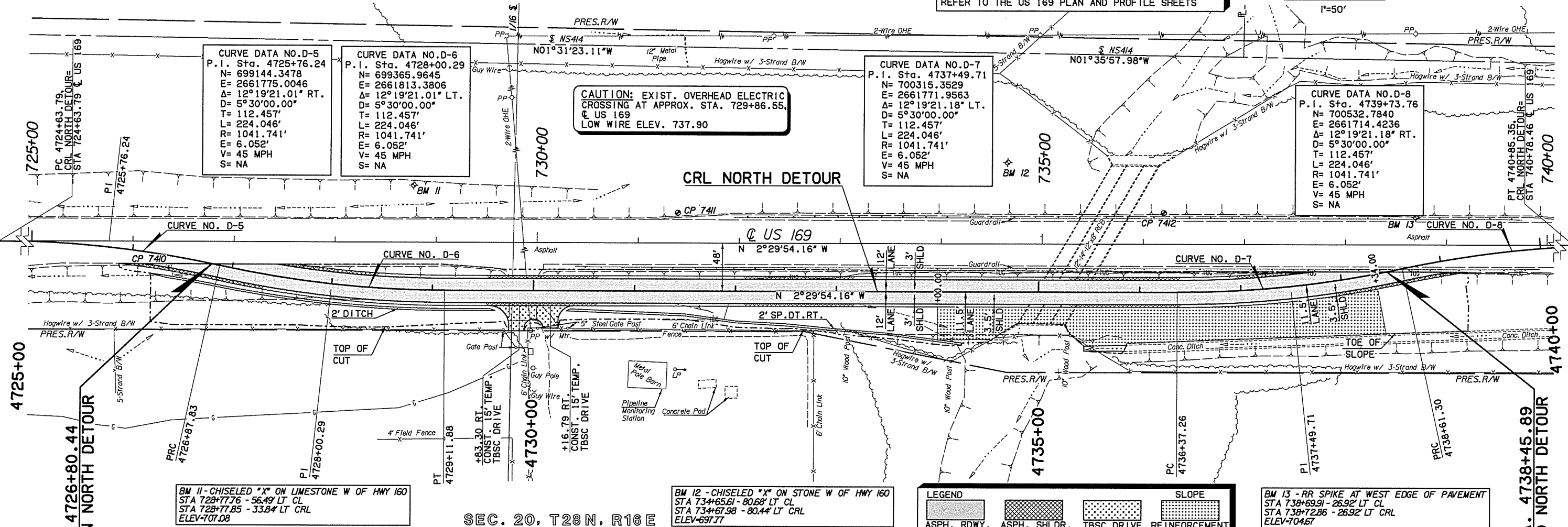

BM II - CHISELED *X* ON LIMESTONE W OF HWY 160
 STA 728+77.76 - 56.49' LT CL
 STA 728+77.85 - 33.84' LT CRL
 ELEV=707.08

BM 12 - CHISELED *X* ON STONE W OF HWY 160
 STA 734+65.61 - 80.68' LT CL
 STA 734+67.98 - 80.44' LT CRL
 ELEV=697.77

LEGEND

- ASPH. RDWY.
- ASPH. SHLDR.
- TBSC DRIVE
- REINFORCEMENT

SLOPE

- 0.28%
- 0.65%
- 0.06%
- 1.94%
- 3.00%
- 4.44%
- +1.01%

BM 13 - RR SPIKE AT WEST EDGE OF PAVEMENT
 STA 739+69.91 - 26.92' LT CL
 STA 739+72.86 - 26.92' LT CRL
 ELEV=704.67

SEC. 20, T28N, R16E

