

SEC. 19, T28N, R16E

SEC. 20, T28N, R16E

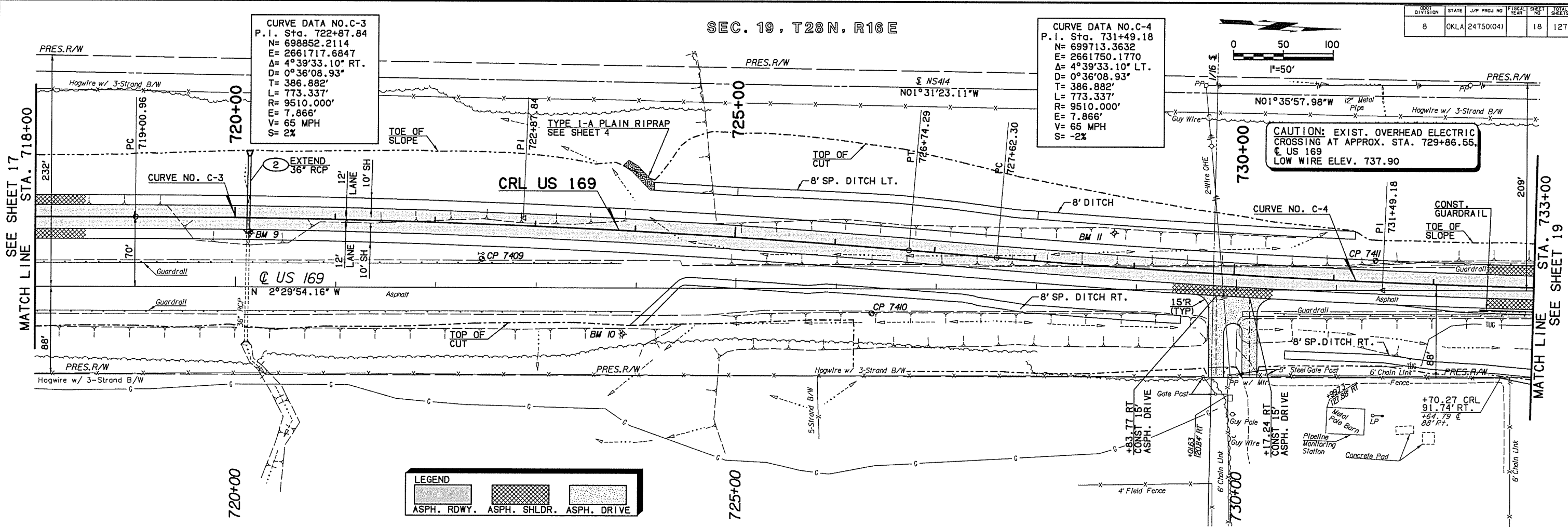

CURVE DATA NO. C-3
 P.I. Sta. 722+87.84
 N= 698852.2114
 E= 2661717.6847
 Δ= 4°39'33.10" RT.
 D= 0°36'08.93"
 T= 386.882'
 L= 773.337'
 R= 9510.000'
 E= 7.866'
 V= 65 MPH
 S= 2%

CURVE DATA NO. C-4
 P.I. Sta. 731+49.18
 N= 699713.3632
 E= 2661750.1770
 Δ= 4°39'33.10" LT.
 D= 0°36'08.93"
 T= 386.882'
 L= 773.337'
 R= 9510.000'
 E= 7.866'
 V= 65 MPH
 S= -2%

CAUTION: EXIST. OVERHEAD ELECTRIC CROSSING AT APPROX. STA. 729+86.55, E US 169 LOW WIRE ELEV. 737.90

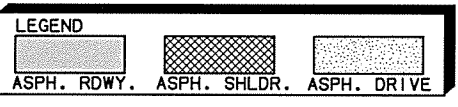

BM 9 - CHISELED "X" ON W HEADWALL
 STA 720+1471 - 5403' LT CL
 STA 720+1586 - 1527' RT CRL
 ELEV-688.21

BM 10 - 80D IN 8" REDBUD TREE
 STA 723+86.90 - 46.46' RT CL
 STA 723+93.46 - 103.85' RT CRL
 ELEV-696.21

BM 11 - CHISELED "X" ON LIMESTONE W OF HWY 160
 STA 728+7736 - 56.49' LT CL
 STA 728+7785 - 33.84' LT CRL
 ELEV-707.08

