

UNIT	DIVISION	STATE	S/J PROJ NO	FISCAL YEAR	SHEET NO	TOTAL SHEETS
8	OKLA	24750(04)			17	127

SEC. 19, T28N, R16E

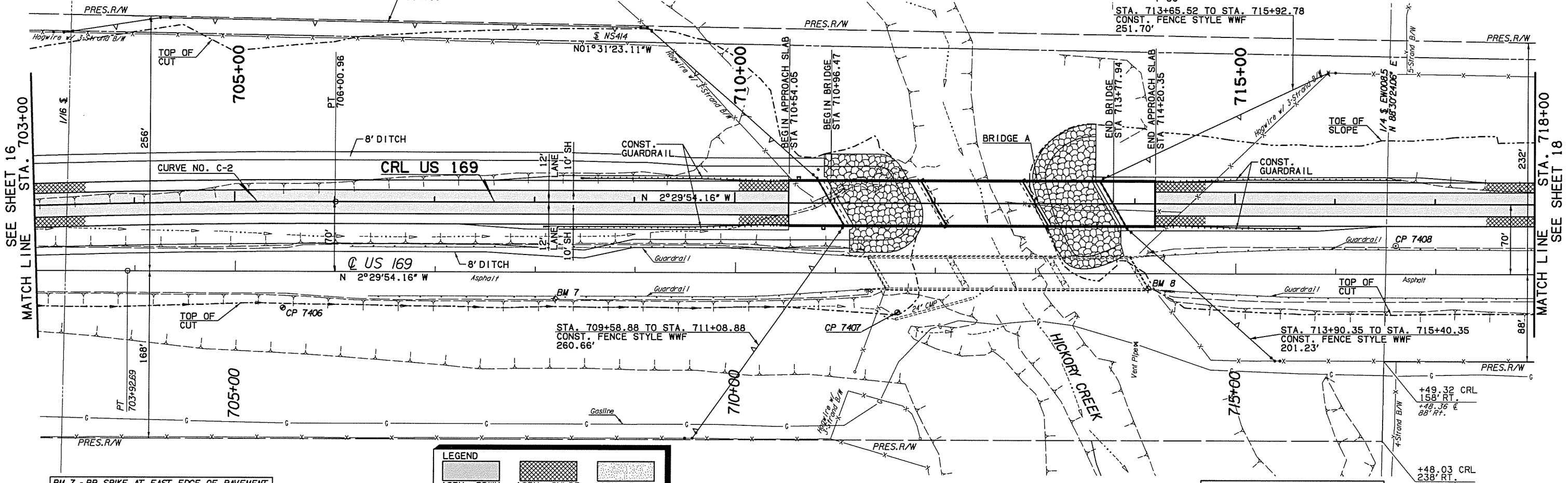
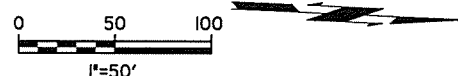

SEE SHEET 16
MATCH LINE STA. 703+00

MATCH LINE STA. 718+00
SEE SHEET 18

LEGEND

- ASPH. RDWY.
- ASPH. SHLDR.
- ASPH. DRIVE

BM 7 - RR SPIKE AT EAST EDGE OF PAVEMENT
 STA 708+20.25 - 27.07' RT CL
 STA 708+21.20 - 97.07' RT CRL
 ELEV=711.90

BM 8 - CHISELED "X" ON NE HUBGUARD
 STA 714+12.60 - 15.77' RT CL
 STA 714+13.56 - 85.77' RT CRL
 ELEV=702.33

SEC. 20, T28N, R16E

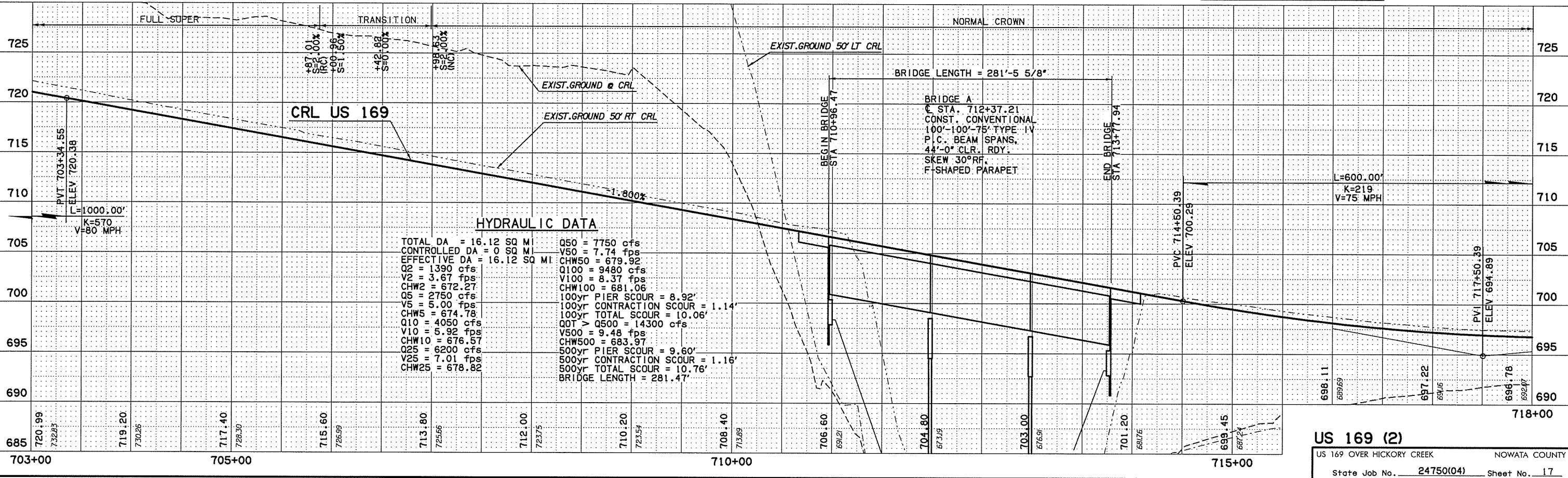

HYDRAULIC DATA

TOTAL DA = 16.12 SQ MI	Q50 = 7750 cfs
CONTROLLED DA = 0 SQ MI	V50 = 7.74 fps
EFFECTIVE DA = 16.12 SQ MI	CHW50 = 679.92
Q2 = 1390 cfs	Q100 = 9480 cfs
V2 = 3.67 fps	V100 = 8.37 fps
CHW2 = 672.27	CHW100 = 681.06
Q5 = 2750 cfs	100yr PIER SCOUR = 8.92'
V5 = 5.00 fps	100yr CONTRACTION SCOUR = 1.14'
CHW5 = 674.78	100yr TOTAL SCOUR = 10.06'
Q10 = 4050 cfs	QOT > Q500 = 14300 cfs
V10 = 5.92 fps	V500 = 9.48 fps
CHW10 = 676.57	CHW500 = 683.97
Q25 = 6200 cfs	500yr PIER SCOUR = 9.60'
V25 = 7.01 fps	500yr CONTRACTION SCOUR = 1.16'
CHW25 = 678.82	500yr TOTAL SCOUR = 10.76'
	BRIDGE LENGTH = 281.47'