

BOOK DIVISION	STATE	J/P PROJ NO	FISCAL YEAR	SHEET NO	TOTAL SHEETS
8	OKLA	27092(04)		71	143

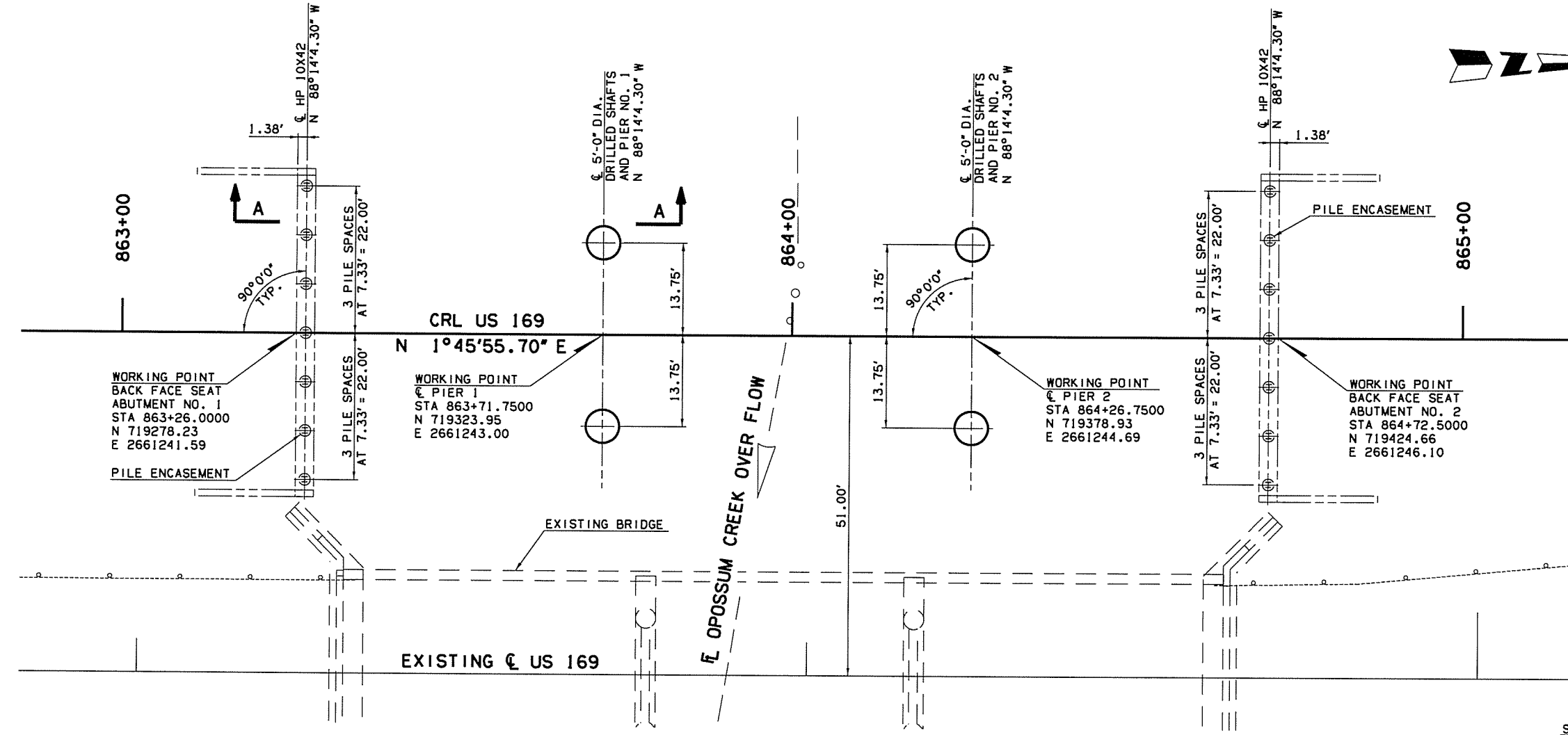

TOP OF PILE ELEVATIONS	
ABUTMENT NO. 1	705.69
ABUTMENT NO. 2	705.69

INDEX OF BRIDGE SHEETS

SHEET NO.	TITLE
68	GENERAL PLAN AND ELEVATION
69 - 70	FOUNDATION REPORT
71	STAKING DIAGRAM
72	TYPICAL SECTION
73 - 76	ABUTMENT DETAILS
77 - 78	PIER DETAILS
79 - 82	SUPERSTRUCTURE DETAILS
83	LONGITUDINAL SECTION
84 - 85	APPROACH SLAB DETAILS
86 - 91	7'x6' RCB DETAILS

STANDARDS
FSHP-42-2-00E
HPI-2-00E
B40-1-ABUT-MISC-01E
B40-1-BRG-RB-02E

SUMMARY OF QUANTITIES - BRIDGE B						
DESCRIPTION	UNIT	ABUTMENT	PIER	SUPERSTR.	APPROACH	TOTAL
SUBSTRUCTURE EXCAVATION COMMON	CY	90				90
CLSM BACKFILL	CY	128.0				128.0
APPROACH SLAB	SY				209.0	209.0
SAW-CUT GROOVING	SY			711.4	209.6	920.0
42" F-SHAPED PARAPET	LF			291.0	80.0	371.0
STRUCTURAL STEEL	LB			149170		149170
WEATHERING STEEL FIXED BEARING ASSEMBLY	EA			10		10
STAINLESS STEEL EXPANSION BEARING ASSEMBLY	EA			20		20
ELASTOMERIC BEARING PADS	EA			20		20
SPECIAL CONCRETE FINISH	SY		66			66
CLASS AA CONCRETE	CY			205.2		205.2
CLASS A CONCRETE	CY	51.4	95.6			147.0
REINFORCING STEEL	LB		1220			1220
EPOXY COATED REINFORCING STEEL	LB	9360	18220	67380		94960
CLASS C BRIDGE DECK REPAIR	SY					50
PILES, FURNISHED (HP10X42)	LF	406				406
PILES, DRIVEN (HP10X42)	LF	406				406
METAL PILE SHOES	EA	14				14
PILE SPLICE, H-PILE (NON-BIDDABLE)	EA	1				1
WATER REPELLENT (VISUALLY INSPECTED)	SY	50	92	394	72	608
DRILLED SHAFTS 60" DIAMETER	LF		107			107
CROSSHOLE SONIC LOGGING	EA		1			1
SEALER CRACK PREPARATION	LF			188		188
SEALER RESIN	GAL			1.3		1.3
TYPE 1-A PLAIN RIPRAP	TON	1250				1250
TYPE 1-A FILTER BLANKET	TON	200				200
FILTER FABRIC (RIPRAP)	SY	822				822
6" PERFORATED PIPE UNDERDRAIN ROUND	LF	100				100
6" NON-PERF. PIPE UNDERDRAIN RND.	LF	80				80
REMOVAL OF BRIDGE ITEMS	LSUM					1

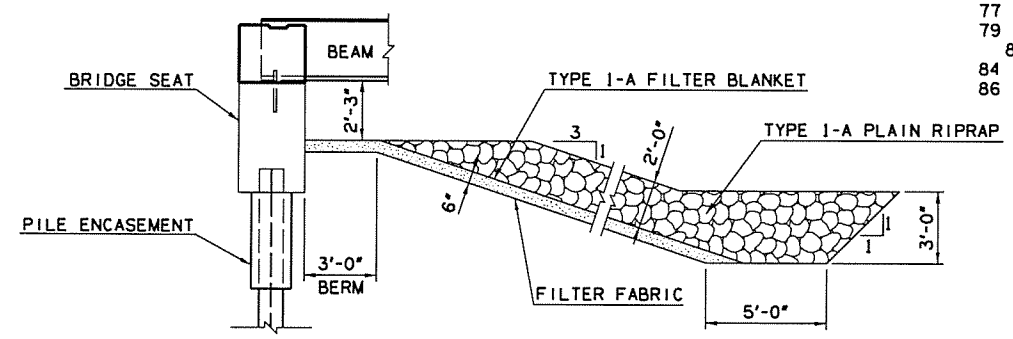

NOTES:

- ABUTMENT PILES SHALL BE ORIENTED SUCH THAT THE FACE OF THE PILE WEB IS PARALLEL WITH THE FACE OF THE BRIDGE SEAT.
- CONTRACTOR SHALL VERIFY LOCATION AND STATUS (I.E. "ABANDONED") OF ALL UTILITIES PRIOR TO BEGINNING EXCAVATION OR DRIVING PILES.
- HARD ROCK WAS ENCOUNTERED AT THIS SITE. EXCAVATION FOR THE FOUNDATIONS MAY REQUIRE SPECIALTY HEAVY-DUTY DRILLING EQUIPMENT. THE CONTRACTOR IS RESPONSIBLE FOR BEING FULLY AWARE OF THE FOUNDATION MATERIAL CONDITIONS AND THE DRILLING PROCESS PRIOR TO BEGINNING WORK.

Design	STF	6/16	US 169 OVER OPOSSUM CREEK OVER FLOW NOWATA COUNTY BRIDGE B
Drawn	RAH	6/16	
Checked	STF	6/16	
Approved	SAK	6/16	
Squad	BENHAM		

STAKING DIAGRAM

Job Piece No. 27092(04) Sheet No. 71