

| LOCAL DIVISION | STATE | J/P PROJ NO | FISCAL YEAR | SHEET NO | TOTAL SHEETS |
|----------------|-------|-------------|-------------|----------|--------------|
| 8 | OKLA | 27092(04) | | 53 | 143 |

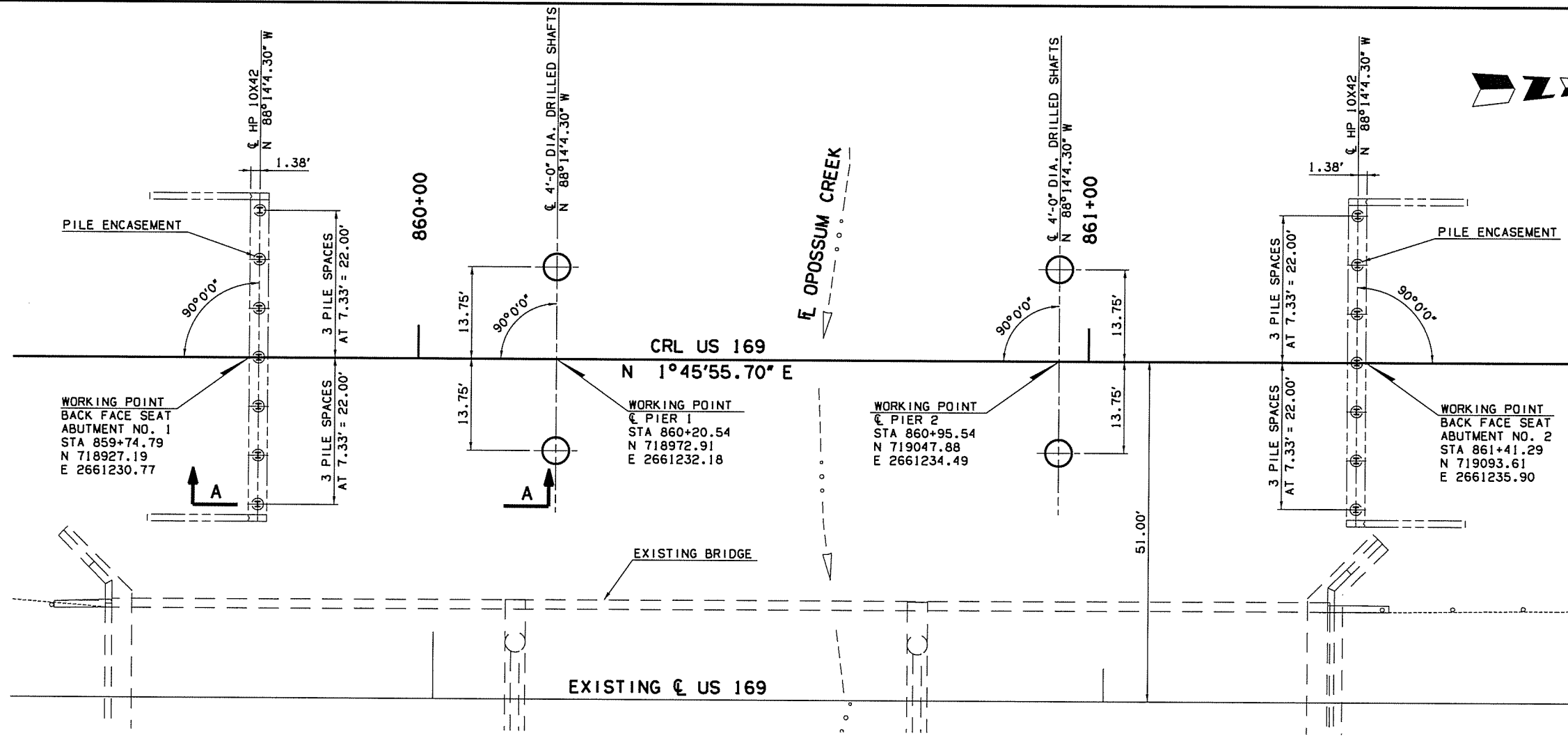

| TOP OF PILE ELEVATIONS | |
|------------------------|--------|
| ABUTMENT NO. 1 | 705.69 |
| ABUTMENT NO. 2 | 705.69 |

INDEX OF BRIDGE SHEETS

| SHEET NO. | TITLE |
|-----------|----------------------------|
| 50 | GENERAL PLAN AND ELEVATION |
| 51 - 52 | FOUNDATION REPORT |
| 53 | STAKING DIAGRAM |
| 54 | TYPICAL SECTION |
| 55 - 58 | ABUTMENT DETAILS |
| 59 - 60 | PIER DETAILS |
| 61 - 64 | SUPERSTRUCTURE DETAILS |
| 65 | LONGITUDINAL SECTION |
| 66 - 67 | APPROACH SLAB DETAILS |

STANDARDS
 FSHP-42-2-00E
 HPI-2-00E
 B40-1-ABUT-MISC-01E
 B40-1-BRG-RB-02E

| SUMMARY OF QUANTITIES - BRIDGE A | | | | | | |
|--|------|----------|-------|-----------|----------|--------|
| DESCRIPTION | UNIT | ABUTMENT | PIER | SUPERSTR. | APPROACH | TOTAL |
| SUBSTRUCTURE EXCAVATION COMMON | CY | 90 | | | | 90 |
| CLSM BACKFILL | CY | 128.0 | | | | 128.0 |
| APPROACH SLAB | SY | | | | 209.0 | 209.0 |
| SAW-CUT GROOVING | SY | | | 809.2 | 195.6 | 1004.8 |
| 42" F-SHAPED PARAPET | LF | | | 331.0 | 80.0 | 411.0 |
| STRUCTURAL STEEL | LB | | | 175440 | | 175440 |
| WEATHERING STEEL FIXED BEARING ASSEMBLY | EA | | | 10 | | 10 |
| STAINLESS STEEL EXPANSION BEARING ASSEMBLY | EA | | | 20 | | 20 |
| ELASTOMERIC BEARING PADS | EA | | | 20 | | 20 |
| SPECIAL CONCRETE FINISH | SY | | 77 | | | 77 |
| CLASS AA CONCRETE | CY | | | 229.6 | | 229.6 |
| CLASS A CONCRETE | CY | 51.4 | 78.6 | | | 130.0 |
| EPOXY COATED REINFORCING STEEL | LB | 9360 | 14480 | 76150 | | 99990 |
| CLASS C BRIDGE DECK REPAIR | SY | | | | | 50 |
| PILES, FURNISHED (HP10X42) | LF | 364 | | | | 364 |
| PILES, DRIVEN (HP10X42) | LF | 364 | | | | 364 |
| METAL PILE SHOES | EA | 14 | | | | 14 |
| PILE SPLICE, H-PILE (NON-BIDDABLE) | EA | 1 | | | | 1 |
| WATER REPELLENT (VISUALLY INSPECTED) | SY | | 92 | 440 | 72 | 654 |
| DRILLED SHAFTS 48" DIAMETER | LF | | 143 | | | 143 |
| CROSSHOLE SONIC LOGGING | EA | | 1 | | | 1 |
| SEALER CRACK PREPARATION | LF | | | 188 | | 188 |
| SEALER RESIN | GAL | | | 1.3 | | 1.3 |
| TYPE 1-A PLAIN RIPRAP | TON | 780 | | | | 780 |
| TYPE 1-A FILTER BLANKET | TON | 115 | | | | 115 |
| FILTER FABRIC (RIPRAP) | SY | 460 | | | | 460 |
| 6" PERFORATED PIPE UNDERDRAIN ROUND | LF | 100 | | | | 100 |
| 6" NON-PERF. PIPE UNDERDRAIN RND. | LF | 80 | | | | 80 |
| REMOVAL OF BRIDGE ITEMS | LSUM | | | | | 1 |

PLAN - BRIDGE A
 SCALE: 1" = 10'

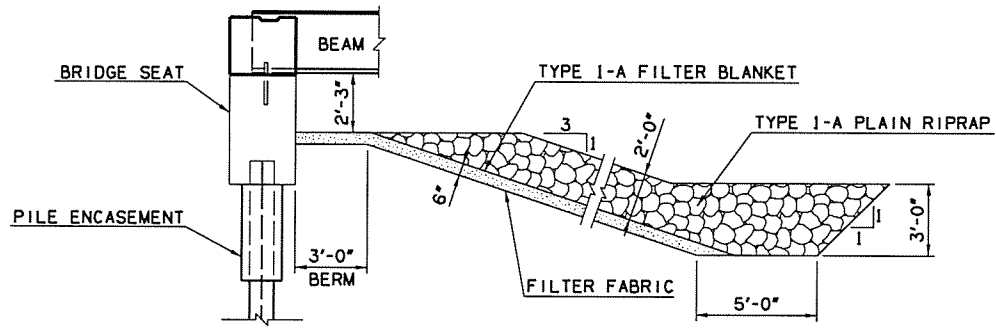

SECTION A-A
 SCALE: NONE

NOTE:

- ABUTMENT PILES SHALL BE ORIENTED SUCH THAT THE FACE OF THE PILE WEB IS PARALLEL WITH THE FACE OF THE BRIDGE SEAT.
- CONTRACTOR SHALL VERIFY LOCATION AND STATUS (I.E. "ABANDONED") OF ALL UTILITIES PRIOR TO BEGINNING EXCAVATION OR DRIVING PILES.
- HARD ROCK WAS ENCOUNTERED AT THIS SITE. EXCAVATION FOR THE FOUNDATIONS MAY REQUIRE SPECIALTY HEAVY-DUTY DRILLING EQUIPMENT. THE CONTRACTOR IS RESPONSIBLE FOR BEING FULLY AWARE OF THE FOUNDATION MATERIAL CONDITIONS AND THE DRILLING PROCESS PRIOR TO BEGINNING WORK.
- IF BEDROCK IS ENCOUNTERED AT A DEPTH SHALLOWER THAN ANTICIPATED, PILOT HOLES SHALL BE DRILLED FOR PILES SUCH THAT EACH PILE HAS A MINIMUM LENGTH OF 15 FEET.

| | | | | |
|----------|--------|------|---------------------------|---------------|
| Design | KSJ | 6/16 | US 169 OVER OPOSSUM CREEK | NOWATA COUNTY |
| Drawn | WZB | 6/16 | BRIDGE A | |
| Checked | MKR | 6/16 | | |
| Approved | SAK | 6/16 | | |
| Squad | BENHAM | | | |

STAKING DIAGRAM

Job Piece No. 27092(04) Sheet No. 53