

OKLAHOMA DEPARTMENT OF TRANSPORTATION					
ODOT DIVISION	STATE	JOB PIECE No.	FISCAL YEAR	SHEET No.	TOTAL SHEETS
8	OKLA	27092(04)		31	143
DESCRIPTION		REVISIONS	DATE		

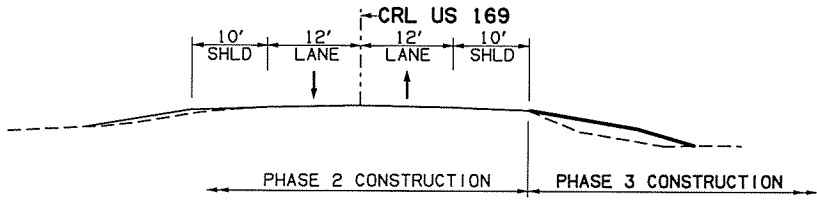

PHASE 3 TYPICAL SECTION
 STA. 838+99.66 TO STA. 852+00.00
 STA. 871+00.00 TO STA. 884+44.51
 N.T.S.

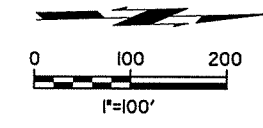
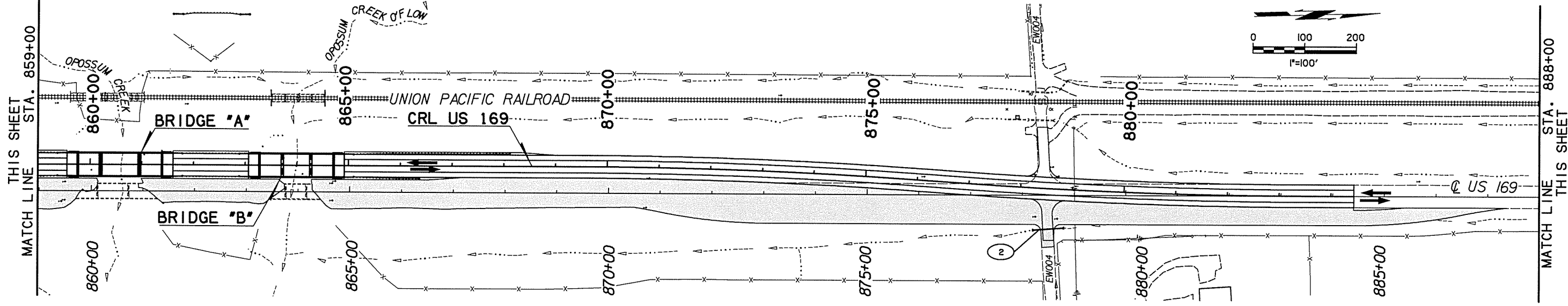
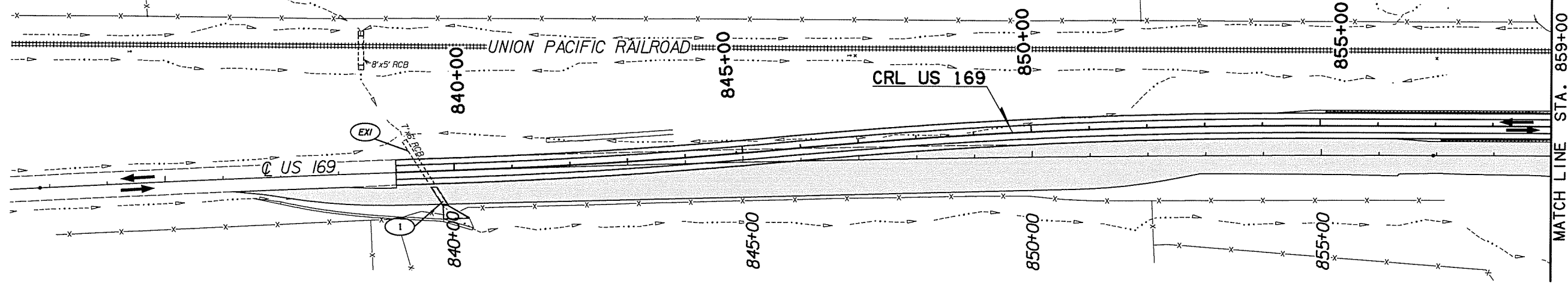
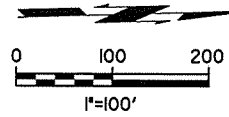
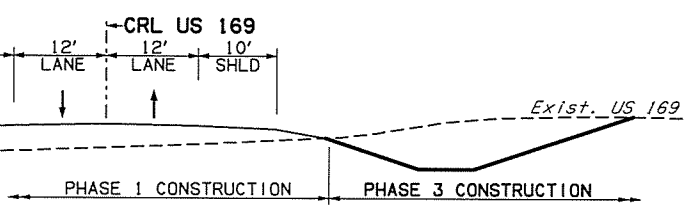
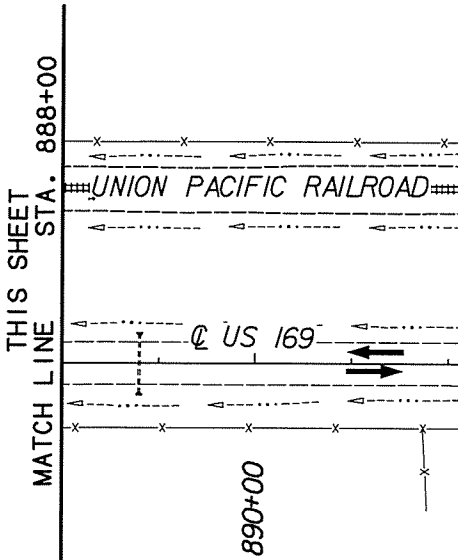

PHASE 3 TYPICAL SECTION
 STA. 852+00.00 TO STA. 871+00.00
 N.T.S.

PHASE 3		
ITEM	CONSTRUCTION	TRAFFIC
US 169	Sta. 838+99.66 to Sta. 884+44.51 east foreslope / ditch	On Proposed US 169
South Detour	Remove	
North Detour	Remove	
Bridge A	No construction	
Bridge B	No construction	

LEGEND

	CONSTRUCTION
	TEMPORARY CONSTRUCTION
	COMPLETED CONSTRUCTION
	COMPLETED TEMPORARY CONSTRUCTION

Design		US 169 OVER OPOSSUM CREEK	NOWATA COUNTY
Drawn		SUGGESTED CONSTRUCTION SEQUENCE PHASE 3	
Checked			
Approved			
Squad			
		Job Piece No. 27092(04)	Sheet No. 31