

OKLAHOMA DEPARTMENT OF TRANSPORTATION					
DDOT DIVISION	STATE	JOB PIECE No.	FISCAL YEAR	SHEET No.	TOTAL SHEETS
8	OKLA	27092(04)		29	143
DESCRIPTION		REVISIONS	DATE		

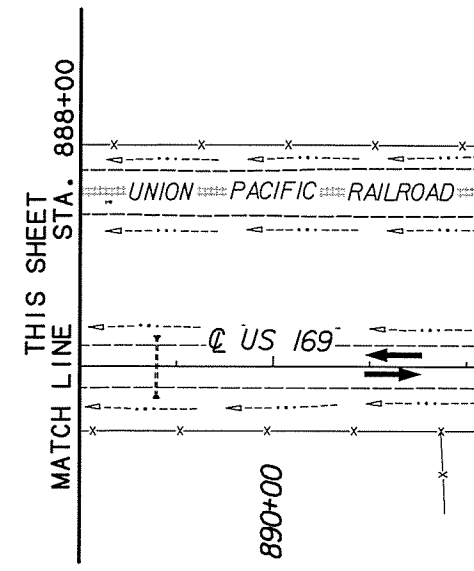
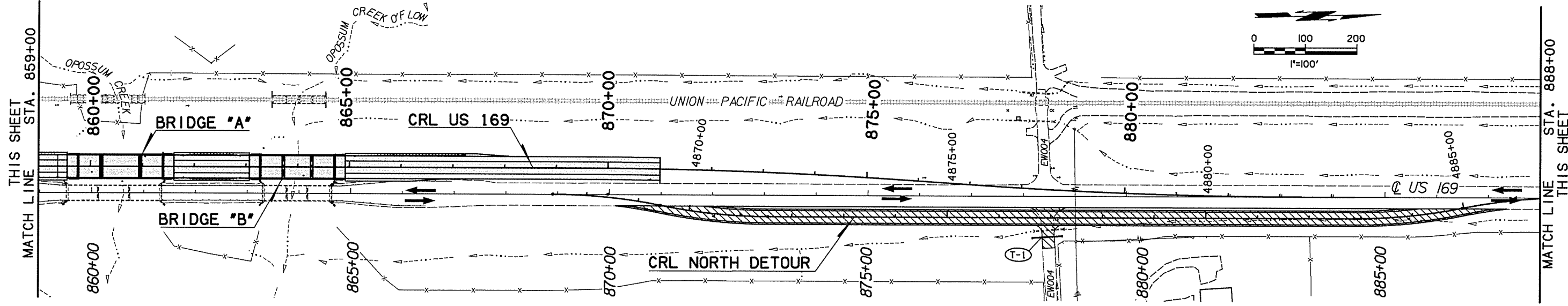
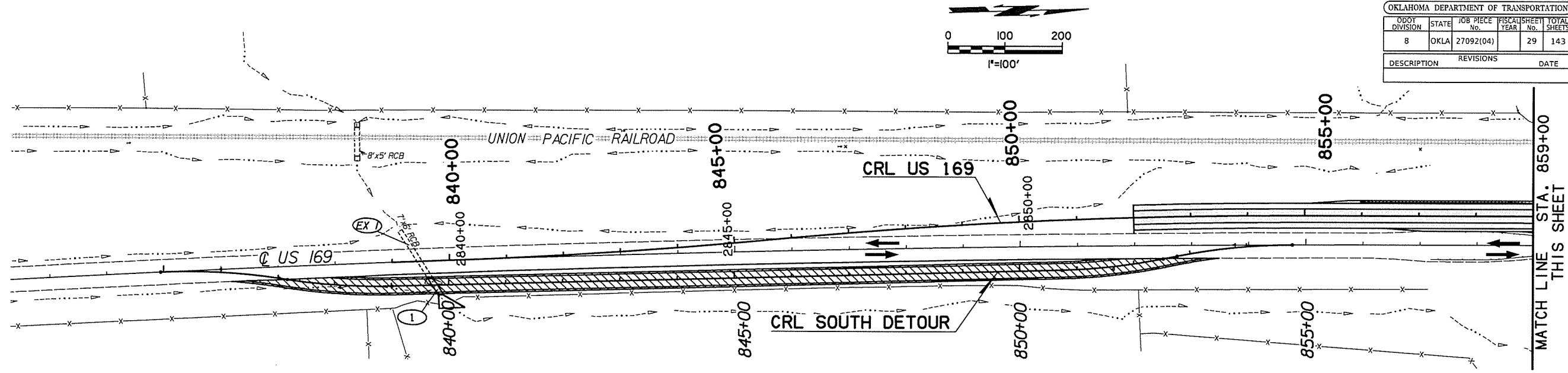

PHASE 1		
ITEM	CONSTRUCTION	TRAFFIC
US 169	Sta. 852+00 to Sta. 871+00 except east foreslope / ditch	On Existing US 169
South Detour	Construct	
North Detour	Construct	
Bridge A	Construct	
Bridge B	Construct	

LEGEND

- CONSTRUCTION
- TEMPORARY CONSTRUCTION
- COMPLETED CONSTRUCTION
- COMPLETED TEMPORARY CONSTRUCTION

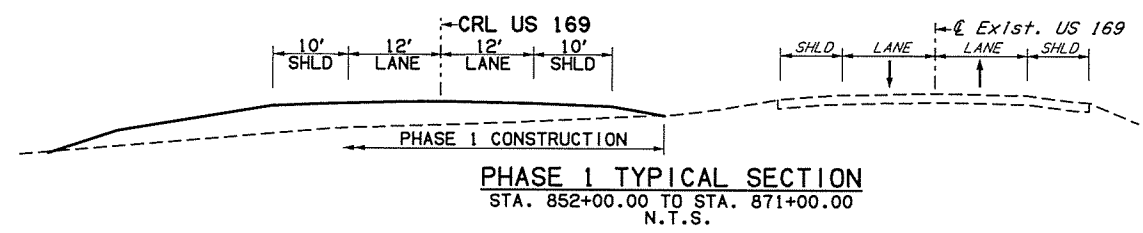

Design		US 169 OVER OPOSSUM CREEK	NOWATA COUNTY
Drawn		SUGGESTED CONSTRUCTION SEQUENCE PHASE 1	
Checked			
Approved			
Squad			
		Job Piece No. 27092(04)	Sheet No. 29