

OKLAHOMA DEPARTMENT OF TRANSPORTATION				
ODOT DIVISION	STATE	JOB PIECE No.	FISCAL YEAR	TOTAL SHEETS
8	OKLA	27092(04)	15	143
DESCRIPTION		REVISIONS	DATE	

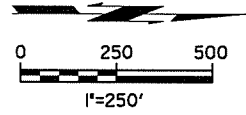

SEC. 36, T29N, R15E

SEC. 25, T29N, R15E

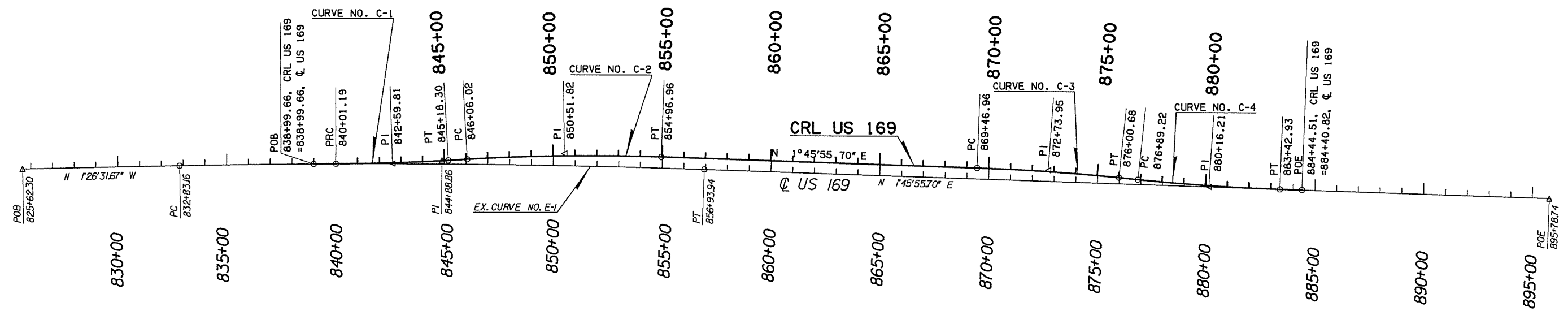

CRL US 169												
CURVE NO.	STATION	CARDINAL POINTS		DELTA	DEGREE	CURVE DATA				SUPER ELEVATION		
		NORTHING (FEET)	EASTING (FEET)			RADIUS (FEET)	TANGENT (FEET)	ARC LENGTH (FEET)	EXTERNAL (FEET)	V (MPH)	E (FT/FT)	S (FT/FT)
C-1	POB 838+99.66	716853.2404	2661255.2629									
	PRC 840+01.19	716954.8164	2661254.2801									
	PI 842+59.81	717213.4272	2661252.0829	3°06'55.79" LT	0°36'08.93"	9510.000	258.620	517.113	3.516	65	8%	-2.00%
	PT 845+18.30	717471.5364	2661235.8338									
C-2	PC 846+06.02	717559.0798	2661230.3226									
	PI 850+51.82	718003.9960	2661202.3131	5°22'03.86" RT	0°36'08.93"	9510.000	445.797	890.942	10.443	65	8%	2.00%
	PT 854+96.96	718449.5814	2661216.0474									
	PC 869+46.96	719898.8946	2661260.7197									
C-3	PI 872+73.95	720225.7253	2661270.7936	3°56'18.58" RT	0°36'08.93"	9510.000	326.986	653.714	5.620	65	8%	2.00%
	PT 876+00.68	720551.0923	2661303.2923									
	PC 876+89.22	720639.1960	2661312.0924									
	PI 880+16.21	720964.5630	2661344.5911	3°56'18.58" LT	0°36'08.93"	9510.000	326.986	653.714	5.620	65	8%	-2.00%
C-4	PT 883+42.93	721291.3938	2661354.6650									
	POE 884+44.51	721392.9224	2661357.7944									

C US 169												
CURVE NO.	STATION	CARDINAL POINTS		DELTA	DEGREE	CURVE DATA				SUPER ELEVATION		
		NORTHING (FEET)	EASTING (FEET)			RADIUS (FEET)	TANGENT (FEET)	ARC LENGTH (FEET)	EXTERNAL (FEET)	V (MPH)	E (FT/FT)	S (FT/FT)
E-1	POB 825+62.30	715516.2640	2661284.5079									
	PC 832+83.16	716236.8947	2661266.3659	3°12'27.37" LT	0°07'58.99"	43062.520	1205.704	2410.778	16.876	NA	NA	NA
E-1	PI 844+88.86	717442.2169	2661236.0216									
	PT 856+93.94	718647.3486	2661273.1675									
E-1	POE 895+78.74	722530.3045	2661392.8520									

Design		US 169 OVER OPOSSUM CREEK	NOWATA COUNTY
Drawn			
Checked			
Approved			
Squad			
		GEOMETRIC DATA (1)	
		Job Piece No. 27092(04)	Sheet No. 15