

PRINT DATE: 7/20/2016 T:\1420\Drawings\Bridges\1420-abut01.dgn

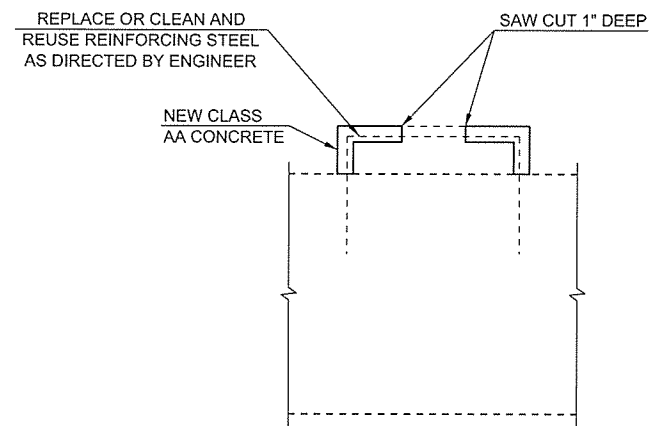

REPAIR BRIDGE ITEM (TYPE A)
(PEDESTAL)

NOTE
SPLICE EXISTING REINFORCING WITH NEW REINFORCING ACCORDING TO SECTION 511 OF THE STANDARD SPECIFICATIONS. SHOULD SECTION IS PRESENT.

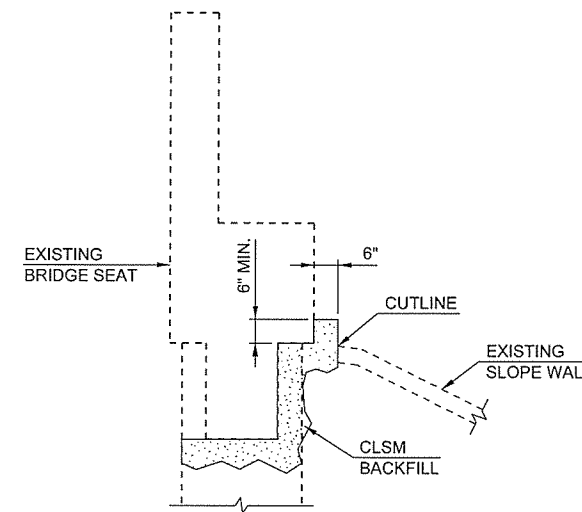

CLSM BACKFILL DETAIL

ABUTMENT MODIFICATION QUANTITIES - BRIDGE "A"		
DESCRIPTION	UNIT	TOTAL
CLSM BACKFILL	CY	5.00
SPECIAL CONCRETE FINISH	SY	91.00
CLASS C CONCRETE	CY	10.00
SLOPE WALL (4")	SY	120.00
PREPARATION OF CRACKS, ABOVE WATER	LF	20.00
EPOXY RESIN, ABOVE WATER	GAL	2.00
PNEUMATICALLY PLACED MORTAR	SY	15.00
(PL) REPAIR BRIDGE ITEM (TYPE A)	EA	5.00

ABUTMENT MODIFICATION QUANTITIES - BRIDGE "B"		
DESCRIPTION	UNIT	TOTAL
CLSM BACKFILL	CY	5.00
SPECIAL CONCRETE FINISH	SY	91.00
CLASS C CONCRETE	CY	10.00
SLOPE WALL (4")	SY	120.00
PREPARATION OF CRACKS, ABOVE WATER	LF	20.00
EPOXY RESIN, ABOVE WATER	GAL	2.00
PNEUMATICALLY PLACED MORTAR	SY	15.00
(PL) REPAIR BRIDGE ITEM (TYPE A)	EA	5.00

DESIGN	GDD		S.H. 74 OVER I-35 OKLAHOMA DEPARTMENT OF TRANSPORTATION ABUTMENT MODIFICATION DETAILS STATE JOB NO. 29572(04) SHEET NO. 12
DRAWN	EMH		
CHECKED	JTK		
APPROVED			
SQUAD	MacArthur		

McCLAIN CO.