

REV. NO.	DESCRIPTION	DATE

SHEET INDEX

SHEET NO.	TITLE
4	SUMMARY OF QUANTITIES AND GENERAL NOTES (BRIDGE)
30	GENERAL PLAN & ELEVATION
31	STRUCTURE PROFILE
32-35	BARREL DETAILS (4 SHEETS)
36-38	HEADWALL DETAILS (3 SHEETS)

DESIGN DATA

- DESIGNED IN ACCORDANCE WITH AASHTO LRFD BRIDGE DESIGN SPECIFICATIONS, 6TH EDITION.
- DESIGNED FOR HL-93 LOADING AND ODOT OVERLOAD TRUCK.
- MATERIALS:
 CONCRETE (CLASS AA) $f'_c = 4$ KSI
 REINFORCING STEEL $f_y = 60$ KSI

HYDRAULIC DATA

DRAINAGE AREA = 4.72 SQ. MI.
 CONTROLLED = 0.00 SQ. MI.
 EFFECTIVE = 4.72 SQ. MI.

Q2	797 C.F.S.	Q25	3866 C.F.S.
V2	3.55 F.P.S.	V25	7.60 F.P.S.
Q2 HIGHWATER	941.91	Q25 HIGHWATER	947.44
Q5	1642 C.F.S.	Q50	4819 C.F.S.
V5	4.97 F.P.S.	V50	8.54 F.P.S.
Q5 HIGHWATER	943.46	Q50 HIGHWATER	950.82
Q10	2476 C.F.S.	Q100	6011 C.F.S.
V10	6.08 F.P.S.	V100	9.95 F.P.S.
Q10 HIGHWATER	944.38	Q100 HIGHWATER	952.70
		Q68 ≈ Q0T	5334 C.F.S.
		V68	8.23 F.P.S.
		Q68 HIGHWATER	952.14

STANDARDS

- DESIGN NO.
 RCB-E3-H10-0-1
 RCB-E3-H10-0-2
 RCB-CW3-D8-0
 SBI-4

NOTE:
 1. FOR PROFILE OF STRUCTURE SEE SHT. 31.

SUMMARY OF QUANTITIES

CONSTRUCT TRPL.12'x10',18'x84.00' CLR. RDWY. RCB W/8' DROP					
ITEM	UNIT	INLET HEADWALL	OUTLET HEADWALL	BARREL	TOTAL QUANTITIES
UNCLASSIFIED EXCAVATION	C.Y.	---	---	---	8,510.0
STRUCTURAL EXCAVATION UNCLASSIFIED	C.Y.	---	---	---	452.0
CLASS AA CONCRETE	C.Y.	134.9	431.2	727.8	1,293.9
REINFORCING STEEL	LB.	19,290.0	51,860.0	94,410.0	165,560.0
REMOVAL OF EXISTING BRIDGE STRUCTURE	L.SUM	---	---	---	1.0

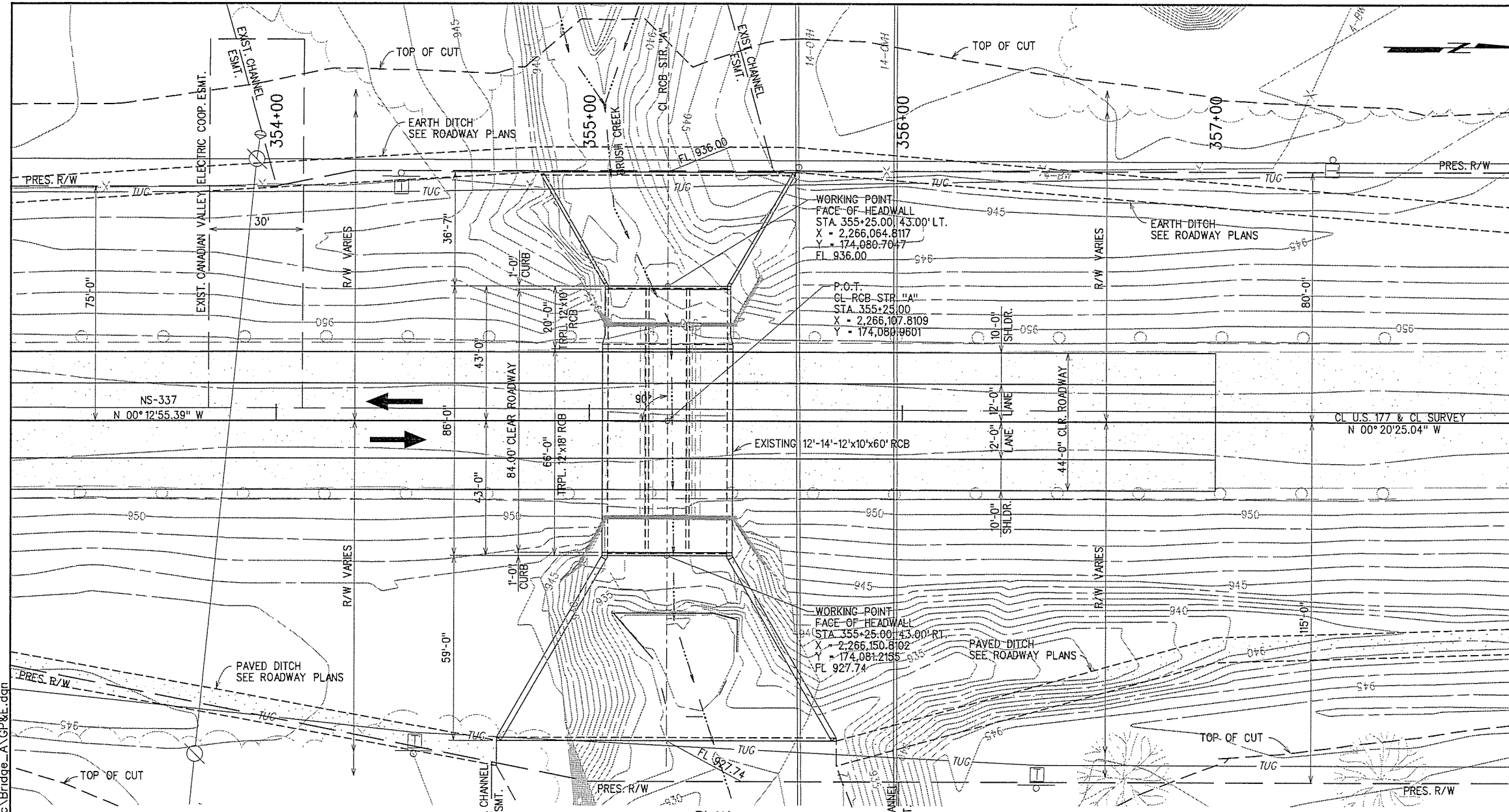

PLAN
 SCALE: 1"=20'-0"

B.M. #5 - #6 BAR, 30" LONG SET FLUSH
 STA. 360+70.803, 81' LT. EL. 946.373

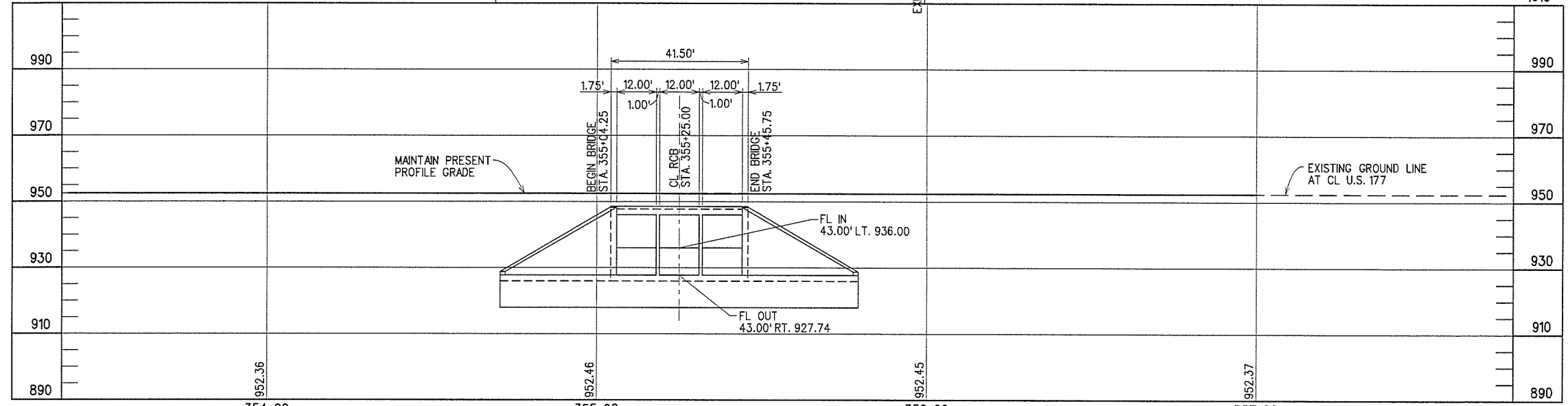

ELEVATION
 SCALE: 1"=20'-0"

DESIGN		U.S. 177 OVER BRUSH CREEK	LINCOLN COUNTY
DRAWN		BRIDGE "A"	
CHECKED		GENERAL PLAN AND ELEVATION	
APPROVED		CONSTRUCT TRPL.12'x10',18'x84.00' CLR. RDWY. RCB W/8' DROP	
		W/HEADWALL EACH END, NO SKEW CL STATION 355+25.00	
SQUAD	G/K ENGR.	JOB PIECE NO. 28941(04)	SHEET NO. 30

X:\0dot\EC-1394F-2\Struc\Bridge_A\GP&E.dgn 12/8/2015