

X:\0dot\EC-1394F-2\Civil\Erosion Control - Phase 3.dgn

12/8/2015

REV. NO.	DESCRIPTION	REVISIONS	DATE

SCALE:
1" = 40'

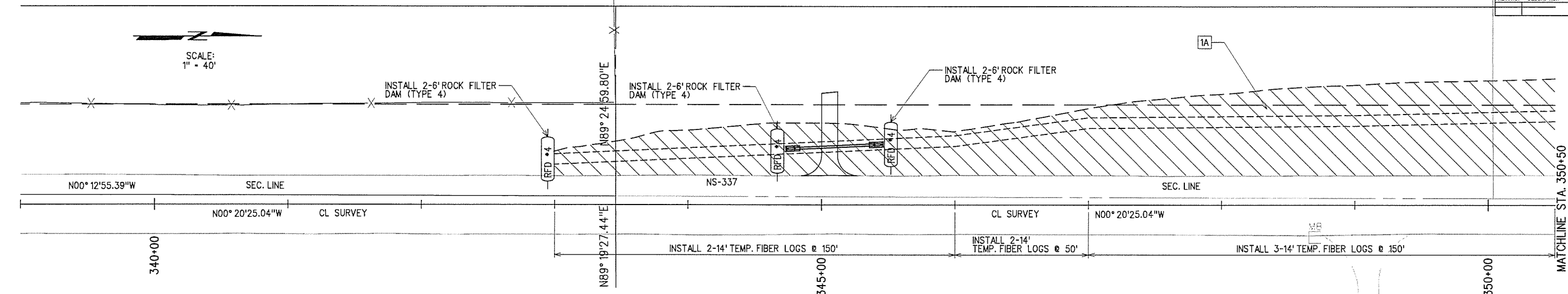

- ① INCLUDED IN THE PRICE BID FOR TEMPORARY EROSION CONTROL QUANTITIES SHALL BE THE COSTS FOR PERIODIC REMOVAL OF COLLECTED SEDIMENT AND THE RESTORATION OF ANY AREAS DAMAGED BY RAIN EVENTS AND/OR SEDIMENT.
- ② FIBER LOGS IN ACCORDANCE WITH THE STANDARD SPECIFICATIONS AND INSTALLED ACCORDING TO STD. TFL-1, MAY BE SUBSTITUTED FOR ANY OR ALL OF THE TEMPORARY SILT FENCE OR SILT DIKE UPON APPROVAL OF THE ENGINEER. FOR ESTIMATING PURPOSES, ONE THIRD OF THE SILT FENCE AND ONE THIRD OF THE SILT DIKE SHOWN ARE LISTED IN THE SUMMARIES AND THE PAY QUANTITIES AS FIBER LOG.

NOTE:
THIS SHEET IS PROVIDED FOR GENERAL EROSION CONTROL INFORMATION ONLY AND FOR THE ESTABLISHMENT OF BID PAY ITEMS. IT SHOULD BE CONSIDERED AS A GUIDE ONLY FOR THE PURPOSE OF SETTING UP SPECIFICS OF THE REQUIRED EROSION CONTROL. ALL EROSION CONTROL SHALL BE IN ACCORDANCE WITH ALL APPLICABLE STATE AND FEDERAL REGULATIONS AND ODOT STANDARDS AND SPECIFICATIONS AND BE APPROVED, IN ADVANCE, BY THE ENGINEER.

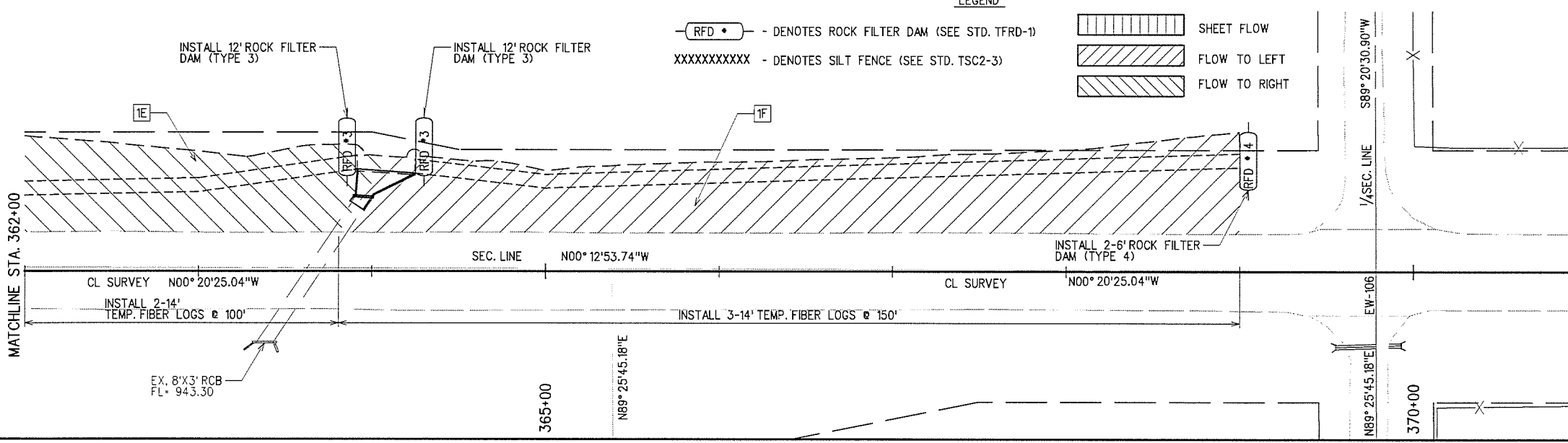
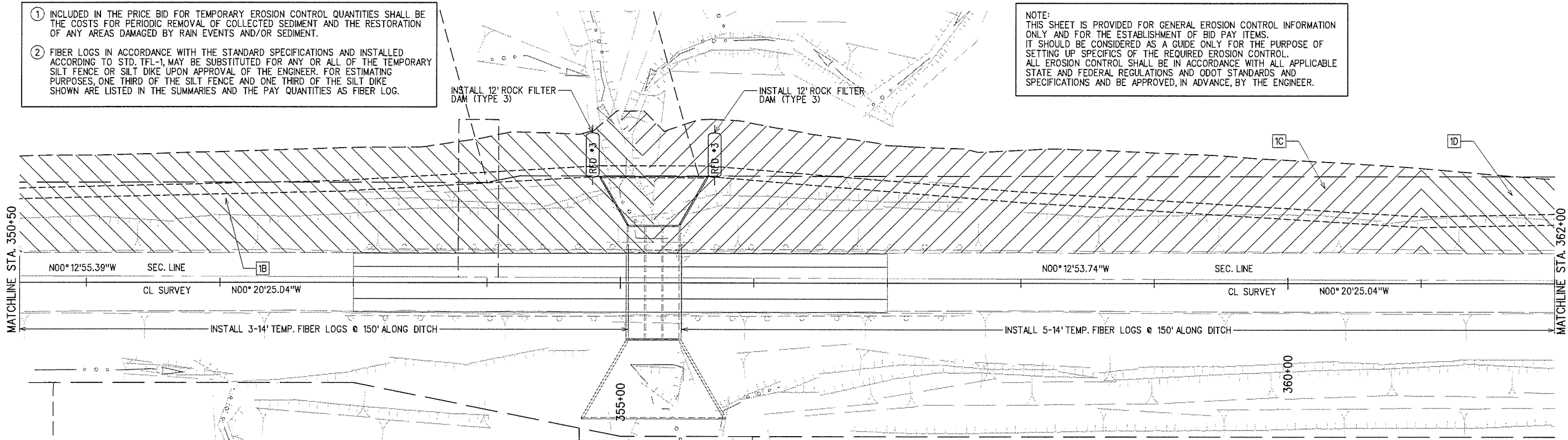

- LEGEND
- (RFD •) - DENOTES ROCK FILTER DAM (SEE STD. TFRD-1)
 - XXXXXXXXXX - DENOTES SILT FENCE (SEE STD. TSC2-3)
 - [Hatched Box] SHEET FLOW
 - [Diagonal Hatched Box] FLOW TO LEFT
 - [Diagonal Hatched Box] FLOW TO RIGHT

EROSION CONTROL QUANTITIES -- THIS SHEET ①		
ITEM	UNIT	AMOUNT
TEMPORARY FIBER LOG ②	L.F.	280
ROCK FILTER DAM (TYPE 3)	C.Y.	12.6
ROCK FILTER DAM (TYPE 4)	C.Y.	5.6

SUMMARY OF DISTURBED AREA - PHASE 3				
AREA	APPROX. LOCATION (CL SURVEY)	OUTFALL	AREA (ACRES)	DRAINAGE TREATMENT
1A	343+00 TO 350+50	BRUSH CREEK	0.85	STANDARD BMP
1B	350+50 TO 355+11	BRUSH CREEK	0.87	STANDARD BMP
1C	355+11 TO 361+00	BRUSH CREEK	1.06	STANDARD BMP
1D	361+00 TO 362+00	BRUSH CREEK	0.14	STANDARD BMP
1E	362+00 TO 364+00	BRUSH CREEK	0.22	STANDARD BMP
1F	364+00 TO 367+34	BRUSH CREEK	0.51	STANDARD BMP
TOTAL:			3.65	ACRES

DESIGN	
DRAWN	
CHECKED	
APPROVED	
SQUAD	G/K ENGR.

EROSION CONTROL DETAILS

JOB PIECE NO. 28941(04) SHEET NO. 12

PHASE 3