

7/8/2016 12:12:57 PM H:\KCC\TRANSPORTATION\HIGHWAY\PRODUCTION\0001\10019.04 - WEATHERFORD - I-40 RAMP PHASE 2\PROJECT DRAWINGS\GENERAL\SIDEWALK LAYOUT.DWG

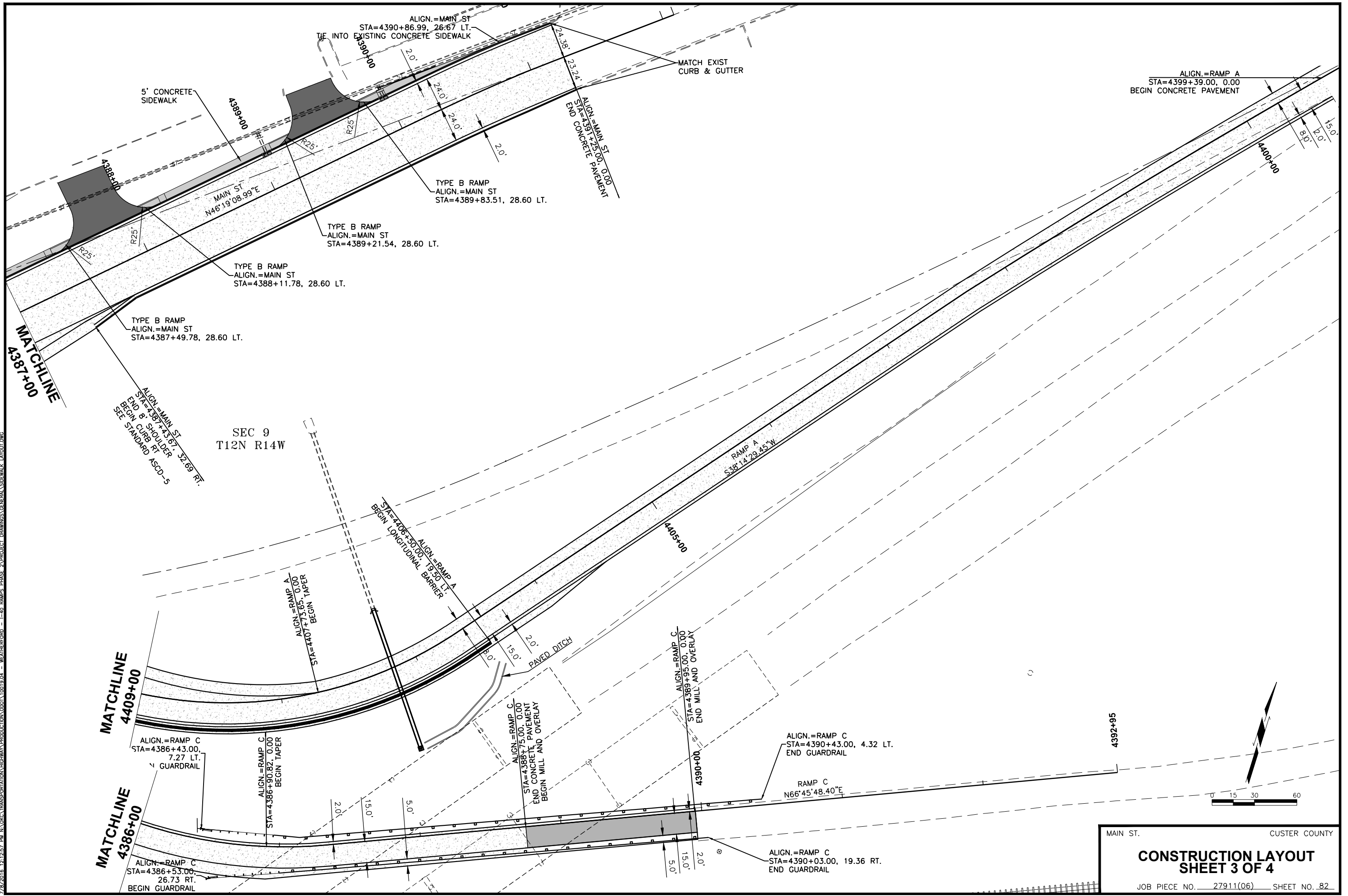

ALIGN.=RAMP A  
STA=4399+39.00, 0.00  
BEGIN CONCRETE PAVEMENT

5' CONCRETE SIDEWALK

MAIN ST  
N46°19'08.99"E

TYPE B RAMP  
ALIGN.=MAIN ST  
STA=4389+83.51, 28.60 LT.

TYPE B RAMP  
ALIGN.=MAIN ST  
STA=4389+21.54, 28.60 LT.

TYPE B RAMP  
ALIGN.=MAIN ST  
STA=4388+11.78, 28.60 LT.

TYPE B RAMP  
ALIGN.=MAIN ST  
STA=4387+49.78, 28.60 LT.

ALIGN.=MAIN ST  
STA=4387+43.67, 32.69 RT.  
END B SHOULDER  
BEGIN CURB RT  
SEE STANDARD ASCD-5

SEC 9  
T12N R14W

ALIGN.=RAMP A  
STA=4407+75.65, 0.00  
BEGIN TAPER

PAVED DITCH

ALIGN.=RAMP C  
STA=4389+95.00, 0.00  
END MILL AND OVERLAY

ALIGN.=RAMP C  
STA=4390+43.00, 4.32 LT.  
END GUARDRAIL

RAMP C  
N66°45'48.40"E

ALIGN.=RAMP C  
STA=4390+03.00, 19.36 RT.  
END GUARDRAIL

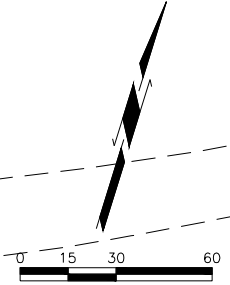

MAIN ST. CUSTER COUNTY

### CONSTRUCTION LAYOUT SHEET 3 OF 4

JOB PIECE NO. 27911(06) SHEET NO. 82