

TABLE 1 - SIGNAL HEADS				
SIGNAL HEAD NUMBER	NUMBER & TYPE	MOUNTING	VISOR	BACKPLATE
1,2,3,4	ONE WAY (S-6)	MAST ARM	V-1	B-2
5,6	ONE WAY (S-9)	MAST ARM	V-1	B-2

TABLE 2 - MAST ARMS & POLES			
LOCATION	MTG. HT.	MAST ARM LENGTHS	FOUNDATION
A	32'	50' & 35' W/10' LUM. ARM	S-55
B	32'	25' W/10' LUM. ARM	S-25

TABLE 3 - CABLE			
ELECTRICAL CABLE TO CONTROLLER "A" LOCATION			
A-18C	B-9C		

NOTES:

1. THE CONTRACTOR SHALL CONTACT THE CITY AND UTILITY COMPANIES FOR POSSIBLE UNDERGROUND EXISTING UTILITIES NOT SHOWN ON THE PLANS. THIS SHOULD BE DONE BEFORE TRENCHING OR INSTALLING ELECTRICAL CONDUITS.
2. ALL STATIONING IS ALONG MAIN STREET ALIGNMENT.
3. THE STRIPING SHOWN ON THIS SHEET IS FOR INFORMATIONAL PURPOSES ONLY. THE CONTRACTOR SHALL FOLLOW THE STRIPING PLANS FOR ALL PROPOSED MARKINGS.
4. VIDEO VEHICLE DETECTION WILL BE PROVIDED FOR THIS INTERSECTION. THE DETECTOR LOOPS SHOWN ON THE ROADWAY ARE SHOWN ONLY TO DEPICT THE AREAS OF DETECTION FOR THE VIDEO DETECTION UNITS ALONG WITH THE PHASES THAT EACH VIDEO DETECTOR UNIT WITH CALL.

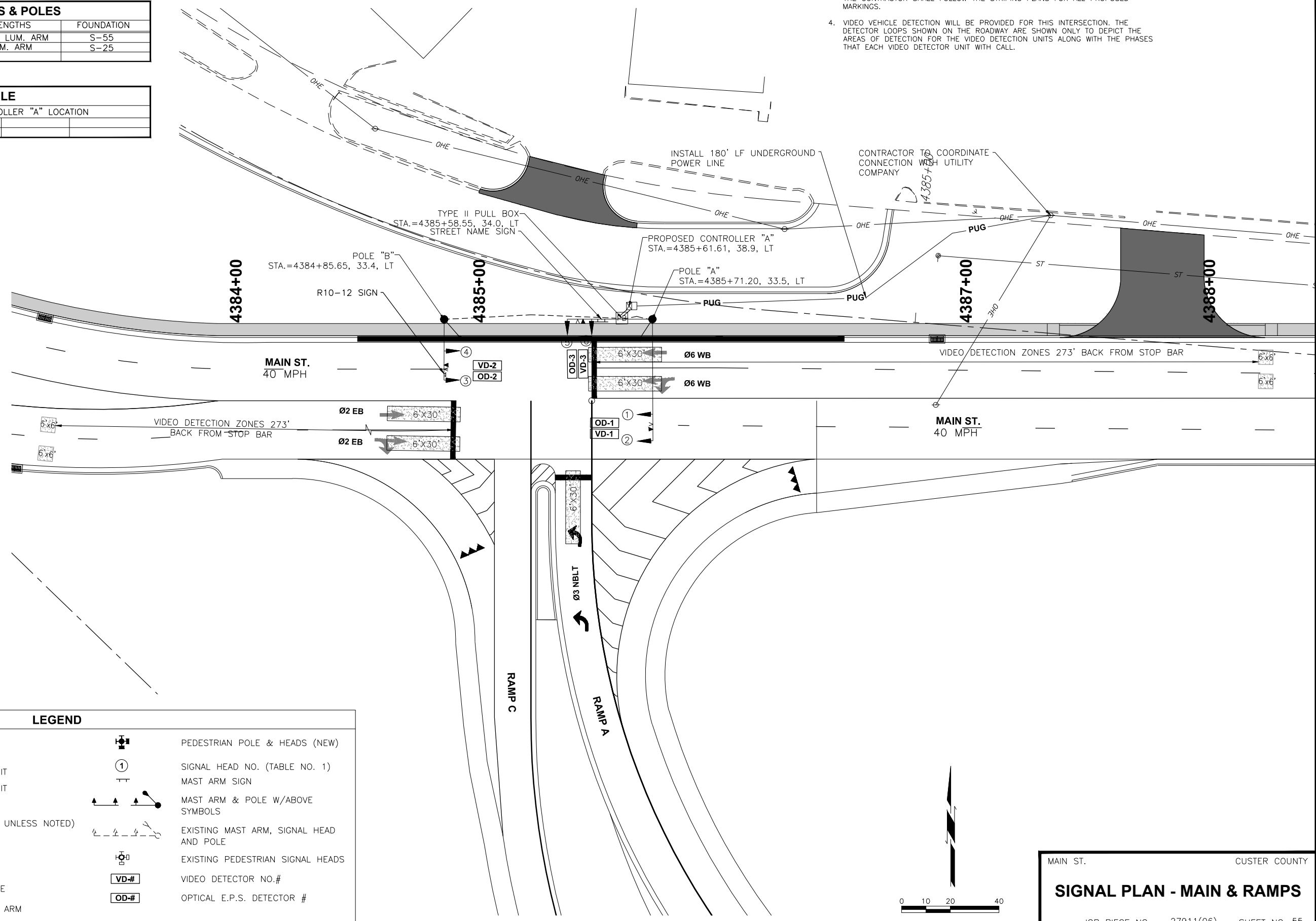

LEGEND	
>	E.P.S. DETECTOR
▶	VIDEO DETECTION
---	2" ELECTRICAL CONDUIT
- - -	3" ELECTRICAL CONDUIT
▲	SIGNAL HEAD (NEW)
PB	PULL BOX (SIZE 1 - UNLESS NOTED)
PB	EXISTING PULL BOX
⊠	CONTROLLER
6'x30'	VIDEO DETECTION ZONE
⊕	LUMINAIRE WITH MAST ARM
⊕	PEDESTRIAN POLE & HEADS (NEW)
①	SIGNAL HEAD NO. (TABLE NO. 1)
⊕	MAST ARM SIGN
▲	MAST ARM & POLE W/ABOVE SYMBOLS
⊕	EXISTING MAST ARM, SIGNAL HEAD AND POLE
⊕	EXISTING PEDESTRIAN SIGNAL HEADS
VD-#	VIDEO DETECTOR NO.#
OD-#	OPTICAL E.P.S. DETECTOR #

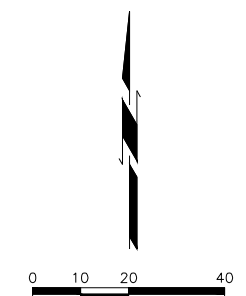

MAIN ST. CUSTER COUNTY
SIGNAL PLAN - MAIN & RAMPS
 JOB PIECE NO. 27911(06) SHEET NO. 55

7/28/2016 12:06:29 PM N:\CIVIL\TRANSPORTATION\HIGHWAY\PRODUCTION\0001\10019104 - WEATHERFORD - I-40 RAMP - PHASE 2\PROJECT DRAWINGS\SCHEMA SIGNAL PLANS.DWG