

7/28/2016 12:03:13 PM N:\CIVIL\TRANSPORTATION\HIGHWAY\PRODUCTION\0001\10019_04 - WEATHERFORD - L-40_RAMP5 PHASE 2\PROJECT DRAWINGS\SIGNING & STRIPING\FRONTAGE ROAD SIGNING & STRIPING.DWG

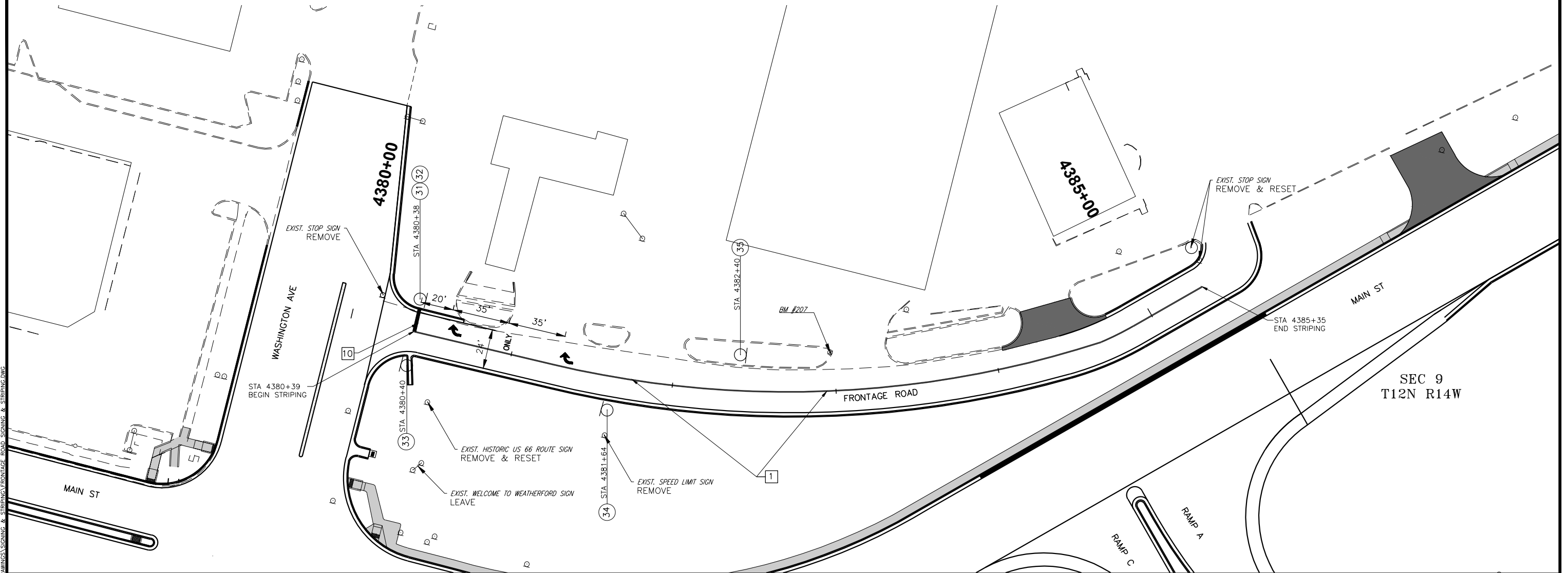

SEC 9
T12N R14W

LEGEND

- 1 4" SOLID DOUBLE YELLOW BARRIER LINE (PLASTIC)
- 2 4" SOLID WHITE LINE (PLASTIC)
- 3 4" DASHED WHITE LANE LINE (PLASTIC)
- 4 4" DASHED YELLOW LANE LINE (PLASTIC)
- 5 4" SOLID YELLOW BARRIER LINE (PLASTIC)
- 6 6" SOLID WHITE LINE (PLASTIC)
- 7 6" SOLID YELLOW EDGE LINE (PLASTIC)
- 8 8" SOLID YELLOW LINE (PLASTIC)
- 9 8" SOLID WHITE LINE (PLASTIC)
- 10 24" SOLID WHITE LINE (PLASTIC)
- 11 DOTTED WHITE LANE LINE (PLASTIC)
- XX PROPOSED SIGN

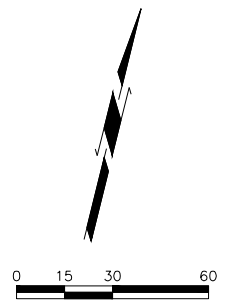
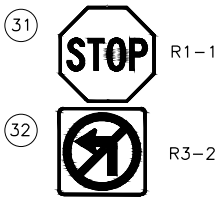

MAIN ST. CUSTER COUNTY

**SIGNING AND STRIPING
SHEET 9 OF 10**

JOB PIECE NO. 27911(06) SHEET NO. 51