

Sub: June 8, 2016

OKLAHOMA DEPARTMENT OF TRANSPORTATION					
FED. ROAD DIST. NO.	STATE	JOB PAGE NO.	FISCAL YEAR	SHEET NO.	TOTAL SHEETS
6	OKLA.	28858(04)			
DESCRIPTION	REVISION	DATE			

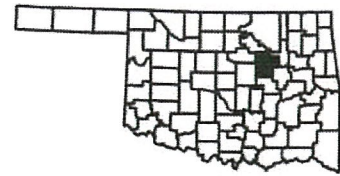

LOCATION MAP

FOR SURVEY CONTROL DATA, SEE SURVEY DATA SHEETS

STATE OF OKLAHOMA  
DEPARTMENT OF TRANSPORTATION

PLAN OF PROPOSED  
STATE HIGHWAY  
FEDERAL AID PROJECT NO. ACSTP-219C(050)SS  
BRIDGE AND APPROACHES  
STATE HIGHWAY 16  
CREEK COUNTY

CONTROL SECTION NO. 16-19-10

STATE JOB NO. 28858(04)

BRIDGE "A" LOCATION NO. 1910 0812 X

EXISTING NBIS NO. 12390 ; NEW NBI NO. 31001

BRIDGE "B" LOCATION NO. 1910 0837 X

EXISTING NBIS NO. 04353 ; NEW NBI NO. 31002

INDEX OF SHEETS

1	TITLE SHEET
2-3	TYPICAL SECTIONS
4	GENERAL NOTES/SUMMARY OF PAY QUANTITIES (ROADWAY)
5	GENERAL NOTES/SUMMARY OF PAY QUANTITIES (BRIDGE)
6	GENERAL NOTES/SUMMARY OF PAY QUANTITIES (TRAFFIC)
7	SUMMARY SHEET (ROADWAY)
8	SUMMARY SHEET (TRAFFIC)
9	SUMMARY SHEET (DRAINAGE)
10	DRAINAGE AREA MAP
11-13	SUGGESTED CONSTRUCTION SEQUENCE OVERVIEW
14-22	SUGGESTED CONSTRUCTION SEQUENCE AND TRAFFIC CONTROL
23	STORMWATER MANAGEMENT PLAN
24-32	EROSION CONTROL PLAN
33	GEOMETRIC LAYOUT
34-39	PLAN & PROFILE SHEETS
40-45	DETOUR P&P SHEETS
46	BRIDGE A GENERAL PLAN & ELEVATION
47	BRIDGE B GENERAL PLAN & ELEVATION
48-51	BRIDGE A RIGHT END SECTION DETAILS
52	MASS HAUL DIAGRAMS
SI-S16	SURVEY DATA SHEETS
XI-X43	CROSS SECTIONS

THE FOLLOWING ODOT STANDARDS WILL BE REQUIRED ON THIS PROJECT:

ROADWAY	TRAFFIC	BRIDGE
SSS-1-1	PM3-I-2	TCS5-I-0
TSC2-3-2	DUI-I-0	TCS6-I-2
TSD-2-0	DU2-I-0	TCS7-I-2
ASCD-5-2	RSDI-I-0	TCS8-I-0
PSE-1-0	WSDI-I-0	TCS9-I-1
CET6S-3-2	SBSI-I-0	TCS10-I-0
CET6D-3-2	SBS2-I-0	TCS11-I-1
PCES-4-1	SBS3-I-0	TCS13-I-0
SPI-4-1	SBS5-I-0	TCS14-I-0
SPB-1-4	GMSI-I-0	TCS16-I-0
FHTMPP-1-0	SSPI-I-2	TCS20-I-0
FHTCP-3-1	SSAI-I-0	TCS21-I-2
SBI-4-2	RSI-I-0	TCS22-I-0
CLB-1-2	TCSI-I-1	TCS23-I-0
M1-3-0	TCS2-I-0	TCS24-I-2
RD1-3-1	TCS3-I-1	TCS25-I-0
DC-3-2	TCS4-I-1	
PDT-1-3		
RWF2-2-1		
SUEL1-3-2		
SUEL4-3-2		
RCB-C1-3&4&5(2-20)-01E		
RCB-E1-H3-0-1-01E		
RCB-E1-H3-0-2-01E		

DESIGN DATA

ADT 2013	= 1,800
ADT 2033	= 2,600
DHV (2-WAY)	= 286
K (DHV/ADT)	= 11%
D	= 57%
T (% DHV)	= 15%
T (% ADT)	= 17%
T (% ADT)	= 10%
V	= 70MPH
20yr FLEX ESALS	= 4.00M

SCALES

PLAN	1" = 100'
PROFILE HOR	1" = 100'
VER	1" = 10'
LAYOUT MAP	1" = 5,280'

CONVENTIONAL SYMBOLS

	PROPOSED ROAD
	RAILROADS
	RANGE & TOWNSHIP
	SECTION LINES
	QUARTER SECTION LINES
	FENCES
	GROUND LINE
	EXISTING ROADS
	BASE LINE
	GRADE LINES
	TELEPHONE & TELEGRAPH
	POWER LINES
	BUILDINGS
	OILWELL
	DRAINAGE STRUCTURES - IN PLACE
	DRAINAGE STRUCTURES - NEW
	RIGHT-OF-WAY LINES - EXISTING
	RIGHT-OF-WAY LINES - NEW
	CONTROLLED ACCESS
	RIGHT-OF-WAY FENCE

BR "B"	STA 136+97.20	BR LENGTH = 40.61
	STA 136+56.59	
BR "A"	STA 124+86.50	BR LENGTH = 23.00'
	STA 124+63.50	

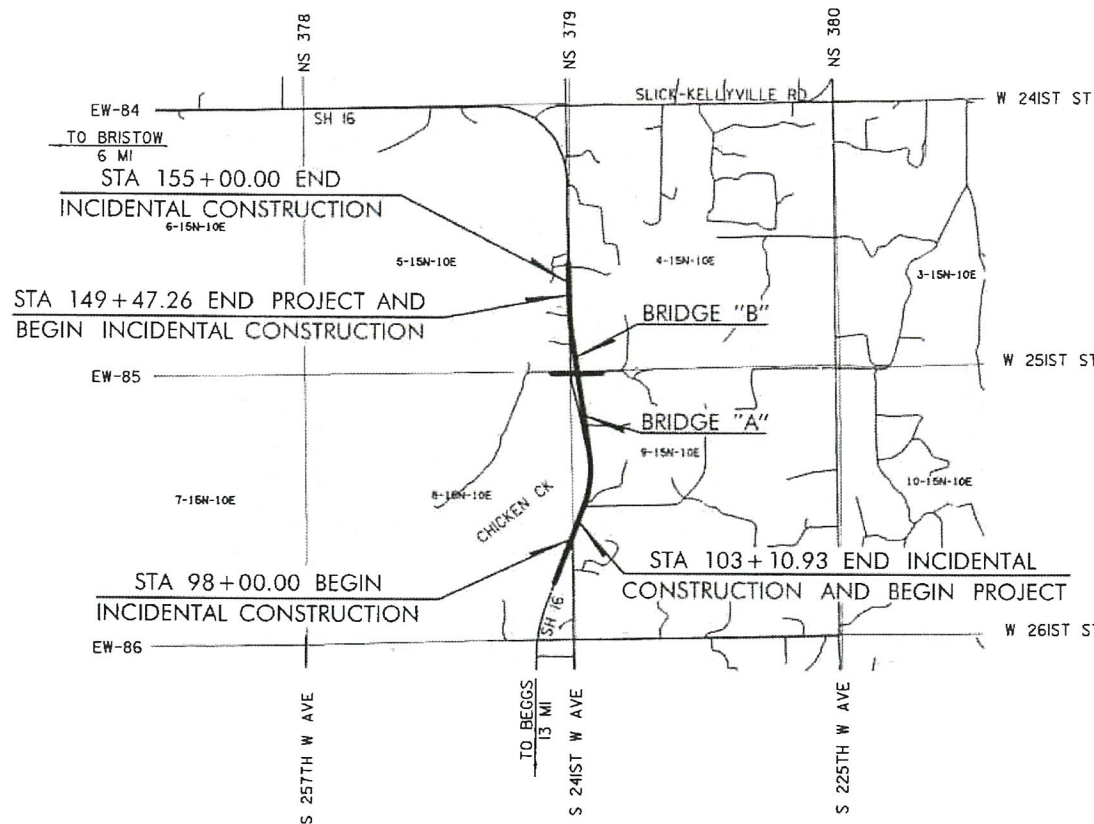

ROADWAY LENGTH ----- 4,572.72 FT. 0.866 MI.  
BRIDGE LENGTH ----- 63.61 FT. 0.012 MI.  
PROJECT LENGTH ----- 0.878 MI.

EQUATIONS : NONE  
EXCEPTIONS : NONE

2009 OKLAHOMA STANDARD SPECIFICATIONS FOR HIGHWAY CONSTRUCTION-ENGLISH GOVERN, APPROVED BY THE U.S. DEPARTMENT OF TRANSPORTATION, FEDERAL HIGHWAY ADMINISTRATION, JANUARY 4, 2010.

PREPARED BY:  
**SCHEMMER**  
ARCHITECTS | ENGINEERS | PLANNERS

4516 NW 36TH STREET,  
SUITE 101  
OKLAHOMA CITY, OK 73122  
405-259-2000

TODD A. COCHRAN, P.E.  
OKLA. REG. NO. 24856  
RESPONSIBLE FOR SHEETS: 1-4, 6-45, 52, XI-X43

STEPHEN D. KATHOL, P.E.  
OKLA. REG. NO. 24623  
RESPONSIBLE FOR SHEETS: 5, 46-51

CERTIFICATE OF AUTHORIZATION NO. 5964 P.E. RENEWAL DATE: 6-30-2017

OKLAHOMA DEPARTMENT OF TRANSPORTATION	DEPARTMENT OF TRANSPORTATION FEDERAL HIGHWAY ADMINISTRATION
DATE APPROVED	DATE APPROVED
BY	BY
CHIEF ENGINEER	DIVISION ADMINISTRATOR
SWO 4848(1) PROJECT NO. ACSTP-219C(050)SS	SHEET NO. 1

P.E. NO. : 28858(01)

6/7/2016

CREEK COUNTY SH-16