

STATE OF OKLAHOMA
DEPARTMENT OF TRANSPORTATION

SURVEY OF
U.S. 75A

BRIDGE OVER S.L. & S.F. RAILROAD AT THE NORTH EDGE OF
MOUNDS, 1.9 MILES NORTH OF THE OKMULGEE COUNTY LINE

SWO 4732(1)
STATE JOB NO. 27075(04)

CREEK COUNTY

FILE NO.	STATE	PROJ. NO.	YEAR	SHEET NO.	TOTAL SHEETS
DESCRIPTION		REVISION		DATE	

STATE OF OKLAHOMA
DEPARTMENT OF TRANSPORTATION
SURVEY DIVISION

SWO 4732(1) J/P 27075(04) ; E.C. 1385 CREEK CO.

HORIZONTAL CONTROL:
 Oklahoma Coordinate System of 1927 Zone.
 Oklahoma Coordinate System of 1983 (1983) North Zone.
 Oklahoma Dept. of Transportation Plane Coordinate System of 1927 Zone.
 Oklahoma Dept. of Transportation Plane Coordinate System of 1983 Zone.
 Arbitrary Coordinate System

HORIZONTAL PLANE DATUM DEFINITION:
 Oklahoma Department of Transportation coordinates were derived by multiplying the Oklahoma Coordinate Systems of 1927 or 1983 by the combined adjustment factor of 1.00010. The ODOT Coordinate System is 2350 feet above sea level.

1. Primary Control adjusted to OBTAINED BY OPUS SOLUTIONS (B) Order
 Stations _____
 A) Closure before adjustment X _____; Y _____ Angles _____
 Trav. Length _____ No. Angles _____
 B) _____; is _____ () Order before adjustment.
 C) Method of Distance Measurement:
 Electronic (X) GPS () Triangulation () Chained

2. Secondary Control adjusted to Primary Control (B) Order
 Stations C-19-836, C-19-837
 A) Closure before adjustment X _____; Y _____ Angles _____
 B) Secondary Control; is _____ (3rd) Order; Tied to _____
 C) Method of Distance Measurement:
 Electronic (X) GPS () Triangulation () Chained
 D) Instrument used for angles Topcon Hiper II GPS Total Station

VERTICAL CONTROL IS (3rd) order. Level Line taken from 3" ALUMINUM CAP C-19-836
 (3rd) order and tied to OBTAINED BY OPUS SOLUTIONS (3rd) order.
 VERTICAL CLOSURE = 0.04 feet before adjustment. 3rd order would allow 0.05 feet.

ACCURACY DEFINITION:
 (1) HORIZONTAL: (3rd Order = Class I = 1:10,000')
 (2nd Order = Class II = 1:5,000')
 (1st Order = 0.017 FT. x sqrt. of ML.)
 (3rd Order = 0.050 FT. x sqrt. of ML.)
 (2) VERTICAL: (2nd Order = 0.035 FT. x sqrt. of ML.)
 NGVD 29 datum
 NAVD 88 datum

Distribution:
 Copy survey reports _____
 Copy in each Alignment _____
 and level book _____

DARREN M. SMITH
 Professional Land Surveyor

June 11, 2012
 Date

(FORM SD #20)
 Rev. 11/03

SDS 1.	TITLE SHEET	INDEX OF SHEETS
SDS 2.	HISTORICAL LETTER & ALIGNMENT CERTIFICATION	
SDS 3.	LEVELS & COGO POINTS	
SDS 4.	CONTROL MAP & INFO.	
SDS 5-6.	SURVEY DATA SHEETS	SURVEY BEGAN: JANUARY 16, 2012
SDS 7.	LAND TIE SHEET	SURVEY COMPLETED: MARCH 27, 2012
PERSONNEL:		EQUIPMENT:
DARREN SMITH, P.L.S. DIVISION MANAGER 4		TOPCON GR3 GPS
ADAM HINDS, P.L.S. SURVEY MANAGER 1		TOPCON HIPER II GPS
JOE FARMER, L.S.I. TECHNICIAN MANAGER 2		TOPCON IS 3" IMAGING ROBOTIC TOTAL STATION
TANNER WENTWORTH, L.S.I. SURVEY INTERN 1		TOPCON FC-2500 DATA COLLECTORS
BRIAN BIRD, L.S.I. SURVEY INTERN 1		GPT-9005A 5" ROBOTIC TOTAL STATION
CORY CULPEPPER, TECHNICIAN 1		TOPCON GPT 3000W TOTAL STATION
SAM MCGEE, TECHNICIAN 1		TOPCON GPT 3005W TOTAL STATION
CHRIS WILLIAMS, TECHNICIAN 1		TOPCON GTS 3000 TOTAL STATION
ERIC MENTZER, TECHNICIAN 3		TOPCON GTS 313 TOTAL STATION
REBECCA ROBICHAUX, TECHNICIAN 1		TRIMBLE 5700 GPS
MICHAEL COOK, TECHNICIAN 1		TRIMBLE 5800 GPS
ERIC OLDHAM, TECHNICIAN 1		SOKKIA SDL 30 DIGITAL LEVEL
COLTON SCHRODER, TECHNICIAN 1		EAGLE POINT AND INROADS WORKING IN AUTOCAD PLATFORM
ABDUL ABDULRAHMAN, TECHNICIAN 1		

UTILITY OWNERS CONTACT INFORMATION		
OWNER	ADDRESS	PHONE
AT&T	1425 Oak St. Kansas City, MO 64106	816-275-4014
City of Mounds	1319 Commercial Ave. Mounds, OK 74047	918-827-6711
Enogex	211 N. Robinson, Suite 950 OKC, OK. 73102	405-530-7419
OG&E	3220 S. High St. OKC, OK. 73129	405-553-5997
Oklahoma Natural Gas	5848 E. 15th St. Tulsa, OK. 74112	918-831-8259
Rural Water District #7	1117 Commercial ave, Mounds, OK. 74047	918-827-6575
TDS Telecom	525 Junction Rd. Madison, WI. 53717	608-685-3211

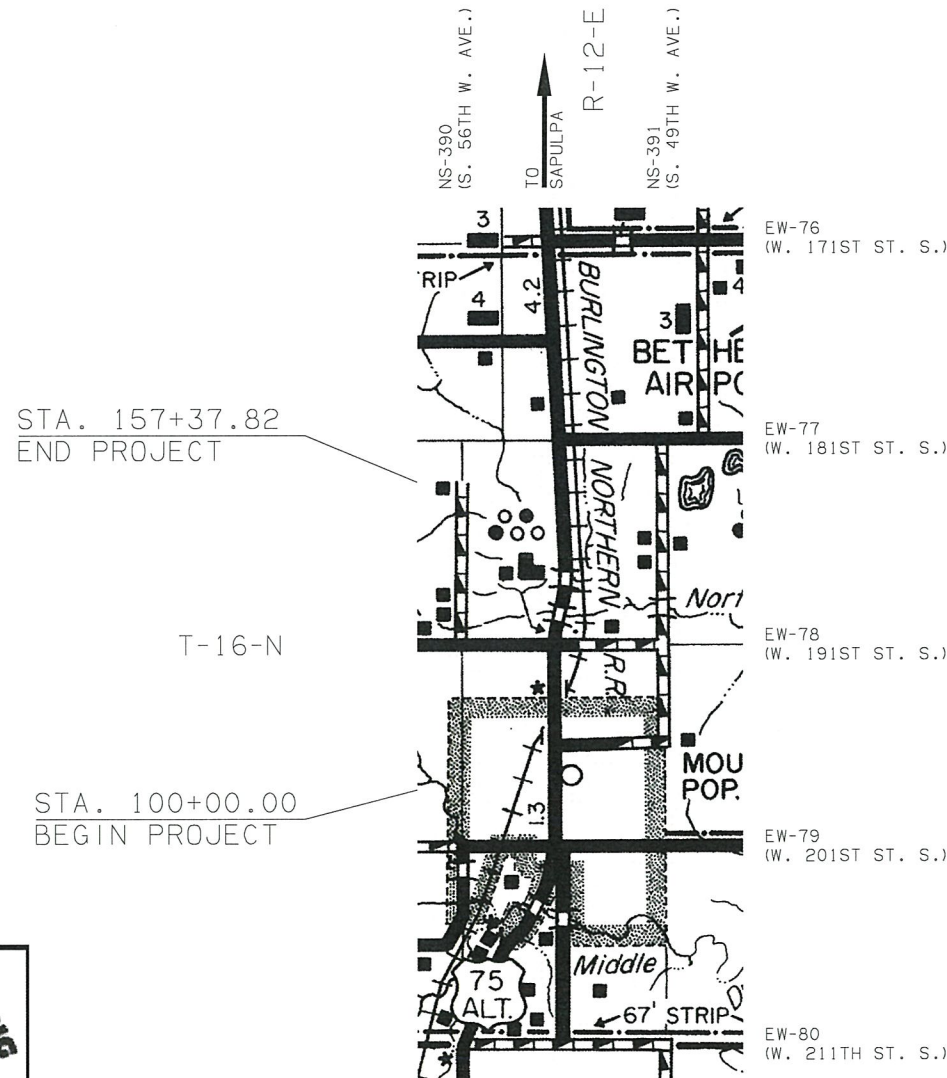

PROJECT LENGTH: 5738 FT. 1.09 MILES
 EQUATIONS: BOP STA. 100+00.00
 EOP STA. 157+37.82
 EXCEPTIONS: NONE

STATE OF OKLAHOMA
DEPARTMENT OF TRANSPORTATION

SWO 4732(1) PROJECT 27075(04) E.C. CONTRACT NO. 1385

LAND SURVEYORS CERTIFICATION

I hereby certify that all land and property subdivision distances, angles, corners and monumentation made or used in conjunction with this survey and depicted or recorded herein were recovered, established or re-established in substantial conformity with:

- applicable instructions contained in the U.S. Government Bureau of Land Management publication "Manual of Surveying Instructions"; its supplement, "Restoration of Lost or Obliterated Corners and Subdivision of Sections";
- "Oklahoma Minimum Standards for the Practice of Land Surveying" as adopted by the State Board of Registration for Professional Engineers and Land Surveyors, and
- sound land surveying practices;

including a thorough search, study, analysis and consideration of all existing records and field evidence.

I further certify that all survey monuments depicted exist and that all land survey work was done by me or under my direct supervision and that it is true, accurate and correct to the best of my knowledge and belief.

Dated this 11th day of JUNE, 2012

Land Surveyor Darren M. Smith
 Signature

Darren M. Smith
 Printed Name

Oklahoma Registered Land Surveyor No. 1552
 Certificate of Authorization No. 32 Exp. Date June 30, 2012

DATE APPROVED _____
 BY _____
 CHIEF OF SURVEYS

PREPARED BY:
 DARREN M. SMITH, PLS
 COBB ENGINEERING COMPANY

PREPARED FOR:
 OKLAHOMA DEPARTMENT OF TRANSPORTATION
 SURVEY DIVISION

SHEET NO. SI

J/P NO. 27075(04) CREEK COUNTY US-75A

Electronic File Transfer Disclaimer:
 These Files, Drawings and/or Notes are provided for information only. Cobb Engineering Company and the Owner cannot be held responsible for the content or accuracy of these Files, Drawings and/or Notes due to conversions, software translations, or any other manipulation of said Files, Drawings and/or Notes. Cobb Engineering Company expressly disclaims any responsibility arising from any use of these Files, Drawings and/or Notes. To the full extent permitted by applicable law, the recipient of these Files, Drawings and/or Notes hereby agrees to defend, indemnify, and hold harmless Cobb Engineering Company and the Owner from and against any and all claims, suits, actions, damages, loss, liability or costs of every nature or description (including reasonable attorney's fees) arising from, or in any way attributable to or connected with any of these Files, Drawings and/or Notes.

THIS SURVEY MEETS THE OKLAHOMA MINIMUM STANDARDS FOR THE PRACTICE OF LAND SURVEYING AS ADOPTED BY THE OKLAHOMA STATE BOARD OF REGISTRATION FOR PROFESSIONAL ENGINEERS AND LAND SURVEYORS, MAY 11, 2007.