

OKLAHOMA DEPARTMENT OF TRANSPORTATION					
FED. ROAD DIST. NO.	STATE	JOB PRICE NO.	FISCAL YEAR	SHEET NO.	TOTAL SHEETS
6	OKLA.				
DESCRIPTION		REVISIONS		DATE	

BM* 207-"X" CUT ON NORTH WINGWALL EAST SIDE OF ROAD
STA. 139+96.26
17.68' RT. ELEV. 722.56

STR. NO. T14
DETOUR 2 STA. 140+14.00
CONST. TEMP. 2 X 60° X 76' LG.
CGSP 36.70' LT. & 39.30' RT.

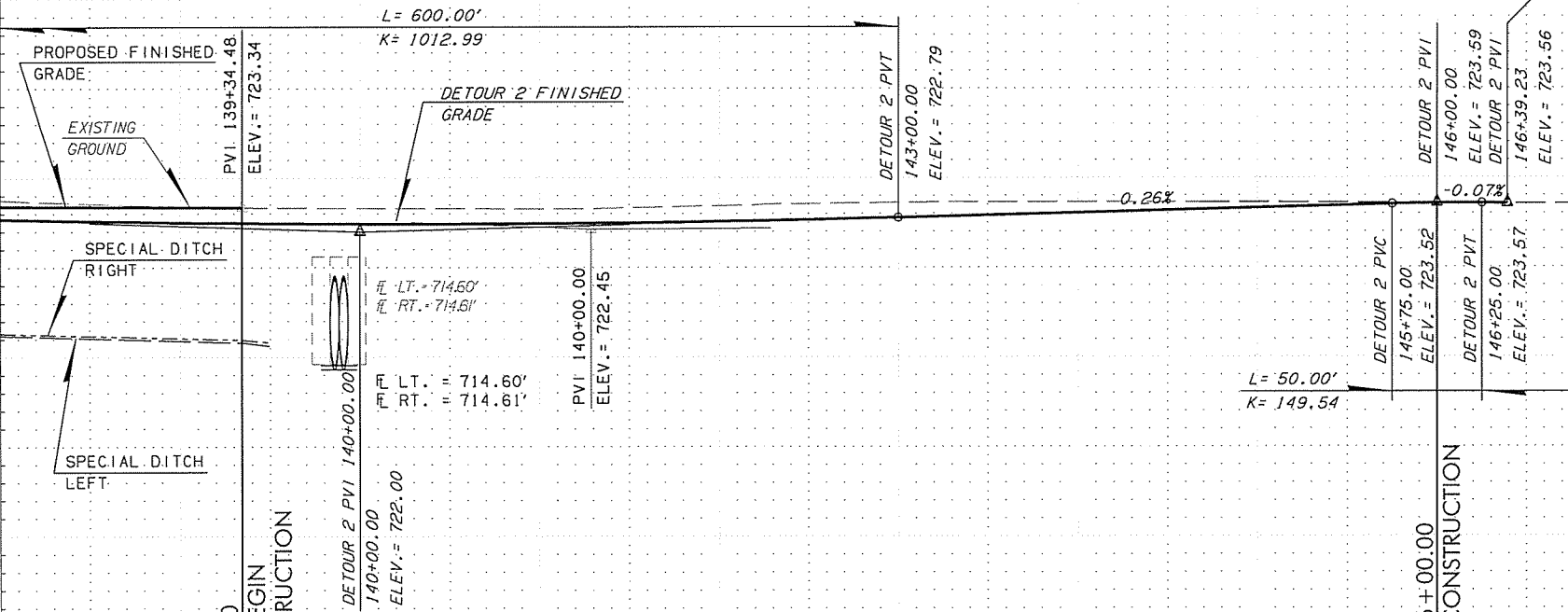

CRL STA. 139+25.00
END PROJECT & BEGIN
INCIDENTAL CONSTRUCTION

Q SURVEY STA. 146+00.00
END INCIDENTAL CONSTRUCTION

LT.	RT.	STATION BEGIN	ELEVATION	STATION END	ELEVATION	TANGENT GRADE	TANGENT LENGTH
	X	131+00.00	718.46	139+25.00	715.96	-0.30	834.48
X		132+00.00	718.00	139+25.00	715.80	-0.30	734.48
X		139+25.00	715.80	139+39.79	715.63	-1.15	14.79
	X	139+25.00	715.96	139+39.81	715.81	-1.01	14.81

05-03-16