

TRAFFIC DESIGN

PROJECT ENGINEER : JAMI SHORT
SQUAD SUPERVISOR : STEVE WILLIAMS

ROADWAY DESIGN

ENGINEERING MGR : CALEB AUSTIN, PE
SQUAD SUPERVISOR : JEFFREY HAMILTON

BRIDGE DESIGN

ENGINEERING MANAGER: MOHAMED ELYAZGI, PE
SQUAD SUPERVISOR: KEVEN MAYFIELD
ASSISTANT SQUAD SUPERVISOR: KYLE STEVENS
SQUAD MEMBERS: D. GOFORTH, J. LONSDALE, R. WEINERT, R. ADKINSON, A. GATLEY,
ENGINEER: MIKE CAD, PE
ENGINEER: KATIE BROWN, E.I.

P.E. NO. : 27075(00)

FOR SURVEY CONTROL DATA
SEE SURVEY DATA SHEETS

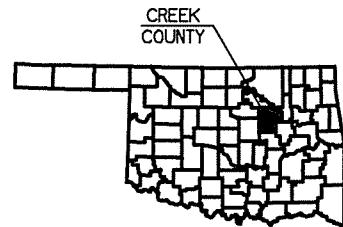

LOCATION MAP
DIVISION 8

DESIGN DATA

ADT 2016	= 3,400
ADT 2036	= 4,800
DHV (2-WAY)	= 539
K (DHV/ADT)	= 11%
D	= 57%
T (% DHV)	= 4%
T (% ADT)	= 7%
T ² (% ADT)	= 2%
V DETOUR 1	= 25MPH
V DETOUR 2	= 45MPH
V S OF BRIDGE	= 35MPH
V N OF BRIDGE	= 55MPH
20yr FLEX EQUALS	= 3.18M

SCALE

PLAN	1" = 100'
PROFILE HOR.	1" = 100'
VER.	1" = 10'
LAYOUT MAP	1" = 2,640'

CONVENTIONAL SYMBOLS

	PROPOSED ROAD
	RAILROADS
	RANGE & TOWNSHIP
	SECTION LINES
	QUARTER SECTION LINES
	FENCES
	GROUND LINE
	EXISTING ROADS
	BASE LINE
	GRADE LINES
	TELEPHONE & TELEGRAPH
	POWER LINES
	BUILDINGS
	OILWELL
	DRAINAGE STRUCTURES - IN PLACE
	DRAINAGE STRUCTURES - NEW
	RIGHT-OF-WAY LINES - EXISTING
	RIGHT-OF-WAY LINES - NEW
	CONTROLLED ACCESS
	RIGHT-OF-WAY FENCE

2009 OKLAHOMA STANDARD SPECIFICATIONS FOR HIGHWAY CONSTRUCTION GOVERN, APPROVED BY THE
U.S. DEPARTMENT OF TRANSPORTATION, FEDERAL HIGHWAY ADMINISTRATION, JANUARY 4, 2010.

STATE OF OKLAHOMA
DEPARTMENT OF TRANSPORTATION

PLAN OF PROPOSED
U.S. HIGHWAY
FEDERAL AID PROJECT NO. ACSTP-219C(033)SS
BRIDGE AND APPROACHES
US HIGHWAY 75A

CREEK COUNTY

CONTROL SECTION NO. 75A-19-08
STATE JOB NO. 27075(04)
BRIDGE 'A' LOCATION NO. 1908 0180X
EXISTING NBI NO. 06587; NEW NBI NO. 31242

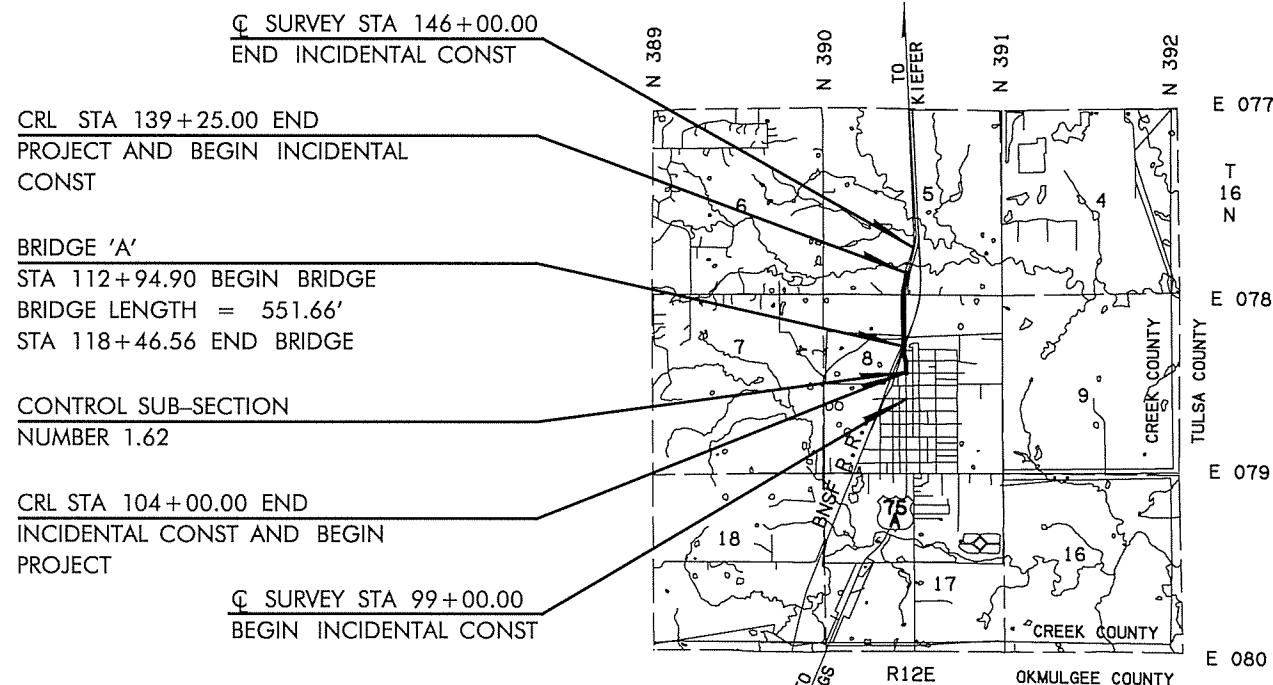

ROADWAY LENGTH ----- 2973.34 FT. 0.563 MI.
BRIDGE LENGTH ----- 551.66 FT. 0.104 MI.
PROJECT LENGTH ----- 0.667 MI.

EQUATIONS NONE
EXCEPTIONS NONE

DESCRIPTION	REVISION	DATE
PROJ. NO. CORRECTION IN TITLE BLOCK		1/19/16

INDEX OF SHEETS

1	TITLE SHEET	54-56	DETAILS OF ABUTMENTS
2-3	TYPICAL SECTIONS	57-58	DETAILS OF WINGS
4	SUMMARY OF PAY QUANTITIES (ROADWAY)	59	DETAILS OF PIERS
5	SUGGESTED SEQUENCE OF CONSTRUCTION	60	DETAILS OF BEARINGS
6-7	GENERAL NOTES (BRIDGE)	61	DETAILS OF SUPERSTRUCTURE (LONGITUDINAL SECTION)
8	RAILROAD NOTES	62	DETAILS OF SUPERSTRUCTURE (DECK LAYOUT)
9	GENERAL NOTES AND SUMMARY OF PAY QUANTITIES (BRIDGE)	63	DETAILS OF FRAMING PLAN
10	PAY QUANTITIES AND NOTES (TRAFFIC CONTROL)	64	DETAILS OF PLATE GIRDERS
11	PAY QUANTITIES AND NOTES (SIGNING AND STRIPING)	65	DETAILS OF SPLICE PLATES
12-13	ROADWAY SUMMARY	66	DETAILS OF CROSSFRAMES
14	STORM WATER MANAGEMENT PLAN	67-68	DETAILS OF END DIAPHRAGMS
15-18	EROSION CONTROL DETAIL	69	TRAFFIC RAIL LAYOUT
19-20	DRIVE DETAIL SHEETS	70-71	APPROACH SLAB DETAILS
21-24	PAVEMENT REMOVAL DETAIL SHEETS	72	DRAINS AT END OF BRIDGE
25-32	PHASE DETAIL SHEETS	73-74	5-INCH SLOPEWALL
33-36	MASS DIAGRAM SHEETS	75	GENERAL PLAN AND ELEVATION (MSE SOUTH WALL)
37-44	PLAN AND PROFILE SHEETS	76	GENERAL PLAN AND ELEVATION (MSE NORTH WALL)
45-46	GENERAL PLAN AND ELEVATION	77	ADVANCED WARNING-TRAFFIC CONTROL
47-50	FOUNDATION REPORT	78	PHASE 2A DETAIL-TRAFFIC CONTROL
51-52	SUBSTRUCTURE STAKING DIAGRAM	79-80	PHASE 2B DETAIL-TRAFFIC CONTROL
53	SUBSTRUCTURE EXCAVATION AND PIPE UNDERDRAIN	81-82	PHASE 3 DETAIL-TRAFFIC CONTROL
		83-84	PHASE 3F & 4C DETAIL-TRAFFIC CONTROL
		85	MSE WALL DETAILS
		S1-S7	SURVEY DATA SHEETS
		X1-X46	CROSS SECTIONS

THE FOLLOWING STANDARD DRAWINGS WILL BE REQUIRED:

RAILROAD	ROADWAY	BRIDGE	TRAFFIC	
BNSF/UPRR PLAN 711100	ASCD-5-2 C1-1-2 CSCD-5-3 FHTCP-3-1 FHTMPP-1-0 PCES-4-1 PED-3-2 RD1-3-1 RWF2-2-1 SPB-1-4	SPI-4-1 SSS-1-1 SUEL1-3-2 SUEL4-3-2 TFL-1-1 TSC2-3-2 TSD-2-0 TWD-1-0 OBSOLETE ROADWAY SUEL2-3-0	B40-C-ABUT-MISC-01E B40-C-AS-03E B40-STL-BM-BRACING-00E CRCP2-3-0 EJ-SK-03E EJ-DTL-01E GHW1-1-00 GHW2-1-00 HP1-2-00E LECS-4-1 PUD-3-2 SKT-1-00 THRI-1-02 TR4-2-00E	TCS1-1-01 TCS2-1-00 TCS3-1-01 TCS4-1-01 TCS5-1-00 TCS6-1-02 TCS7-1-02 TCS8-1-00 TCS9-1-01 TCS10-1-00 TCS11-1-01 TCS14-1-00 TCS15-1-00 TCS16-1-00 TCS19-1-01 TCS20-1-00 TCS21-1-02 PM1-1-02 PM3-1-02 PM4-1-01

PREPARED BY:
OKLAHOMA DEPARTMENT OF TRANSPORTATION
BRIDGE DIVISION
Mohamed Elyazgi
MOHAMED F. ELYAZGI, P.E.
OKLA. REG. NO. 17542
DATE: 8/19/2016

OKLAHOMA DEPARTMENT OF TRANSPORTATION	DEPARTMENT OF TRANSPORTATION FEDERAL HIGHWAY ADMINISTRATION
DATE APPROVED	DATE APPROVED
BY	BY
CHIEF ENGINEER	DIVISION ADMINISTRATOR
SWQ 4170(1)	PROJECT NO. ACSTP-219C(033)SS A SHEET NO. 1