

PLAN - APPROACH SLAB ABUT. NO. 1
TOP MAT OF REINFORCING STEEL SHOWN

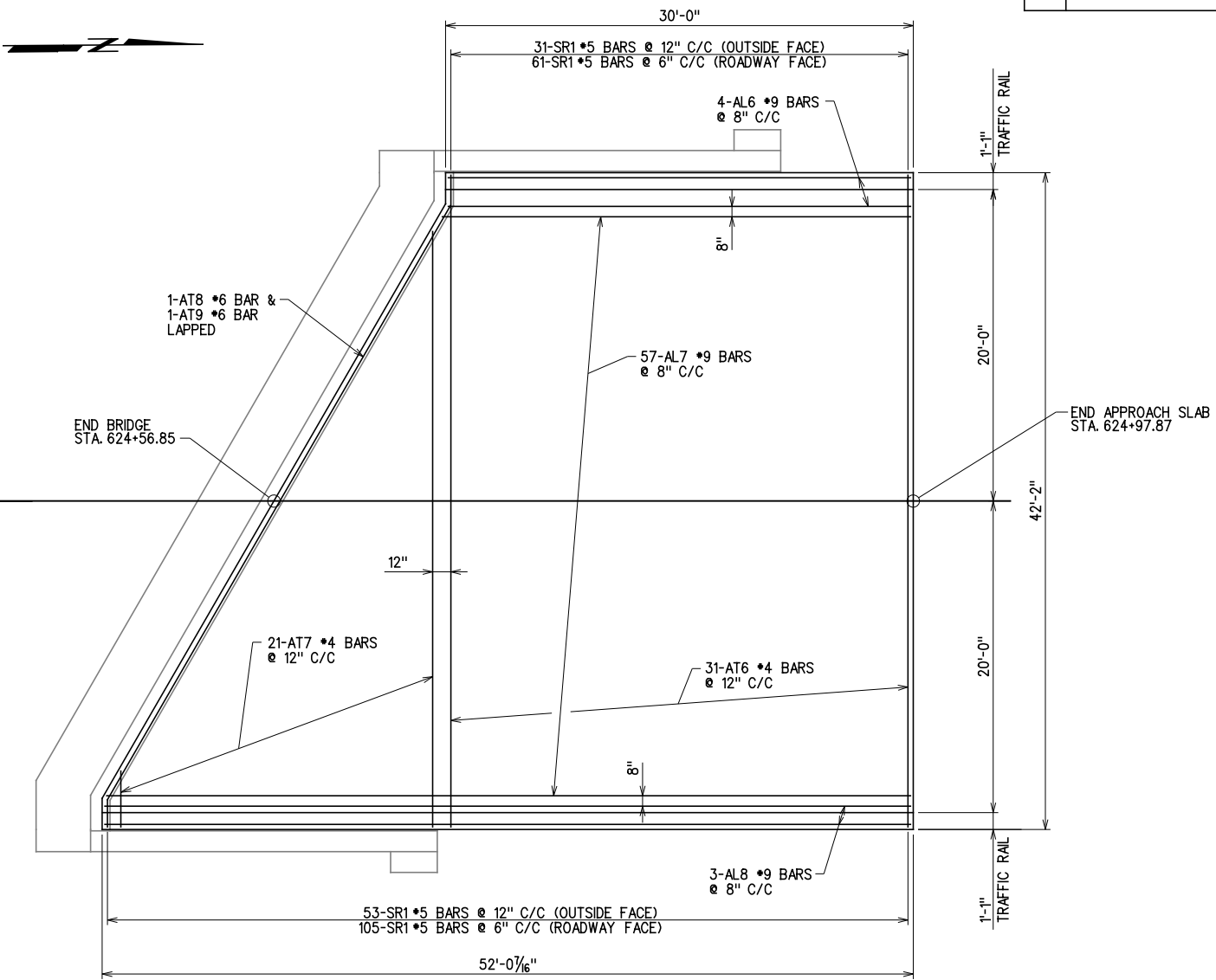

PLAN - APPROACH SLAB ABUT. NO. 2
BOTTOM MAT OF REINFORCING STEEL SHOWN

NOTE:
DO NOT SAW-CUT GROOVE WITHIN 6" OF THE LONGITUDINAL JOINT, THE TRANSVERSE JOINT AND THE CONSTRUCTION JOINT BETWEEN THE APPROACH SLAB AND THE DECK SLAB.

APPROACH SLAB BAR LIST					
ONE SHOWN, TWO REQUIRED					
MARK	NO.	SIZE	FORM	LENGTH	LENGTH VARIATION
EPOXY COATED REINFORCING					
AL1	44	#4	STR.	24'-8"	
AL2	3	#4	STR.	26'-8"	
AL3	19	#4	STR.	20'-10 1/2" (AVG.)	15'-9" TO 26'-0"
AL4	19	#4	STR.	10'-4 1/2" (AVG.)	5'-3" TO 15'-6"
AL5	3	#4	STR.	4'-8"	
AL6	4	#9	STR.	29'-8"	
AL7	57	#9	STR.	40'-10" (AVG.)	30'-1" TO 51'-7"
AL8	3	#9	STR.	51'-8"	
AT1	75	#4	STR.	20'-9"	
AT2	10	#4	STR.	1'-4 1/2" (AVG.)	3'-7" TO 19'-2"
AT3	10	#4	STR.	9'-3 1/2" (AVG.)	1'-6" TO 17'-1"
AT4	1	#6	BNT.	23'-7"	
AT5	1	#6	BNT.	23'-7"	
AT6	31	#4	STR.	4'-10"	
AT7	21	#4	STR.	20'-10 1/2" (AVG.)	3'-7" TO 38'-2"
AT8	1	#6	BNT.	25'-4"	
AT9	1	#6	BNT.	25'-5"	
SR1	250	#5	BNT.	4'-1"	PARAPET REINFORCING

APPROACH SLAB QUANTITIES				
ITEM	UNIT	APPR. 1	APPR. 2	TOTAL
① APPROACH SLAB	S.Y.	192.2	192.2	384.4
SAW-CUT GROOVING	S.Y.	182.3	182.3	364.6
CONCRETE RAIL (TR4)	L.F.	82.0	82.0	164.0
WATER REPELLENT (VISUALLY INSPECTED)	S.Y.	38.0	38.0	76.0

① THE CONTRACT UNIT PRICE FOR APPROACH SLAB SHALL BE FULL COMPENSATION FOR CONCRETE, REINFORCING STEEL (INCLUDING SR1 BARS), BACKER ROD, RAPID CURE JOINT SEALANT, POLYSTYRENE, EXCAVATION, LABOR, EQUIPMENT AND OTHER INCIDENTALS NECESSARY TO COMPLETE THE WORK AS SPECIFIED ON THE PLANS.

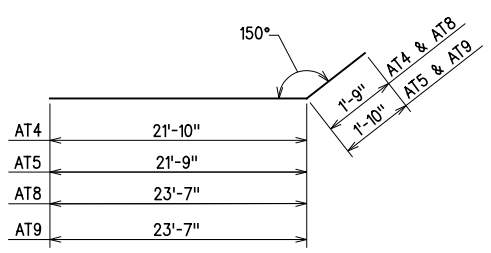

AT4-#6 BAR X 23'-7"
 AT5-#6 BAR X 23'-7"
 AT8-#6 BAR X 25'-4"
 AT9-#6 BAR X 25'-5"

NOTE:
FOR TRAFFIC RAIL REINFORCING BAR BENDS, SEE STD. TR4-2

BAR BENDING DIAGRAMS
(ALL DIMENSIONS ARE OUT TO OUT)

GROSSMAN & KEITH
 ENGINEERING COMPANY
 10408 GREENBRIAR PL., OKLA. CITY OK. 73159
 PH. 691-3213 FAX 691-3214
 CA. #74 EXPIRES 06/30/2016

DESIGN		U.S. 277 OVER DEEP RED CREEK OVERFLOW	COTTON COUNTY
DRAWN		BRIDGE "C"	
CHECKED		APPROACH SLAB DETAILS (1 OF 2)	
APPROVED			
SQUAD	G/K ENGR.	JOB PIECE NO. 28036(04)	SHEET NO. 95

X:\guernsey\EC-1360\Struc\Bridge_C\APPR.dgn 6/2/2016