

BH1 - #9 BAR x 50'-5" (AVG.)

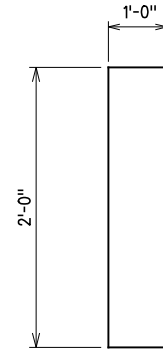

BH9 - #4 BAR x 4'-0"

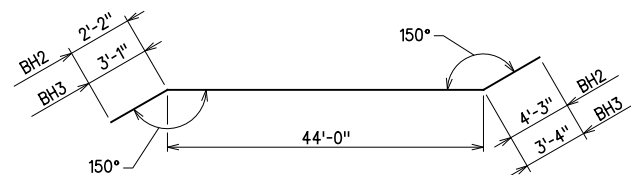

BH2 - #4 BAR x 50'-5"

BH3 - #4 BAR x 50'-5"

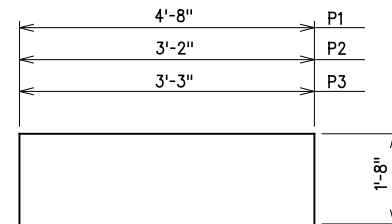

P1 - #4 BAR x 8'-0"

P2 - #4 BAR x 6'-6"

P3 - #4 BAR x 6'-7"

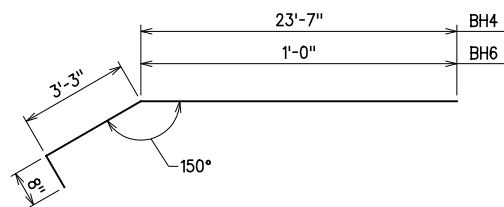

BH4 - #4 BAR x 27'-6"

BH6 - #4 BAR x 4'-11"

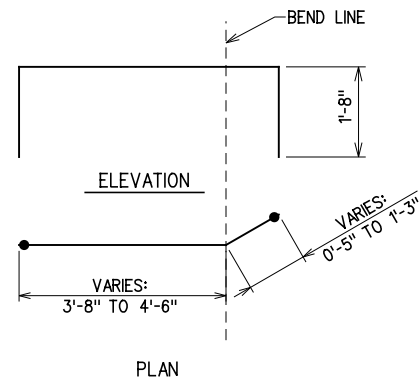

P4 - #4 BAR x 8'-3" (AVG.)

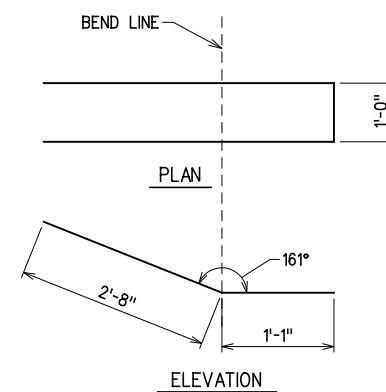

WT1 - #5 BAR x 8'-6"

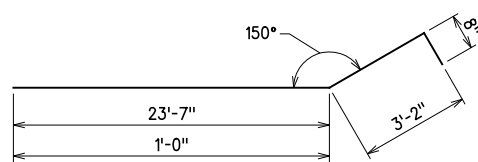

BH5 - #4 BAR x 27'-5"

BH7 - #4 BAR x 4'-10"

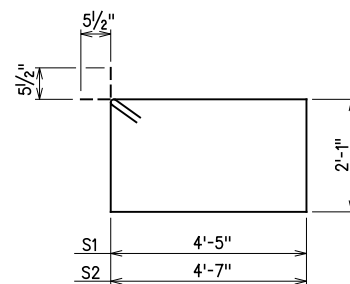

S1 - #5 BAR x 13'-11"

S2 - #5 BAR x 14'-3"

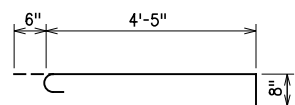

BH8 - #4 BAR x 5'-7"

BAR LIST						
ABUTMENT NO. 1						
MARK	NO.	SIZE	FORM	LENGTH	LENGTH VARIATION	
EPOXY COATED REINFORCING						
①	BH1	10	#9	BNT.	50'-5" (AVG.)	50'-5" TO 50'-5"
	BH2	1	#4	BNT.	50'-5"	
	BH3	8	#4	BNT.	50'-5"	
	BH4	9	#4	BNT.	27'-6"	
	BH5	9	#4	BNT.	27'-5"	
	BH6	6	#4	BNT.	4'-11"	
	BH7	6	#4	BNT.	4'-10"	
	BH8	27	#4	BNT.	5'-7"	
	BH9	10	#4	BNT.	4'-0"	
②	BV1	50	#5	STR.	8'-3" (AVG.)	8'-0" TO 8'-6"
②	BV2	50	#5	STR.	8'-4 1/2" (AVG.)	8'-3" TO 8'-6"
	BV3	4	#5	STR.	9'-1"	
	BV4	4	#5	STR.	9'-4"	
	P1	12	#4	BNT.	8'-0"	
	P2	24	#4	BNT.	6'-6"	
	P3	1	#4	BNT.	6'-7"	
	P4	4	#4	BNT.	8'-3" (AVG.)	7'-5" TO 9'-1"
	S1	60	#5	BNT.	13'-11"	
	S2	2	#5	BNT.	14'-3"	
③	WT1	2	#5	BNT.	8'-6"	
	WT2	6	#5	BNT.	9'-0" (AVG.)	6'-0" TO 12'-0"
	WT3	10	#5	BNT.	18'-0"	
	WT4	22	#5	BNT.	11'-0"	

- ① 2 SETS OF 5 BARS
- ② 2 SETS OF 25 BARS
- ③ 2 SETS OF 3 BARS

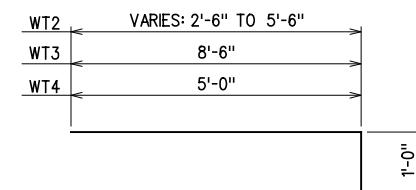

WT2 - #5 BAR x 9'-0" (AVG.)

WT3 - #5 BAR x 18'-0"

WT4 - #5 BAR x 11'-0"



**GROSSMAN & KEITH**  
ENGINEERING COMPANY  
10408 GREENBRIAR PL., OKLA. CITY, OK. 73159  
PH. 691-3213 FAX 691-3214  
CA. #74 EXPIRES 06/30/2016

ABUTMENT NO. 1

DESIGN	
DRAWN	
CHECKED	
APPROVED	
SQUAD	G/K ENGR.

U.S. 277 OVER DEEP RED CREEK OVERFLOW COTTON COUNTY

BRIDGE "C" ABUTMENT DETAILS (3 OF 8)

JOB PIECE NO. 28036(04) SHEET NO. 75