

DESCRIPTION	REVISIONS	DATE

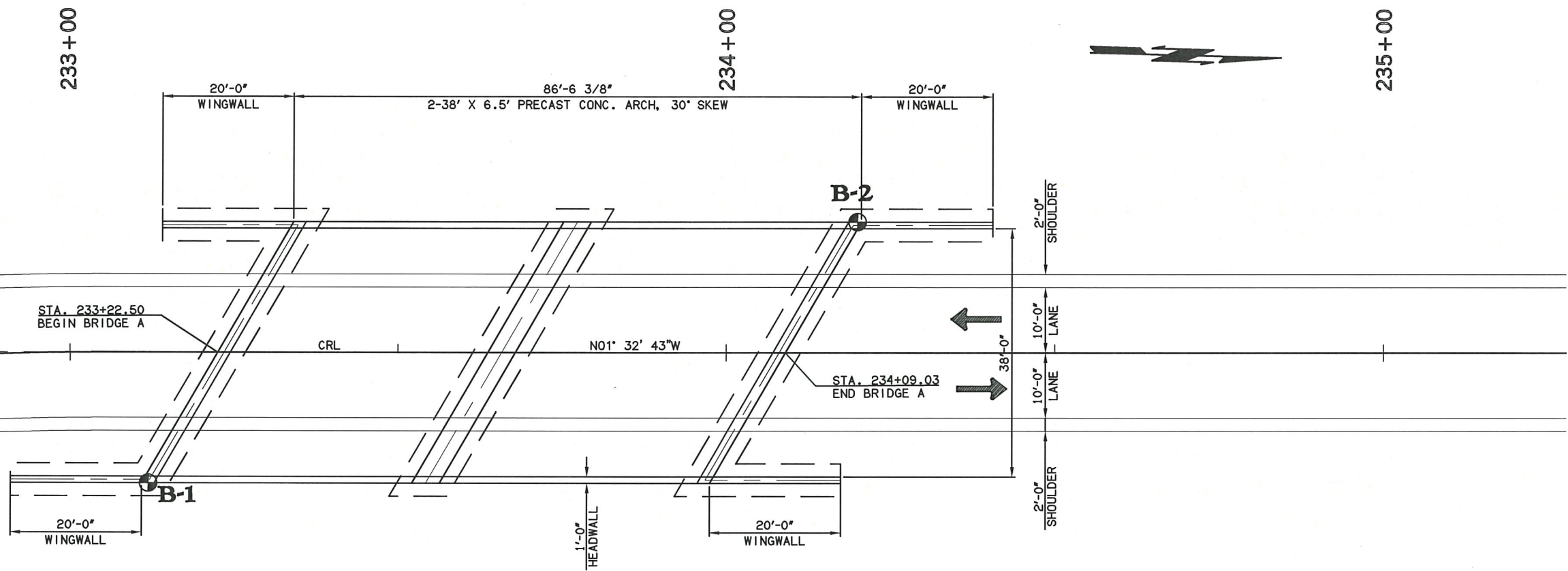

WINGWALL PLAN
Not To Scale

GENERAL NOTES:

1. ALL CONSTRUCTION AND MATERIALS SHALL BE IN ACCORDANCE WITH THE 2009 OKLAHOMA STANDARD SPECIFICATIONS FOR HIGHWAY CONSTRUCTION.
2. HEADWALL SHALL HAVE A MINIMUM ELEVATION OF 659.50 TO ACCOMMODATE ROADWAY FILL SLOPES.
3. ELEVATION AT TOP OF WINGWALL SHALL MATCH ELEVATION OF THE TOP OF HEADWALLS.
4. WINGWALLS CAN BE CAST-IN-PLACE, PRECAST, OR RECON MODULAR BLOCK RETAINING WALLS, OR APPROVED EQUAL.

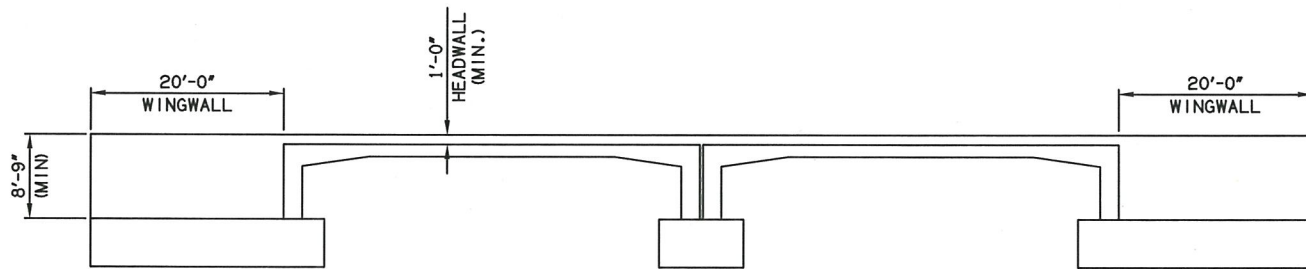

EAST VIEW FOOTING
Not To Scale

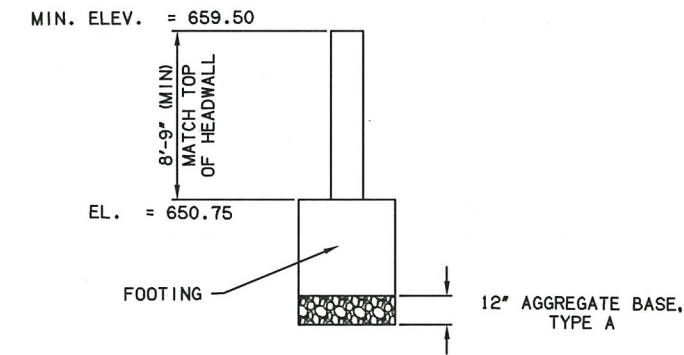

WINGWALL SECTION
Not To Scale

DESIGN	RAA	12/15	OKLAHOMA DEPARTMENT OF TRANSPORTATION GUY ENGINEERING SERVICES, INC. WINGWALL DIMENSIONS - BRIDGE 'A' STATE JOB NO. 29394(104) SHEET NO. 27 CHEROKEE COUNTY BARRINGTON HOLLOW BR 22 & LWC
DRAWN	ALM	12/15	
CHECKED	RAP	12/15	
APPROVED	RAA	12/15	
SQUAD			