

DESCRIPTION	REVISIONS	DATE

UTILITY COMPANY CONTACTS		
COMPANY	CONTACT	PHONE NO.
AT&T	GLENN LEACH	(918) 351-5023
Cherokee Co. RWD #11	JOSHUA HUBBARD	(918) 207-2797
Lake Region Electric & Water Coop.	JAMES COOK DUANE ROGERS	(918) 772-2526

ALL UTILITY LOCATIONS SHOWN ON PLANS AND PROFILES ARE APPROXIMATE. CONTRACTOR MUST CONTACT EACH UTILITY COMPANY PRIOR TO CONSTRUCTION TO VERIFY LOCATION.

STA. 100+09.75
BEGIN PROJECT
STATE JOB NO. 29394(04)

MEET & MATCH EX. ROADWAY
WIDTH AND GRADE, &
GRADE DITCHES TO DRAIN.

**WARNING
OVERHEAD
UTILITY**

STA 106+63 CONST.
12' PVT. DRIVE

STA 106+03 CONST.
12' PVT. DRIVE

STA 108+14 CONST.
12' PVT. DRIVE

PAVEMENT TYPICAL SECTION SHALL
FOLLOW EXISTING CENTERLINE OF
ROAD, NOT SECTION LINE.

SEC. 33, T18N, R20E

SEC. 34, T18N, R20E

SEC. 33 T18N, R20E

SEC. 34, T18N, R20E

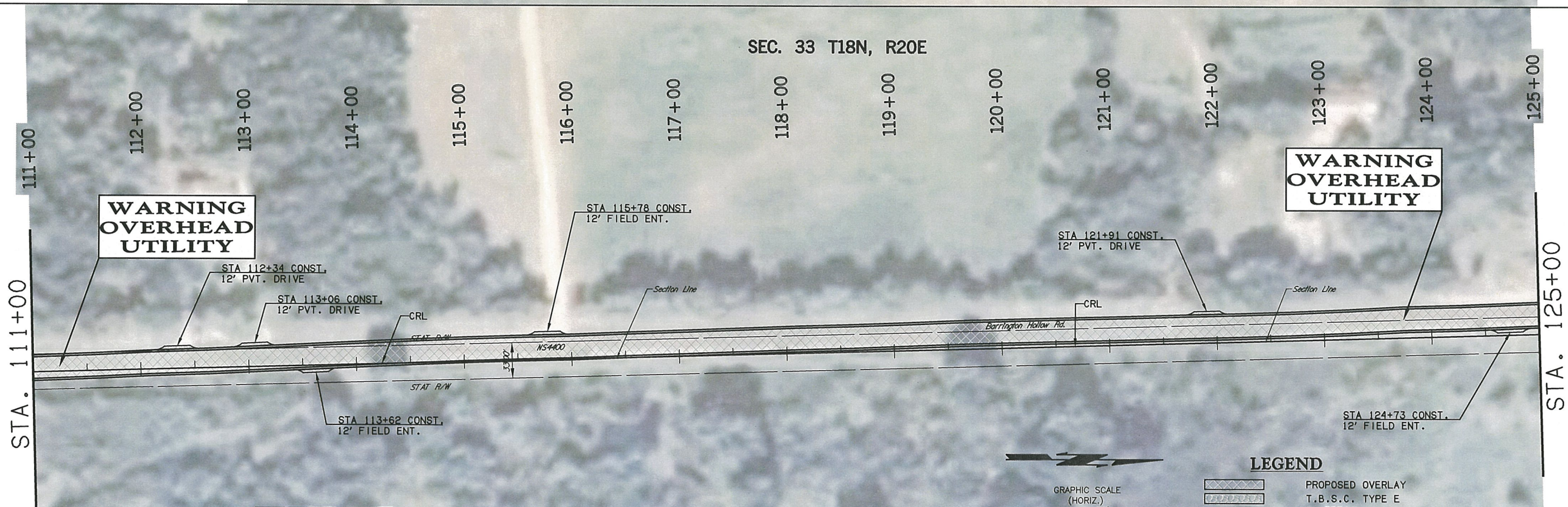

STA. 111+00

STA. 111+00

STA. 125+00

**WARNING
OVERHEAD
UTILITY**

**WARNING
OVERHEAD
UTILITY**

NOTE:
ALL UTILITY LOCATIONS
ARE APPROXIMATE.

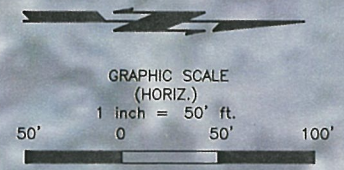

LEGEND

	PROPOSED OVERLAY
	T.B.S.C. TYPE E
	GUARDRAIL
	RIP RAP
	BENCHMARK

Wednesday, December 02, 2015 2:36:04 PM
V:\13-828E Barrington Hollow Br 22 & LWC-Cherokee 2-CED2\CV3D\PLANS\828-PLAN SHEETS.dwg