

2009

**Annual Average Daily Traffic
Oklahoma Highway System
Cimarron County (East)**

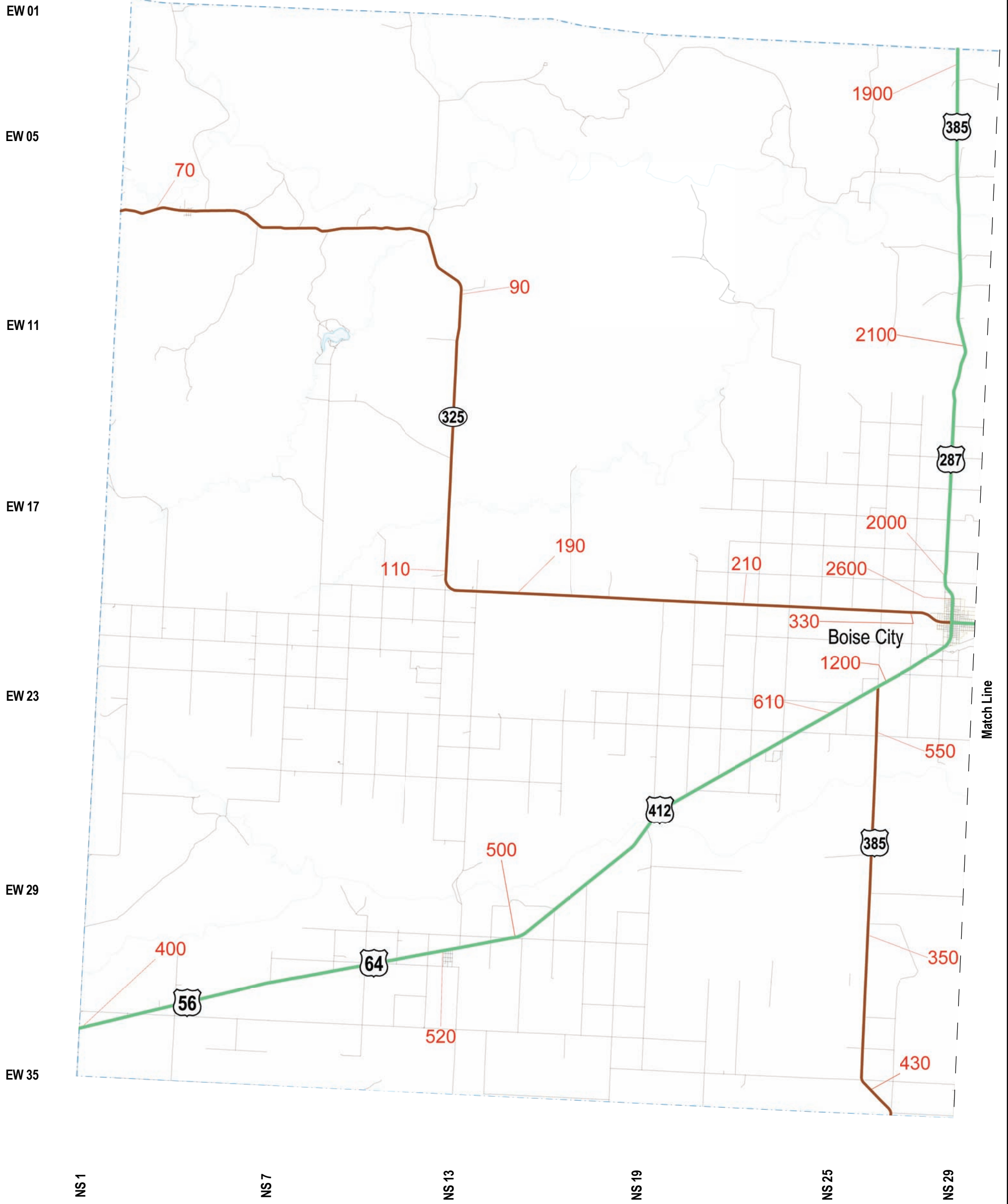



LEGEND

STATE HIGHWAY SYSTEM

WIM
 AVC

AVC- AUTOMATIC VEHICLE CLASSIFICATION SITE:
 RECORDS TRAFFIC VOLUME AND VEHICLE CLASSIFICATION EACH DAY

WIM- WEIGH-IN-MOTION SITE:
 RECORDS VEHICLE VOLUME, VEHICLE CLASSIFICATION AND APPROXIMATE AXLE WEIGHTS EACH DAY

1234 (VPD)

2009

**Annual Average Daily Traffic
Oklahoma Highway System
Cimarron County (West)**

